

\$7.00  
\$2.00  
SEP 13 1995  
COMMISSION

KENT COUNTY REMONUMENTATION

LAND CORNER RECORDATION CERTIFICATE  
Filing Requirement of Act 74, Mich. P.A. 1970

For corners in  
KENT COUNTY

(County)	Located In:	Corner Code #
1. Public Land Survey	T <u>8N</u> R <u>12W</u>	<u>G-12</u>
	T _____ R _____	_____
	T _____ R _____	_____
	T _____ R _____	_____
2. Property Controlling in Section	S _____ T _____ R _____	_____
	S _____ T _____ R _____	_____
3. Miscellaneous Property in Sec.	S _____ T _____ R _____	_____
	S _____ T _____ R _____	_____
4. Lot No. _____, Recorded Plat _____		
5. Private Claims _____		

STATE OF MICHIGAN  
COUNTY OF KENT  
RECEIVED FOR RECORD  
95 JUN 29 AM 11:54  
REG. OF DEEDS  
8472  
Register of Deeds Stamp & File Number

I, Kirk Breitels, in a field survey on Feb. 13, 19 95, do hereby certify that under requirements of P.A. 74, Michigan P.A. of 1970, the corner points mentioned in lines 1 and 2 above were in conformance with regulations and rules therefore as required in the current manual of survey instructions of the United States Department of the Interior, Bureau of Land Management or by a decree of a Court of Law and/or that the corner points mentioned in lines 3, 4 and 5 above were in conformance with the rules of the Michigan Board of Land Surveyors or by a Decree of a Court of Law; established, re-established, monumented, re-monumented, recovered, found as expressed below:

A	B	C	D	E	F	G	H	I	J	K	L	M
2	6	5	4	3	2	1						
3												
4	7	8	9	10	11	12						
5												
6	18	17	16	15	14	13						
7												
8	19	20	21	22	23	24						
9												
10	30	29	28	27	26	25						
11												
12	31	32	33	34	35	36						
13												

NOTE: Not more than 4 corners, all in the same town and range, may be recorded on this certificate.

A. Description of original monument and accessories and/or subsequent restoration:

G-12	1838	GLO	Whitcomb	Set Post
		Kent Co. Wit.		Stone & Iron
	1972	LCRC #226	Spicer	"T" Iron
	1981	LCRC #2612	Nederveld	Set Kent County Monument

The position of this corner was previously approved by the Kent County Remonumentation Peer Group, monumented by Gordon D. Nederveld on 9/15/81 and was recorded per LCRC #2612

B. Description of corner evidence found and/or method applied in restoring or reestablishing corner:

G-12 Found standard Kent Co. Mon. (Harrison) per witnesses from above LCRC as set by Gordon D. Nederveld in place of the 1" Round Iron he found over a stone. Said Iron & Stone check with Kent Co. Wit. and LCRC #226.

<u>LCRC #2612</u>	Nail & KC Remon. tag N. side 7" Tri. Thornapple	N80°W	49.30'	P.A. 345 1990 KENT COUNTY
	Nail & KC Remon. tag SW side 12" Apple	N40°W	84.95'	PEER APPROVED 6/22/95
	Nail & KC Remon. tag W. side CP Pole	N25°E	132.80'	CHAIRMAN <i>Harry</i>
	Centerline of yard light	S25°E	67.12'	

The selected location is accepted by me and is generally accepted by professional surveyors as the best available evidence of the position of the original corner.

C. Description of monument for corner and accessories established to perpetuate locating the position of the corner:

G-12 Standard Kent County Monument				
New Nail & KC Remon. tag SW side 16" Apple	N40°W	84.98'		
Nail & KC Remon. tag W. side CP Pole	N25°E	132.82'		
Set Nail & KC Remon. tag N. side 30" Oak	N80°W	57.58'		
Set Nail & KC Remon. tag SE side 8" Maple	S55°W	47.06'		
Centerline of yard light	S25°E	67.05'		

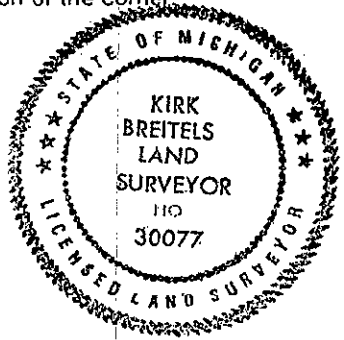

Signed by Kirk Breitels Date 6/22/95  
Surveyor's Michigan License No. 30077