

\$7.00
\$2.00

SEP 1 1995

KENT COUNTY REMONUMENTATION

LAND CORNER RECORDATION CERTIFICATE
Filing Requirement of Act 74, Mich. P.A. 1970

For corners in
KENT COUNTY

(County)

Located In:

Corner Code #

| | | | | | |
|------------------------------------|---|----|---|-----|-----|
| 1. Public Land Survey | T | 8N | R | 12W | H-9 |
| | T | | R | | |
| | T | | R | | |
| | T | | R | | |
| 2. Property Controlling in Section | S | | T | R | |
| | S | | T | R | |
| 3. Miscellaneous Property in Sec. | S | | T | R | |
| | S | | T | R | |

REG. OF DEEDS

8477

95 JUN 29 AM 11:55

STATE OF MICHIGAN
COUNTY OF KENT
RECEIVED FOR RECORD

Register of Deeds Stamp & File Number

- 4. Lot No. _____, Recorded Plat _____
- 5. Private Claims _____

| A | B | C | D | E | F | G | H | I | J | K | L | M |
|----|----|----|----|----|----|----|---|---|---|---|---|---|
| 2 | 6 | 5 | 4 | 3 | 2 | 1 | | | | | | |
| 3 | | | | | | | | | | | | |
| 4 | 7 | 8 | 9 | 10 | 11 | 12 | | | | | | |
| 5 | | | | | | | | | | | | |
| 6 | 18 | 17 | 16 | 15 | 14 | 13 | | | | | | |
| 7 | | | | | | | | | | | | |
| 8 | 19 | 20 | 21 | 22 | 23 | 24 | | | | | | |
| 9 | | | | | | | | | | | | |
| 10 | 30 | 29 | 28 | 27 | 26 | 25 | | | | | | |
| 11 | | | | | | | | | | | | |
| 12 | 31 | 32 | 33 | 34 | 35 | 36 | | | | | | |
| 13 | | | | | | | | | | | | |

I, Kirk Breitels, in a field survey on April 24, 19 95

do hereby certify that under requirements of P.A. 74, Michigan P.A. of 1970, the corner points mentioned in lines 1 and 2 above were in conformance with regulations and rules therefore as required in the current manual of survey instructions of the United States Department of the Interior, Bureau of Land Management or by a decree of a Court of Law and/or that the corner points mentioned in lines 3, 4 and 5 above were in conformance with the rules of the Michigan Board of Land Surveyors or by a Decree of a Court of Law; established, re-established, monumented, re-monumented, recovered, found as expressed below:

NOTE: Not more than 4 corners, all in the same town and range, may be recorded on this certificate.

A. Description of original monument and accessories and/or subsequent restoration:

| | | | | |
|-----|---------|------------------|----------|--------------------------|
| H-9 | 1838 | GLO | Whitcomb | Set Post |
| | 1912 | Williams & Works | | Set Stone |
| | 1913-68 | Williams & Works | | Iron 3.6' N. of stone |
| | 1945 | Kent Co. Wit. | | 1" Iron in mon. box |
| | 1978 | LCRC #1223 | Byl | "T" Iron |
| | 1985 | LCRC #4334 | Bueche | Set Kent County Monument |
| | 1990 | LCRC #5385 | Starr | Kent County Monument |

The position of this corner was previously approved by the Kent County Remonumentation Peer Group, monumented by John C. Bueche on 11/29/85 and was recorded per LCRC #4334.

B. Description of corner evidence found and/or method applied in restoring or reestablishing corner:

H-9 Found standard Kent Co. Mon. (Harrison) per witnesses from above LCRC as set by John C. Bueche in place of the PK Nail he found. Said PK Nail checks with Williams & Works information and LCRC #1223. Corner per Kent Co. Wit. is incorrect.

LCRC #4334 & #5385

| | | |
|-------------------------|-------|---------|
| NE cor. hse. foundation | S55°W | 110.46' |
| SW cor. hse. foundation | N40°E | 112.95' |
| "X" cut in conc. curb | S10°E | 60.38' |
| "X" cut in conc. curb | S55°E | 57.90' |
| "X" cut in conc. curb | N65°E | 55.21' |
| "X" cut in conc. curb | N30°W | 45.51' |

Mon. box is 3.5' E. & 1.0' N. of mon.

The selected location is accepted by me and is generally accepted by professional surveyors as the best available evidence of the position of the original corner.

P.A. 345 1990 KENT COUNTY

PEER APPROVED 6/22/95

CHAIRMAN Stan Kuberski

C. Description of monument for corner and accessories established to perpetuate locating the position of the corner:

H-9 Standard Kent County Monument

| | | |
|-------------------------|-------|---------|
| SW cor. hse. foundation | N40°E | 112.95' |
| "X" cut in conc. curb | S10°E | 60.38' |
| "X" cut in conc. curb | N65°E | 55.21' |
| "X" cut in conc. curb | N30°W | 45.51' |

Mon. box is 3.5' E. & 1.0' N. of mon.

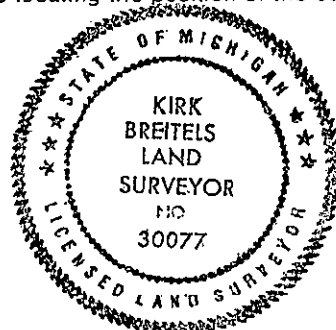

Signed by

Kirk Breitels

Date

6/22/95

Surveyor's Michigan License No. _____

30077