

SEP 18 1995

\$7.00
\$2.00

COMMISSION

KENT COUNTY REMONUMENTATION

LAND CORNER RECORDATION CERTIFICATE

Filing Requirement of Act 74, Mich. P.A. 1970

For corners in
KENT COUNTY
(County)

Located In: Corner Code #

- 1. Public Land Survey T 8N R 12W J-1
- 2. Property Controlling in Section S T R
- 3. Miscellaneous Property in Sec. S T R

STATE OF MICHIGAN
COUNTY OF KENT
RECEIVED FOR RECORD
95 JUN 29 AM 11:56
REG. OF DEEDS
Lucy Stans

8489

Register of Deeds Stamp & File Number

- 4. Lot No. , Recorded Plat
- 5. Private Claims

A	B	C	D	E	F	G	H	I	J	K	L	M
2	6	5	4	3	2							
3												
4	7	8	9	10	11	12						
5												
6	18	17	16	15	14	13						
7												
8	19	20	21	22	23	24						
9												
10	30	29	28	27	26	25						
11												
12	31	32	33	34	35	36						
13												

I, Kirk Breitels, in a field survey on Jan 25, 19 95, do hereby certify that under requirements of P.A. 74, Michigan P.A. of 1970, the corner points mentioned in lines 1 and 2 above were in conformance with regulations and rules therefore as required in the current manual of survey instructions of the United States Department of the Interior, Bureau of Land Management or by a decree of a Court of Law and/or that the corner points mentioned in lines 3, 4 and 5 above were in conformance with the rules of the Michigan Board of Land Surveyors or by a Decree of a Court of Law; established, re-established, monumented, re-monumented, recovered, found as expressed below:

NOTE: Not more than 4 corners, all in the same town and range, may be recorded on this certificate.

A. Description of original monument and accessories and/or subsequent restoration:

J-1	1838	GLO	Whitcomb	Not Set
	1944	Kent Co. Wit.		Iron & Stone
	1980	LCRC #1378	Hackbardt	Mon. Box
	1984	LCRC #4090	Kolehouse	Set Kent County Monument

The position of this corner was previously approved by the Kent County Remonumentation Peer Group, monumented by Randy J. Kolehouse on 11/16/84 and was recorded per LCRC #4090

B. Description of corner evidence found and/or method applied in restoring or reestablishing corner:

J-1 Found standard Kent Co. Mon. (Harrison) per witnesses from above LCRC as set by Randy J. Kolehouse on the township line in place of the 3/4" Iron in a mon. box he found. Said Iron in mon. box checks with Kent Co. Wit. and LCRC #1378.

LCRC #4090

Nail & KC Remon. tag NW side P. Pole	S60°W	97.95'
Chiseled "X" W. end 12" conc. culv.	S55°E	49.45'
NW cor. MBT Riser	South	54.5'
C/L 2" Maple	S70°E	84.3'
KC Mon. at S 1/4 cor. Sec. 35, T9N, R12W	West	46.46'

P.A. 345 1990 KENT COUNTY
PEER APPROVED 6/22/95
CHAIRMAN *Stans Hubert*

The selected location is accepted by me and is generally accepted by professional surveyors as the best available evidence of the position of the corner.

C. Description of monument for corner and accessories established to perpetuate locating the position of the corner:

J-1 Standard Kent County Monument		
Nail & KC Remon. tag NW side P. Pole	S60°W	97.92'
Set Nail & KC Remon. tag N. side 12" Maple	S70°E	84.15'
Set Nail & KC Remon. tag SE side 6" Elm	N50°E	48.19'
NE cor. 4' x 4' base MBT box	S00°E	55.88'
KC Mon. at S 1/4 cor. Sec. 35, T9N, R12W	S90°W	46.46'

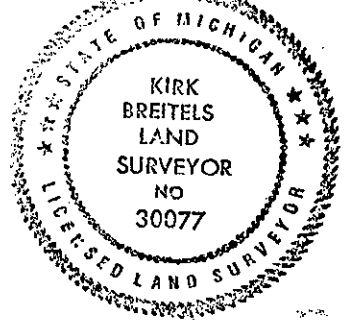

Signed by *Kirk Breitels*

Date 3/20/95

Surveyor's Michigan License No. 30077