

SEP 29 1995

COMMISSION

KENT COUNTY REMONUMENTATION

LAND CORNER RECORDATION CERTIFICATE  
Filing Requirement of Act 74, Mich. P.A. 1970

For corners in  
KENT COUNTY

(County)

Located In:

Corner Code #

1. Public Land Survey	T	8N	R	12W	J-3
	T		R		
	T		R		
	T		R		
2. Property Controlling in Section	S		T		
	S		T		
3. Miscellaneous Property in Sec.	S		T		
	S		T		

REG. OF DEEDS

8490

95 JUN 29 AM 11:56

STATE OF MICHIGAN  
COUNTY OF KENT  
RECEIVED FOR RECORD

Register of Deeds Stamp & File Number

- 4. Lot No. \_\_\_\_\_, Recorded Plat \_\_\_\_\_
- 5. Private Claims \_\_\_\_\_

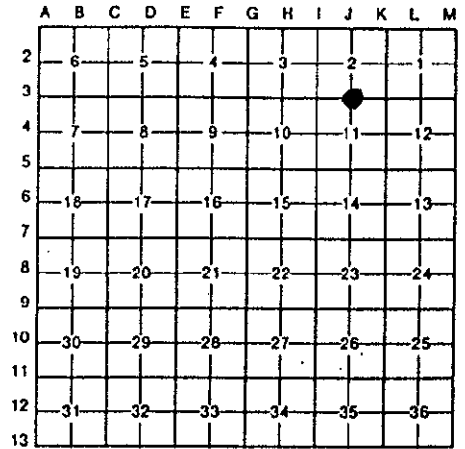

I, Kirk Breitels, in a field survey on Feb. 7, 1995, do hereby certify that under requirements of P.A. 74, Michigan P.A. of 1970, the corner points mentioned in lines 1 and 2 above were in conformance with regulations and rules therefore as required in the current manual of survey instructions of the United States Department of the Interior, Bureau of Land Management or by a decree of a Court of Law and/or that the corner points mentioned in lines 3, 4 and 5 above were in conformance with the rules of the Michigan Board of Land Surveyors or by a Decree of a Court of Law; established, re-established, monumented, re-monumented, recovered, found as expressed below:

**NOTE: Not more than 4 corners, all in the same town and range, may be recorded on this certificate.**

A. Description of original monument and accessories and/or subsequent restoration:

J-3	1838	GLO	Whitcomb	Set Post
	1934	Kent Co. Wit.		Leaded Stone
	1980	LCRC #2083	Nederveld	3/8" Spike above a "T" Iron
	1981	LCRC #2618	Nederveld	Set Kent County Monument
	1990	LCRC #5400	Starr	Kent County Monument

The position of this corner was previously approved by the Kent County Remonumentation Peer Group, monumented by Gordon D. Nederveld on 9/15/81 and was recorded per LCRC #2618

B. Description of corner evidence found and/or method applied in restoring or reestablishing corner:

J-3 Found standard Kent Co. Mon. (Harrison) per witnesses from above LCRC as set by Gordon D. Nederveld in place of the 3/8" Spike over a "T" Iron over a stone he found. All check with Kent Co. Wit. and LCRC #2083.

LCRC #5400 & #2618

Nail & KC Remon. tag W. side 28" Maple	S00°E	26.60'
Nail & KC Remon. tag N. side 18" Hickory	S45°W	44.27'
1" Round Iron	N90°E	3.25'
NW corner house	S45°E	125.86'
Nail & KC Remon. tag S. side P. Pole	N70°E	78.46'
Nail & KC Remon. tag W. side P. Pole	S30°E	51.85'

P.A. 345 1990 KENT COUNTY

PEER APPROVED 6/22/95  
CHAIRMAN Gary Huber

On C/L of E & W bit. road; On tree line N & S

The selected location is accepted by me and is generally accepted by professional surveyors as the best available evidence of the position of the original corner.

C. Description of monument for corner and accessories established to perpetuate locating the position of the corner:

J-3 Standard Kent County Monument		
Nail & KC Remon. tag W. side 33" Maple	S00°E	26.60'
New Nail & KC Remon. tag N. side 24" Hickory	S45°W	44.27'
NW corner house	S45°E	125.77'
Nail & KC Remon. tag S. side P. Pole	N70°E	78.46'
Nail & KC Remon. tag W. side P. Pole	S30°E	51.85'
Set Nail & KC Remon. tag W. side 12" Elm	N15°E	31.83'

On C/L of E & W bit. road; On tree line N & S

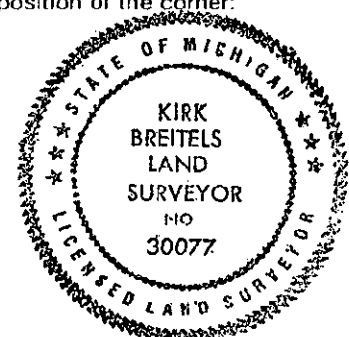

Signed by

Kirk Breitels

Date

6/22/95

Surveyor's Michigan License No.

30077