

\$7.00
\$2.00

SEP 18 1995

KENT COUNTY REMONUMENTATION

COMMISSION

LAND CORNER RECORDATION CERTIFICATE
Filing Requirement of Act 74, Mich. P.A. 1970

For corners in
KENT COUNTY
(County)

Located In:

Corner Code #

- 1. Public Land Survey T 8N R 12W K-7
- T R
- T R
- T R
- 2. Property Controlling S T R
- in Section S T R
- 3. Miscellaneous S T R
- Property in Section S T R

STATE OF MICHIGAN
COUNTY OF KENT
RECEIVED FOR RECORD

95 JUN 29 AM 11:57

REG. OF DEEDS

8500

Register of Deeds Stamp & File Number

- 4. Lot No. _____, Recorded Plat _____
- 5. Private Claims _____

A	B	C	D	E	F	G	H	I	J	K	L	M
2	6	5	4	3	2	1						
3												
4	7	8	9	10	11	12						
5												
6	18	17	16	15	14	13						
7												
8	19	20	21	22	23	24						
9												
10	30	29	28	27	26	25						
11												
12	31	32	33	34	35	36						
13												

I, Kirk Breitels, in a field survey on Feb. 6, 1995, do hereby certify that under requirements of P.A. 74, Michigan P.A. of 1970, the corner points mentioned in lines 1 and 2 above were in conformance with regulations and rules therefore as required in the current manual of survey instructions of the United States Department of the Interior, Bureau of Land Management or by a decree of a Court of Law and/or that the corner points mentioned in lines 3, 4 and 5 above were in conformance with the rules of the Michigan Board of Professional Surveyors or by a Decree of a Court of Law; established, re-established, monumented, re-monumented, recovered, found as expressed below:

NOTE: Not more than 4 corners, all in the same town and range, may be recorded on this certificate.

A. Description of original monument and accessories and/or subsequent restoration:

K-7	1838	GLO	Whitcomb	Set Post
	1962	Kent Co. Wit.		Mon. Box
	1972	LCRC #335	Spicer	1" Solid Iron in mon. box
	1972	LCRC #336	Spicer	PK Nail
	1983	LCRC #3365	Bueche	Set Kent County Monument
	1990	LCRC #5411	Starr	Kent County Monument

The position of this corner was previously approved by the Kent County Remonumentation Peer Group, monumented by John C. Bueche on 5/10/83 and was recorded per LCRC #3365.

B. Description of corner evidence found and/or method applied in restoring or reestablishing corner:

K-7 Found standard Kent Co. Mon. (Harrison) per witnesses from above LCRC as set by John C. Bueche in place of the Iron (set by Exxel Eng. in place of PK) he found. Said Iron checks with LCRC #336.

LCRC #3365 & #5411

Nail & KC Remon. tag W. side 18" Maple	N25°E	110.89'
Nail & KC Remon. tag SW side P. Pole	S60°E	97.90'
Nail & KC Remon. tag S. side Tele. Pole	N50°E	62.47'
C/L joint N. bound M-37	N90°W	36.81'
"X" cut in conc. curb	N00°E	21.96'
"X" cut in conc. curb	S30°E	20.00'

P.A. 345 1990 KENT COUNTY
PEER APPROVED 6/22/95
CHAIRMAN [Signature]

On C/L East & West bit. road (7 Mile Rd.)

Mon. Box (per Kent Co. Wit. & LCRC #335) 3.70' E. & 0.35' N.

The selected location is accepted by me and is generally accepted by professional surveyors as the best available evidence of the position of the original corner.

C. Description of monument for corner and accessories established to perpetuate locating the position of the corner:

- K-7 Standard Kent County Monument in mon. box (new mon. box after road const.)
- New Nail & KC Remon. tag W. side 24" Maple N25°E 110.93'
- Set Nail & KC Remon. tag SW side P. Pole S40°E 82.58'
- Set Nail & KC Remon. tag NW side Guy Pole N40°E 70.65'
- C/L manhole S65°E 13.46'
- C/L top of hydrant N65°E 80.39'
- C/L joint N. bound M-37 N90°W 36.81' more or less
- On C/L East & West bit. road (7 Mile Rd.)

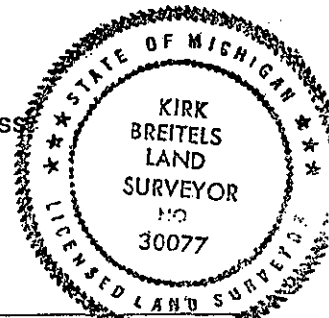

Signed by [Signature]
Surveyor's Michigan License No. 30077

Date 6/22/95