

\$7.00
\$2.00

SEP 18 1995

KENT COUNTY REMONUMENTATION

COMMISSION

LAND CORNER RECORDATION CERTIFICATE
Filing Requirement of Act 74, Mich. P.A. 1970

For corners in
KENT COUNTY
(County)

Located In:

Corner Code #

- 1. Public Land Survey T 8N R 12W K-9
- T R _____
- T R _____
- T R _____
- 2. Property Controlling S T R _____
- in Section S T R _____
- 3. Miscellaneous S T R _____
- Property in Section S T R _____

STATE OF MICHIGAN
COUNTY OF KENT
RECEIVED FOR RECORD

95 JUN 29 AM 11:57

REG. OF DEEDS

8501

Register of Deeds Stamp & File Number

- 4. Lot No. _____, Recorded Plat _____
- 5. Private Claims _____

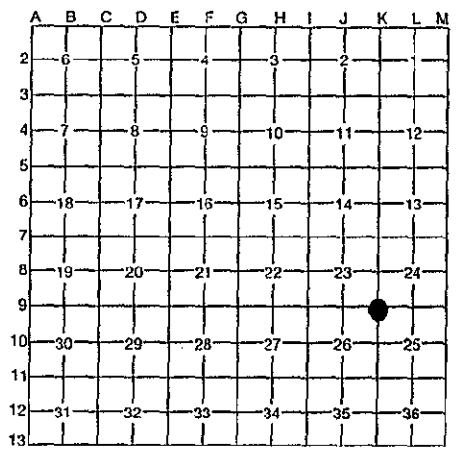

I, Kirk Breitels, in a field survey on Feb. 6, 1995

do hereby certify that under requirements of P.A. 74, Michigan P.A. of 1970, the corner points mentioned in lines 1 and 2 above were in conformance with regulations and rules therefore as required in the current manual of survey instructions of the United States Department of the Interior, Bureau of Land Management or by a decree of a Court of Law and/or that the corner points mentioned in lines 3, 4 and 5 above were in conformance with the rules of the Michigan Board of Professional Surveyors or by a Decree of a Court of Law; established, re-established, monumented, re-monumented, recovered, found as expressed below:

NOTE: Not more than 4 corners, all in the same town and range, may be recorded on this certificate.

A. Description of original monument and accessories and/or subsequent restoration:

K-9	1838	GLO	Whitcomb	Set Post
		Kent Co. Wit.		Mon. Box
	1972	LCRC #225	Spicer	PK Nail
	1975	LCRC #795	Hooth	Copperweld rod in mon. box
	1978	LCRC #1138	VanKooten	1/2" Iron in mon. box
	1982	LCRC #3068	Jonker	Set Kent County Monument in mon. box
	1990	LCRC #5413	Starr	Kent County Monument

The position of this corner was previously approved by the Kent County Remonumentation Peer Group, monumented by Robert J. Jonker on 8/17/82 and was recorded per LCRC #3068

B. Description of corner evidence found and/or method applied in restoring or reestablishing corner:

K-9 Found MDSH Monument (after road const.) inside a mon. box at the same position as the standard Kent Co. Mon. (Harrison) per witnesses from above LCRC as set in 1982 by Robert J. Jonker in place of the 1/2" Iron he found inside a mon. box. Said Iron checks with LCRC's #225, #795, #1138 and previous measurements by various surveyors.

LCRC #3068 & #5413

Nail & KC Remon. tag NE side T. Pole	N50°E	59.53'	On C/L E-W pavement
Nail & KC Remon. tag NW side G. Pole	N40°E	51.65'	
C/L N. bound const. joint	West	36.44'	P.A. 345 1990 KENT COUNTY
Set chiseled "X" on N. end culv.	N20°E	48.57'	PEER APPROVED 6/22/99
Set chiseled "X" on S. end culv.	S20°E	39.96'	CHAIRMAN Harry Hubert
C/L manhole	S75°E	31.12'	

The selected location is accepted by me and is generally accepted by professional surveyors as the best available evidence of the position of the original corner.

C. Description of monument for corner and accessories established to perpetuate locating the position of the corner:

K-9 MDSH Monument in mon. box			
C/L N. bound M-37	West	36.44'	more or less
Fd. chiseled "X" on N. end culv.	N20°E	48.57'	
Set chiseled "X" on S. end culv.	S15°E	63.51'	
C/L manhole	S75°E	31.21'	
Set Nail & KC Remon. tag SE side P. Pole	N30°E	62.18'	
Set Nail & KC Remon. tag SW side P. Pole	S35°E	74.70'	
NW cor. brick bldg.	S65°E	129.95'	
On C/L E-W pavement			

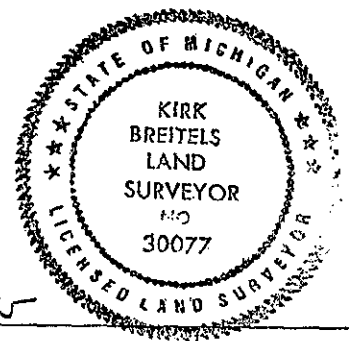

Signed by Kirk Breitels

Date 6/22/95

Surveyor's Michigan License No. 30077