

\$7.00
\$2.00

SEP 1 8 1985
COMMISSION

KENT COUNTY REMONUMENTATION

LAND CORNER RECORDATION CERTIFICATE
Filing Requirement of Act 74, Mich. P.A. 1970

For corners in KENT COUNTY (County) Located In: Corner Code #

1. Public Land Survey	T <u>8N</u> R <u>12W</u>	<u>K-10</u>
	T _____ R _____	_____
	T _____ R _____	_____
	T _____ R _____	_____
2. Property Controlling in Section	S _____ T _____ R _____	_____
	S _____ T _____ R _____	_____
3. Miscellaneous Property in Section	S _____ T _____ R _____	_____
	S _____ T _____ R _____	_____

4. Lot No. _____, Recorded Plat _____

5. Private Claims _____

STATE OF MICHIGAN
COUNTY OF KENT
RECEIVED FOR RECORD

95 JUN 29 AM 11:57

REG. OF DEEDS
Lucy Bond
8502

Register of Deeds Stamp & File Number

A	B	C	D	E	F	G	H	I	J	K	L	M
2	6	5	4	3	2	1						
3												
4	7	8	9	10	11	12						
5												
6	18	17	16	15	14	13						
7												
8	19	20	21	22	23	24						
9												
10	30	29	28	27	26	25						
11												
12	31	32	33	34	35	36						
13												

I, Kirk Breitels, in a field survey on May 10, 1995, do hereby certify that under requirements of P.A. 74, Michigan P.A. of 1970, the corner points mentioned in lines 1 and 2 above were in conformance with regulations and rules therefore as required in the current manual of survey instructions of the United States Department of the Interior, Bureau of Land Management or by a decree of a Court of Law and/or that the corner points mentioned in lines 3, 4 and 5 above were in conformance with the rules of the Michigan Board of Professional Surveyors or by a Decree of a Court of Law; established, re-established, monumented, re-monumented, recovered, found as expressed below:

NOTE: Not more than 4 corners, all in the same town and range, may be recorded on this certificate.

A. Description of original monument and accessories and/or subsequent restoration:

K-10	1838	GLO	Whitcomb	Set Post
	1949	Kent Co. Wit.		Boat Spike in mon. box
	1974	LCRC #744	Bonnema	3/4" Solid Iron in mon. box
	1981	LCRC #2566	Bueche	Set Kent County Monument in mon. box
	1990	LCRC #5414	Starr	Kent County Monument

The position of this corner was previously approved by the Kent County Remonumentation Peer Group, monumented by John C. Bueche on 12/4/81 and was recorded per LCRC #2566.

B. Description of corner evidence found and/or method applied in restoring or reestablishing corner:

K-10 Found standard Kent Co. Mon. (Harrison) per witnesses from above LCRC as set by John C. Bueche in place of the 1/4" x 24" Solid Iron he found inside a mon. box. Said Iron checks with Kent Co. Wit. and LCRC #744.

LCRC #2566 & #5414

Nail & KC Remon. tag N. side Tele. Pole	N90°E	47.90'	P.A. 345 1990 KENT COUNTY PEER APPROVED 6/22/95 CHAIRMAN <i>Harry Bueche</i>
Nail & KC Remon. tag SW side Power Pole	S35°E	63.54'	
"X" cut in conc. curb	N65°W	76.70'	
"X" cut in conc. curb	S75°W	59.24'	
C/L S. bound M-37 is West 28.56'			
On C/L blktp. West			

The selected location is accepted by me and is generally accepted by professional surveyors as the best available evidence of the position of the original corner.

C. Description of monument for corner and accessories established to perpetuate locating the position of the corner:

K-10 Standard Kent County Monument			
Nail & KC Remon. tag SW side Power Pole	S35°E	63.54'	
"X" cut in conc. curb	S75°W	59.24'	
Set Nail & KC Remon. tag SE side Power Pole	S55°W	95.95'	
Set Nail & KC Remon. tag E. side Power Pole	N40°W	153.04'	
C/L top of fire hydrant	N35°E	82.66'	
C/L manhole	N65°E	49.21'	
C/L S. bound M-37 is West 28.56' more or less			
On C/L blktp. West more or less			

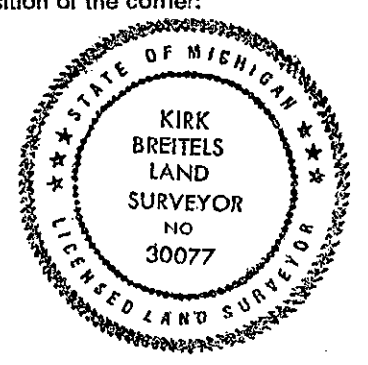

Signed by *Kirk Breitels* Date 6/22/95
Surveyor's Michigan License No. 30077