

\$7.00
\$2.00

SEP 13 1995

KENT COUNTY REMONUMENTATION

LAND CORNER RECORDATION CERTIFICATE

Filing Requirement of Act 74, Mich. P.A. 1970

For corners in
KENT COUNTY
(County)

Located In:

Corner Code #

1. Public Land Survey	T	<u>8N</u>	R	<u>12W</u>	<u>M-9</u>
	T	_____	R	_____	_____
	T	_____	R	_____	_____
	T	_____	R	_____	_____
2. Property Controlling in Section	S	_____	T	_____	R
	S	_____	T	_____	R
3. Miscellaneous Property in Section	S	_____	T	_____	R
	S	_____	T	_____	R

REG. OF DEEDS

Lucy Bond

95 JUN 29 PM 12:00

STATE OF MICHIGAN
COUNTY OF KENT
RECEIVED FOR RECORD

8515

Register of Deeds Stamp & File Number

- 4. Lot No. _____, Recorded Plat _____
- 5. Private Claims _____

A	B	C	D	E	F	G	H	I	J	K	L
2	6	5	4	3	2	1					
3											
4	7	8	9	10	11	12					
5											
6	16	17	16	15	14	13					
7											
8	19	20	21	22	23	24					
9											
10	30	29	28	27	26	25					
11											
12	31	32	33	34	35	36					
13											

I, Kirk Breitels, in a field survey on March 20, 19 95

do hereby certify that under requirements of P.A. 74, Michigan P.A. of 1970, the corner points mentioned in lines 1 and 2 above were in conformance with regulations and rules therefore as required in the current manual of survey instructions of the United States Department of the Interior, Bureau of Land Management or by a decree of a Court of Law and/or that the corner points mentioned in lines 3, 4 and 5 above were in conformance with the rules of the Michigan Board of Professional Surveyors or by a Decree of a Court of Law; established, re-established, monumented, re-monumented, recovered, found as expressed below:

NOTE: Not more than 4 corners, all in the same town and range, may be recorded on this certificate.

A. Description of original monument and accessories and/or subsequent restoration:

M-9	1837	GLO	Brookfield	Set Post
	1935	Kent Co. Wit.		1" Iron
	1971	LCRC #72	Chambers	3/4" Iron in mon. box
	1974	LCRC #734	Spicer	1" Iron in mon. box
	1981	LCRC #2136	Jonker	Intersection of chisel marks on MH rim
	1990	LCRC #5431	Starr	Intersection of chisel marks on MH rim

The position of this corner was previously approved by the Kent County Remonumentation Peer Group, monumented (no monument set) by Robert J. Jonker on 8/27/81 and was recorded per LCRC #2136.

B. Description of corner evidence found and/or method applied in restoring or reestablishing corner:

M-9 Found intersection of chisel marks on manhole rim per witnesses from above LCRC as found by Robert J. Jonker. Said intersection of chisel marks on MH rim checks with Kent Co. Road Commission information (1978) of road const. project.

LCRC #2136 & #5431

Nail & KC Remon. tag NW side P. Pole	N58°E	56.07'
Nail & KC Remon. tag N. side 30" Pine	S67°E	99.48'
Nail & KC Remon. tag NE side P. Pole	N50°W	56.18'
Nail & KC Remon. tag in curb joint	S48°W	51.61'
NW cor. house foundation	S43°E	91.90'
C/L MH - West 0.72'		

P.A. 345 1990 KENT COUNTY
PEER APPROVED 6/22/95
CHAIRMAN *Harry Thubert*

On C/L bit. rd. E-W-N; C/L bit. rd. South is 3' West

The selected location is accepted by me and is generally accepted by professional surveyors as the best available evidence of the position of the original corner.

C. Description of monument for corner and accessories established to perpetuate locating the position of the corner:

M-9	Intersection of chisel marks on manhole rim		
	Nail & KC Remon. tag NW side P. Pole	N58°E	56.07'
	New Nail & KC Remon. tag N. side 36" Pine	S67°E	99.42'
	Nail & KC Remon. tag NE side P. Pole	N50°W	56.18'
	PK Nail in curb joint	S48°W	51.61'
	NW cor. house foundation	S43°E	91.90'
	C/L MH - West 0.72'		
	On C/L bit. rd. E-W-N; C/L bit. rd. South is 3' West		

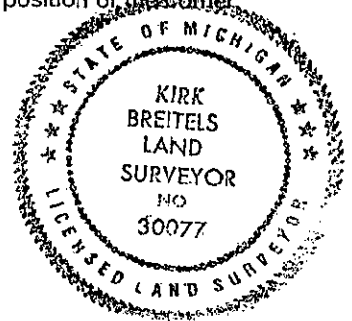

Signed by Kirk Breitels

Date 6/22/95

Surveyor's Michigan License No. 30077