

**SURVEY & REMONUMENTATION**

MAY 28 2000

**SECTION**

**LAND CORNER RECORDATION CERTIFICATE**  
**Filing Requirement of Act 74, Mich. P.A. 1970**  
**KENT COUNTY REMONUMENTATION**

For corners in

Kent (County)	Located in: Oakfield Township	Corner Code #
1. Public Land Survey	T <u>9N</u> R <u>9W</u>	<u>A-9</u>
	T _____ R _____	_____
	T _____ R _____	_____
	T _____ R _____	_____
2. Property Controlling in Section	S _____ T _____ R _____	_____
	S _____ T _____ R _____	_____
3. Miscellaneous Property in Sec.	S _____ T _____ R _____	_____
	S _____ T _____ R _____	_____

STATE OF MICHIGAN  
 COUNTY OF KENT  
 RECEIVED FOR RECORD  
 1999 OCT 15 AM 8:09  
 REG. OF DEEDS  
 11398  
 Register of Deeds Stamp & File Number

4. Lot No. \_\_\_\_\_, Recorded Plat \_\_\_\_\_  
 5. Private Claims \_\_\_\_\_

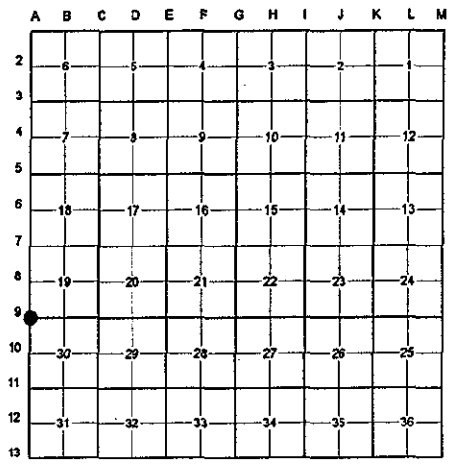

I, Randy Kolehouse, in a field survey on March 16 19 99, do hereby certify that under requirements of P.A. 74 Michigan P.A. of 1970, the corner points mentioned in lines 1 and 2 above were in conformance with regulations and rules therefore as required in the current manual of survey instructions of the United States Department of the interior, Bureau of Land Management or by a decree of a Court of Law and/or that the corner points mentioned in lines 3, 4 and 5 above were in conformance with the rules of the Michigan Board of Land Surveyors or by a Decree of a Court of Law; established, re-established, monumented, re-monumented, recovered, found as expressed below:

**NOTE: Not more than 4 corners, all in the same town and range, may be recorded on this certificate.**

**A. Description of original monument and accessories and/or subsequent restoration:**

A-9	1837	G.L.O. Notes	Cathcart	Set Post
	1935	Witness Map	K.C. Surveyor	Boat Spike in 8" Post in Swamp
	1984	L.C.R.C. #3922	William R. Byl	Fnd. "T" Iron in Post / Set K.C. Monument
	1991	L.C.R.C. #6214	Chris Marschall	K.C. Monument

Note: This corner is common with M-9, T9N, R10W.

This corner was originally approved by the Kent County Remonumentation Peer Group and monumented by William Byl on 3/19/84 and was recorded per L.C.R.C. #3922.

**P.A. 345 1990 KENT COUNTY**  
**PEER APPROVED 7/29/99**  
**CHAIRMAN Randy Kolehouse**

**B. Description of corner evidence found and/or method applied in restoring or reestablishing corner:**

A-9 Found a Standard Kent County Monument in a swamp on the C/L of 12 Mile Road extended West 186' West of the C/L of Ramsdell Drive running North (1.6' under water) per L.C.R.C.'s #3922 and #6214 as set by William Byl which checked the K.C. Surveyor's records.

**L.C.R.C. #3922**

- Nail & tag, N. sd. 24" Oak S 45 E 152.3
- Nail & tag, S. sd. 30" Oak N 90 E 159.0'
- "T" iron in C/L of Ramsdell Rd. N 90 E 186.4'

**L.C.R.C. #6214**

- Nail & Tag N sd. 26" Oak S 45 E 152.30'
- Nail & Tag S sd. 32" Oak N 90 E 159.0'
- "T" iron in centerline Ramsdell N 90 E 186.40'

The selected location is accepted by me and is generally accepted by professional surveyors as the best available evidence of the position of the original corner.

**C. Description of monument for corner and accessories established to perpetuate locating the position of the corner:**

**A-9 Standard Kent County Monument**

- Nail & K.C. remon. tag on N side 26" Oak S 45° E 152.30'
- Nail & K.C. remon. tag on S side 32" Oak N 90° E 159.00'
- "T" iron C/L intersection Ramsdell & 12 Mile N 90° E 186.40'
- SW cor. frame garage at NE cor. Ramsdell & 12 Mile Rd. N 75° E 353.70'

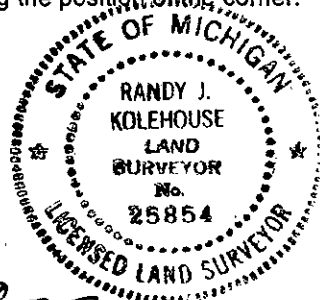

Signed by Randy J. Kolehouse Date 9-27-99  
 WILLIAMS & WORKS

Surveyor's Michigan License No. 25854