

\$7.00
\$2.00

MAY 22 2000

LAND CORNER RECORDATION CERTIFICATE
Filing Requirement of Act 74, Mich. P.A. 1970
KENT COUNTY REMONUMENTATION

SECTION

For corners in

Kent (County)	Located in: Oakfield Township	Corner Code #
1. Public Land Survey	T 9N R 9W	F-7
	T R	
	T R	
	T R	
2. Property Controlling in Section	S T R	
	S T R	
3. Miscellaneous Property in Sec.	S T R	
	S T R	

STATE OF MICHIGAN
COUNTY OF KENT
RECEIVED FOR RECORD
1999 OCT 27 AM 8:38

REG. OF DEEDS

11430

Register of Deeds Stamp & File Number

4. Lot No. _____, Recorded Plat _____
5. Private Claims _____

I, Randy Kolehouse, in a field survey on March 16 19 99, do hereby certify that under requirements of P.A. 74 Michigan P.A. of 1970, the corner points mentioned in lines 1 and 2 above were in conformance with regulations and rules therefore as required in the current manual of survey instructions of the United States Department of the interior, Bureau of Land Management or by a decree of a Court of Law and/or that the corner points mentioned in lines 3, 4 and 5 above were in conformance with the rules of the Michigan Board of Land Surveyors or by a Decree of a Court of Law; established, re-established, monumented, re-monumented, recovered, found as expressed below:

NOTE: Not more than 4 corners, all in the same town and range, may be recorded on this certificate.

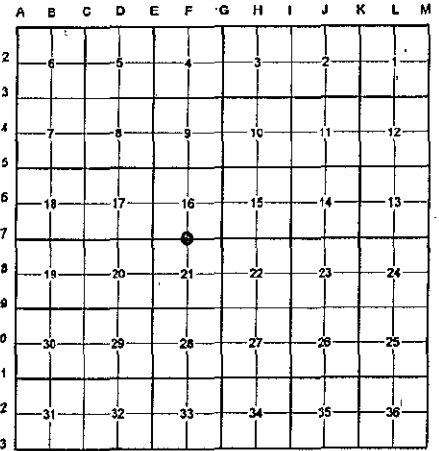

A. Description of original monument and accessories and/or subsequent restoration:

F-7	1837	G.L.O. Notes	Cathcart	Set Post
	1963	Witness Map	K.C. Surveyor	1" Iron in Concrete
	1982	L.C.R.C. #2506	C.S. Hay	Fnd. Iron in Conc. Monument / Set K.C. Monument
	1989	L.C.R.C. #5203	John Bueche	K.C. Monument
	1997	L.C.R.C. #9673	Kirk Breitels	K.C. Monument

This corner was originally approved by the Kent County Remonumentation Peer Group and monumented by Clayton Hay on 11/20/81 and was recorded per L.C.R.C. #2506.

B. Description of corner evidence found and/or method applied in restoring or reestablishing corner:

F-7 Found a Standard Kent County Monument 3.5' North of the C/L intersection of 13 Mile Road (gravel) running East and West and Wellman Road (gravel) running North per L.C.R.C.'s #2506, #5203, and #9673 as set by Clayton Hay in place of a 1" iron in concrete which checked the K.C. Surveyor's records.

L.C.R.C. #2506

L.C.R.C. #9673

Nail and Remon. Tag in West side of 20" Oak S 5°E. 26.45'
Nail and Remon. Tag in West side of 19" Oak S 5°W. 46.05'
Nail and Remon. Tag in SE side of 20" Oak N 75°E. 62.25'
Nail and Remon. Tag in SE side of 23" Oak of a twin, N 40°E. 67.33'
Nail and Remon. Tag in NE side of 20" Oak N 43°W. 82.53'
On approx. center of N-S gravel rd; and
3.5' North of center of E-W gravel rd.

Nail & KC Remon. tag W. side 36" Oak S05°E 26.45' (m. 26.42')
Nail & KC Remon. tag W. side 28" Oak S05°W 46.33; *n. 46.29')
Nail & KC Remon. tag SE side 28" Oak N75°E 62.27' (m. 62.25')
Nail & KC Remon. tag SE side Tw. 28" Oak N40°E 67.28' (m. 67.29')
Nail & KC Remon. tag SE side 30" Oak N43°W 82.47' (m. 82.39')
On approx. C/L gravel N. and 3.5' +/- N. of C/L E-W gravel road

The selected location is accepted by me and is generally accepted by professional surveyors as the best available evidence of the position of the original corner.

C. Description of monument for corner and accessories established to perpetuate locating the position of the corner:

F-7 Standard Kent County Monument

Nail & K.C. remon. tag on W side 36" Oak S 05° E 26.42'
Nail & K.C. remon. tag on W side 28" Oak S 05° W 46.29'
Nail & K.C. remon. tag on SE side 28" Oak N 75° E 62.25'
Nail & K.C. remon. tag on SE side twin 28" Oak N 40° E 67.29'
Nail & K.C. remon. tag on SE side 30" Oak N 43° W 82.39'
C/L "X" of gravel roads running E-W & N, South 3.5'

P.A. 345 1990 KENT COUNTY

PEER APPROVED 7/29/99
CHAIRMAN *[Signature]*

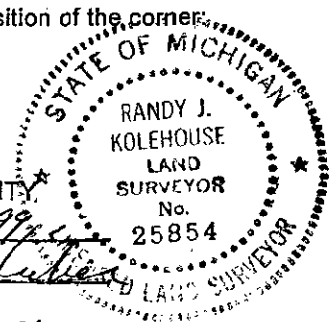

Signed by Randy J. Kolehouse Date 10-11-99

WILLIAMS & WORKS

Surveyor's Michigan License No. 25854