

MAY 22 2000

SECTION

LAND CORNER RECORDATION CERTIFICATE
Filing Requirement of Act 74, Mich. P.A. 1970
KENT COUNTY REMONUMENTATION

For corners in

Table with columns: Kent (County), Located in: Oakfield Township, Corner Code #. Rows include Public Land Survey, Property Controlling in Section, Miscellaneous Property in Sec., Lot No., and Private Claims.

REG. OF DEEDS stamp with date 1999 OCT 27 AM 8:38 and number 11442. Register of Deeds Stamp & File Number.

I, Randy Kolehouse, in a field survey on March 23 19 99, do hereby certify that under requirements of P.A. 74 Michigan P.A. of 1970, the corner points mentioned in lines 1 and 2 above were in conformance with regulations and rules therefore as required in the current manual of survey instructions of the United States Department of the interior, Bureau of Land Management or by a decree of a Court of Law and/or that the corner points mentioned in lines 3, 4 and 5 above were in conformance with the rules of the Michigan Board of Land Surveyors or by a Decree of a Court of Law; established, re-established, monumented, re-monumented, recovered, found as expressed below:

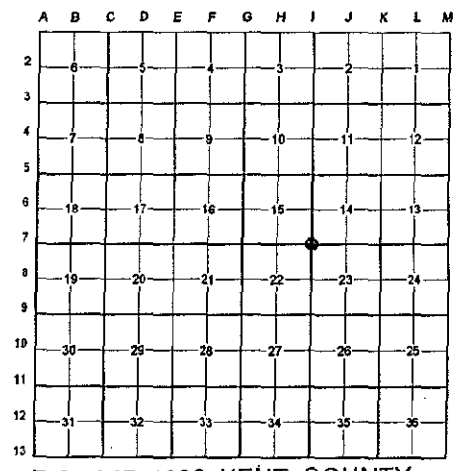

NOTE: Not more than 4 corners, all in the same town and range, may be recorded on this certificate.

A. Description of original monument and accessories and/or subsequent restoration:

Table with columns: Year (1837, 1974, 1976, 1985, 1994), Description (G.L.O. Notes, Survey, L.C.R.C. #921, #4150, #7220), Name (Cathcart, Medema, Van Kooten & Associates, James Porter, Thomas Chettleburgh, Glaza & Associates), and Monument Type (Set Post, PK Nail, 1/2" Rerod, Fnd. PK Nail / Set K.C. Monument, K.C. Monument).

P.A. 345 1990 KENT COUNTY PEER APPROVED 7/29/99 CHAIRMAN Randy Kolehouse

This corner was originally approved by the Kent County Remonumentation Peer Group and monumented by Thomas Chettleburgh on 4/2/85 and was recorded per L.C.R.C. #4150.

B. Description of corner evidence found and/or method applied in restoring or reestablishing corner:

I-7 Found a Standard Kent County Monument on the C/L of Lincoln Lake Avenue (bit.) running North and South, on line of a woods line running East, per L.C.R.C.'s #4150 and #7220 as set by Thomas Chettleburgh in place of a PK nail he found which checked L.C.R.C. #921 and a 1974 survey by Medema, Van Kooten & Associates.

Table comparing L.C.R.C. #4150 and L.C.R.C. #7220 evidence. Columns: L.C.R.C. #4150, L.C.R.C. #7220. Rows list various monument types and bearings/distances.

The selected location is accepted by me and is generally accepted by professional surveyors as the best available evidence of the position of the original corner.

C. Description of monument for corner and accessories established to perpetuate locating the position of the corner:

- I-7 Standard Kent County Monument
Nail & K.C. remon. tag on NW side P. pole N 43° E 102.71'
Nail & K.C. remon. tag on N side railroad tie post S 79° E 34.85'
Nail & K.C. remon. tag on S side 10", 8", 6" triple Maple S 83° W 45.57'
Nail & K.C. remon. tag on E side 21", 12" twin Oak N 07° W 171.43'
1/2" iron bar N 88° E 17.10'
C/L of bit road running N-S

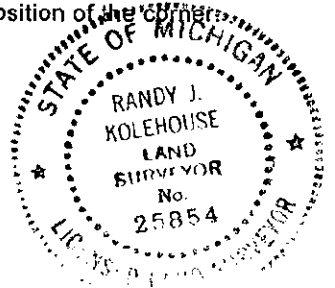

Signed by Randy J. Kolehouse Date 10-11-99
WILLIAMS & WORKS
Surveyor's Michigan License No. 25854