

MAY 24 2000

\$7.00
\$2.00

SECTION

LAND CORNER RECORDATION CERTIFICATE
Filing Requirement of Act 74, Mich. P.A. 1970
KENT COUNTY REMONUMENTATION

For corners in

Kent (County)	Located in: Oakfield Township	Corner Code #
1. Public Land Survey	T <u>9N</u> R <u>9W</u>	<u>J-12</u>
	T _____ R _____	_____
	T _____ R _____	_____
	T _____ R _____	_____
2. Property Controlling in Section	S _____ T _____ R _____	_____
	S _____ T _____ R _____	_____
3. Miscellaneous Property in Sec.	S _____ T _____ R _____	_____
	S _____ T _____ R _____	_____

REG. OF DEEDS

[Signature]

STATE OF MICHIGAN
COUNTY OF KENT
RECEIVED FOR RECORD
1999 DEC 27 AM 8:19

11651

Register of Deeds Stamp & File Number

- 4. Lot No. _____, Recorded Plat _____
- 5. Private Claims _____

I, Randy Kolehouse, in a field survey on December 14 19 99, do hereby certify that under requirements of P.A. 74 Michigan P.A. of 1970, the corner points mentioned in lines 1 and 2 above were in conformance with regulations and rules therefore as required in the current manual of survey instructions of the United States Department of the Interior, Bureau of Land Management or by a decree of a Court of Law and/or that the corner points mentioned in lines 3, 4 and 5 above were in conformance with the rules of the Michigan Board of Land Surveyors or by a Decree of a Court of Law; established, re-established, monumented, re-monumented, recovered, found as expressed below:

NOTE: Not more than 4 corners, all in the same town and range, may be recorded on this certificate.

A. Description of original monument and accessories and/or subsequent restoration:

J-12 This corner was not originally set by the G.L.O.

No information on record.

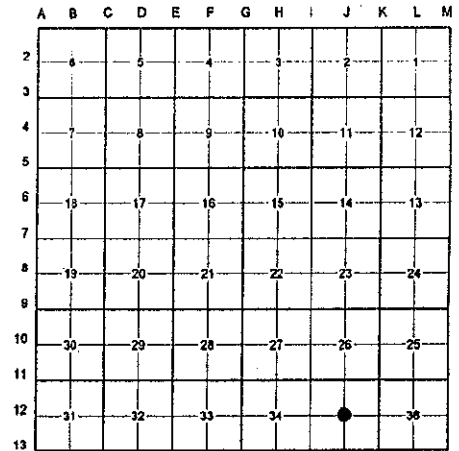

P.A. 345 1990 KENT COUNTY

PEER APPROVED 6/24/99

CHAIRMAN *[Signature]*

B. Description of corner evidence found and/or method applied in restoring or reestablishing corner:

J-12 Found no record information pertaining to this corner. Set point at the intersection of 1/4 lines. This point falls in the center line +/- of Tully Avenue (gravel) running North and South on line m/l with a fence line running East.

The selected location is accepted by me and is generally accepted by professional surveyors as the best available evidence of the position of the original corner.

C. Description of monument for corner and accessories established to perpetuate locating the position of the corner:

J-12 Set a Standard Kent County Monument

- Nail & K.C. remon. tag on N side 30" Maple N 87° E 36.76'
- Nail & K.C. remon. tag on SW side 12" Hickory S 40° E 32.73'
- Nail & K.C. remon. tag on SE side 28" Hickory S 40° W 44.32'
- Nail & K.C. remon. tag on E side 26" Hickory N 03° W 112.43'
- In C/L of gravel road running N-S

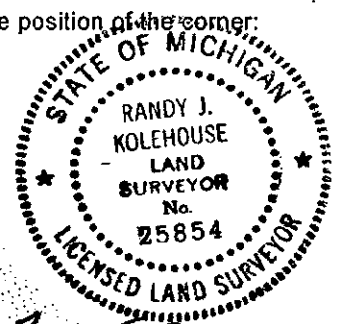

Signed by *[Signature]*

Date 12-10-99

WILLIAMS & WORKS

Surveyor's Michigan License No. 25854