

MAY 22 2000

\$7.00  
\$2.00

SECTION

LAND CORNER RECORDATION CERTIFICATE  
Filing Requirement of Act 74, Mich. P.A. 1970  
KENT COUNTY REMONUMENTATION

For corners in

Kent (County)	Located in: Oakfield Township	Corner Code #
1. Public Land Survey	T <u>9N</u> R <u>9W</u>	<u>M-7</u>
	T _____ R _____	_____
	T _____ R _____	_____
	T _____ R _____	_____
2. Property Controlling in Section	S _____ T _____ R _____	_____
	S _____ T _____ R _____	_____
3. Miscellaneous Property in Sec.	S _____ T _____ R _____	_____
	S _____ T _____ R _____	_____

STATE OF MICHIGAN  
COUNTY OF KENT  
RECEIVED FOR RECORD  
1999 DEC 27 AM 8:20  
REG. OF DEEDS  
*[Signature]*  
**11670**  
Register of Deeds Stamp & File Number

- 4. Lot No. \_\_\_\_\_, Recorded Plat \_\_\_\_\_
- 5. Private Claims \_\_\_\_\_

I, Randy Kolehouse, in a field survey on March 26 19 99, do hereby certify that under requirements of P.A. 74 Michigan P.A. of 1970, the corner points mentioned in lines 1 and 2 above were in conformance with regulations and rules therefore as required in the current manual of survey instructions of the United States Department of the Interior, Bureau of Land Management or by a decree of a Court of Law and/or that the corner points mentioned in lines 3, 4 and 5 above were in conformance with the rules of the Michigan Board of Land Surveyors or by a Decree of a Court of Law; established, re-established, monumented, re-monumented, recovered, found as expressed below:

**NOTE: Not more than 4 corners, all in the same town and range, may be recorded on this certificate.**

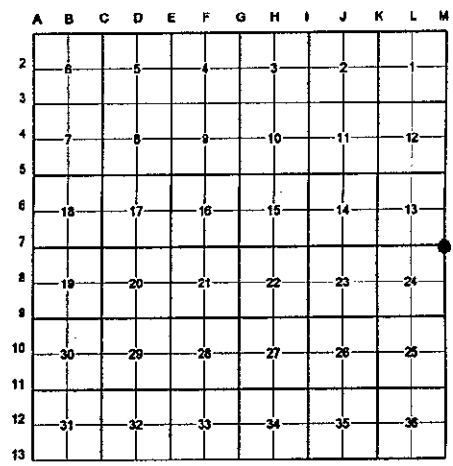

A. Description of original monument and accessories and/or subsequent restoration:

M-7	1837	G.L.O. Notes	Cathcart	Set Post
	1913-50	Notes	Williams & Works	Set Iron
	1983	L.C.R.C. #3589	William Byl	1/2" Iron with Cap
	1984	L.C.R.C. #3942	William Byl	Fnd. 1/2" Iron / Set K.C. Monument
	1994	L.C.R.C. #7260	Glaza & Associates	K.C. Monument

P.A. 345 1990 KENT COUNTY  
PEER APPROVED 7/29/99  
CHAIRMAN [Signature]

Note: This corner is common with A-7, T9N, R8W.

This corner was originally approved by the Kent County Remonumentation Peer Group and monumented by William Byl on 9/20/84 and was recorded per L.C.R.C. #3942.

B. Description of corner evidence found and/or method applied in restoring or reestablishing corner:

M-7 Found a Standard Kent County Monument on the C/L of Montcalm Avenue (gravel) running North and South, on line of a tree row and fence line running East and West, per L.C.R.C. #7260. Monument set by Byl was replaced by Glaza & Associates.

L.C.R.C. #7260

- Nail & K.C. remon tag in NW side 4" Twin Oak N60°E 39.92' (m. 39.94')
- Nail & K.C. remon tag in S side 6" Oak S80°W 32.07'
- Nail & K.C. remon tag in N side 10" Oak N72°W 32.77' (m. 32.75')
- Nail & K.C. remon tag in W side P. pole S10°W 101.43' (m. 101.40')
- In C/L North-South gravel road

The selected location is accepted by me and is generally accepted by professional surveyors as the best available evidence of the position of the original corner.

C. Description of monument for corner and accessories established to perpetuate locating the position of the corner:

- M-7 Standard Kent County Monument
- Nail & K.C. remon. tag on NW side 4" twin Oak N 60° E 39.94'
  - Nail & K.C. remon. tag on S side 6" Oak S 80° W 32.07'
  - Nail & K.C. remon. tag on N side 10" Oak N 72° W 32.75'
  - Nail & K.C. remon. tag on W side P. pole S 10° W 101.40'
  - On C/L of gravel road running N-S

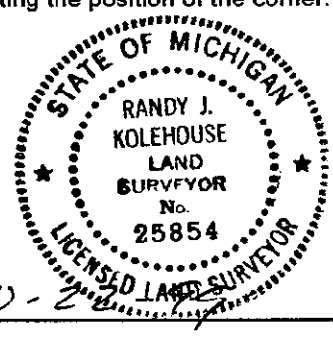

Signed by Randy J. Kolehouse Date 10-2-99  
WILLIAMS & WORKS

Surveyor's Michigan License No. 25854