

SURVEY & REMONUMENTATION

\$7.00
\$2.00

MAY 22 2000

LAND CORNER RECORDATION CERTIFICATE
Filing Requirement of Act 74, Mich. P.A. 1970
KENT COUNTY REMONUMENTATION

SECTION

For corners in

Kent (County)	Located in:	Oakfield Township	Corner Code #
1. Public Land Survey	T <u>9N</u>	R <u>9W</u>	Witness Mon.
	T _____	R _____	_____
	T _____	R _____	_____
	T _____	R _____	_____
2. Property Controlling in Section	S _____	T _____	East of G-10
	S _____	T _____	_____
3. Miscellaneous Property in Sec.	S _____	T _____	_____
	S _____	T _____	_____

STATE OF MICHIGAN
COUNTY OF KENT
RECEIVED FOR RECORD
1999 DEC - 8 AM 10: 06

REG. OF DEEDS
"other" #1
Seq #2
11555
Register of Deeds Stamp & File Number

4. Lot No. _____, Recorded Plat _____
5. Private Claims _____

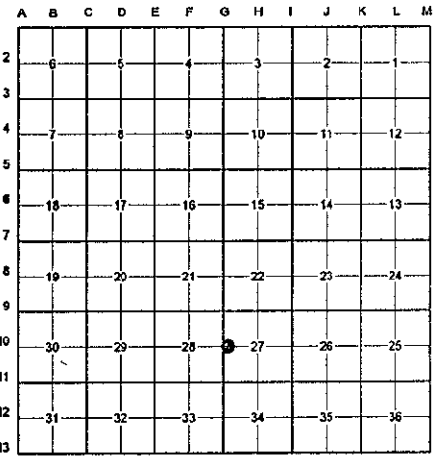

I, Randy Kolehouse, in a field survey on March 23 19 99, do hereby certify that under requirements of P.A. 74 Michigan P.A. of 1970, the corner points mentioned in lines 1 and 2 above were in conformance with regulations and rules therefore as required in the current manual of survey instructions of the United States Department of the interior, Bureau of Land Management or by a decree of a Court of Law and/or that the corner points mentioned in lines 3, 4 and 5 above were in conformance with the rules of the Michigan Board of Land Surveyors or by a Decree of a Court of Law; established, re-established, monumented, re-monumented, recovered, found as expressed below:

NOTE: Not more than 4 corners, all in the same town and range, may be recorded on this certificate.

A. Description of original monument and accessories and/or subsequent restoration:

G-10	1837	G.L.O. Notes	Cathcart	Set Post
	1993	L.C.R.C. #6826	Chris Marschall	Set K.C. Monument with Witness Cap
	1997	L.C.R.C. #9687	Kirk Breitels	K.C. Monument with Witness Cap

P.A. 345 1990 KENT COUNTY
PEER APPROVED 4/29/99
CHAIRMAN [Signature]

This corner was originally approved by the Kent County Remonumentation Peer Group and monumented by Chris Marschall in May of 1993 and was recorded per L.C.R.C. #6826.

B. Description of corner evidence found and/or method applied in restoring or reestablishing corner:

G-10 Found a Standard Kent County Witness Monument 30' ± East of waters edge on East edge of swamp per L.C.R.C.'s #6826 and #9687 as set by Chris Marschall on the E-W 1/4 line 928.78' West of Center of Section.

L.C.R.C. #6826

L.C.R.C. #9687

Centerline of 4" well S09° W 156.12'
NW corner block fnd. S07° W 86.17'
NE corner block fnd. S10° E 87.49'
NW corner garage siding S28° E 99.84'
More or less 30' to 40' W to waters edge

Centerline of 4" well S09°W 156.12' (m. 156.16')
NW corner block fnd. S07°W 86.17' (m. 86.09')
NE corner block fnd. S10°E 87.42' (m. 87.42')
NW corner garage siding S28°E 99.84' (m. 99.79')
30' to 40'+/- West to waters edge

The selected location is accepted by me and is generally accepted by professional surveyors as the best available evidence of the position of the original corner.

C. Description of monument for corner and accessories established to perpetuate locating the position of the corner:

G-10 Standard Kent County Witness Monument

C/L 4" well S 09° W 156.16'
NW cor. block fndn. S 07° W 86.09'
NE cor. block fndn. S 10° E 87.42'
NW cor. garage siding S 28° E 99.79'
Nail & K.C. remon. tag on S side clump Willows S 75° E 24.10'
East edge of swamp, West 30' ±

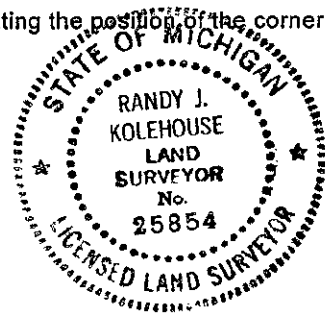

Signed by Randy J. Kolehouse Date 10-29-99
WILLIAMS & WORKS
Surveyor's Michigan License No. 25854