

\$7.00
\$2.00

SURVEY &
REMONUMENTATION

MAY 22 2000

LAND CORNER RECORDATION CERTIFICATE
Filing Requirement of Act 74, Mich. P.A. 1970

For corners in

SECTION

KENT COUNTY REMONUMENTATION

Kent (County)	Located in:	Courtland Township	Corner Code #
1. Public Land Survey	T 9N	R 10W	B-1
	T	R	
	T	R	
	T	R	
2. Property Controlling in Section	S	T	R
	S	T	R
3. Miscellaneous Property in Sec.	S	T	R
	S	T	R

REG. OF DEEDS

[Signature]

STATE OF MICHIGAN
COUNTY OF KENT
RECEIVED FOR RECORD
1999 OCT 15 AM 8:00

11266

Register of Deeds Stamp & File Number

- 4. Lot No. _____, Recorded Plat _____
- 5. Private Claims _____

I, Randy Kolehouse, in a field survey on January 25 19 99, do hereby certify that under requirements of P.A. 74 Michigan P.A. of 1970, the corner points mentioned in lines 1 and 2 above were in conformance with regulations and rules therefore as required in the current manual of survey instructions of the United States Department of the Interior, Bureau of Land Management or by a decree of a Court of Law and/or that the corner points mentioned in lines 3, 4 and 5 above were in conformance with the rules of the Michigan Board of Land Surveyors or by a Decree of a Court of Law; established, re-established, monumented, re-monumented, recovered, found as expressed below:

NOTE: Not more than 4 corners, all in the same town and range, may be recorded on this certificate.

A. Description of original monument and accessories and/or subsequent restoration:

B-1 This corner was not originally set by the G.L.O.

1973	L.C.R.C. #613	Medema, Van Kooten & Assoc.	1-1/4" Pipe
1985	Notes	Williams & Works	N/A
1989	L.C.R.C. #5237	Randy Kolehouse	Fnd. 1" Iron / Set K.C. Monument
1992	L.C.R.C. #6622	John Bueche	K.C. Monument

Note: This corner is not common with B-13, T10N, R10W.

This corner was originally approved by the Kent County Remonumentation Peer Group and monumented by Randy Kolehouse on 10/21/89 and was recorded per L.C.R.C. #5237.

B. Description of corner evidence found and/or method applied in restoring or reestablishing corner:

B-1 Found a Standard Kent County Monument 1.5' ± South of the C/L of 16 Mile Road (bit.) running East and West per L.C.R.C.'s #5237 and #6622 as set by Randy Kolehouse in place of a 1" iron he found 112.0' East of a Kent County Monument at the South 1/4 corner of Section 31, T10N, R10W, which checked L.C.R.C. #613 and the 1985 Notes of Williams & Works.

L.C.R.C. #5237

L.C.R.C. #6622

Nail & K.C. Remon. tag in 8" Elm N 50° E 61.78'
K.C. Mon at S1/4 cor sec. 31 T 10 N R 10 W West 111.95'
Fence running Southly West 69'
C/L 16 Mile Road (gravel) North 3' m/l

Nail & K.C. Remon. Tag in W side 8" Ash S 10° E 47.99' (m. 48.02')
Nail & K.C. Remon. Tag in SE side 6" Ash N 60° E 54.75'
Nail & K.C. Remon. Tag in E side 8" Poplar North 46.98' (m. 46.98')
Nail & K.C. Remon. Tag in E side 8" Elm S 80° W 87.06' (m. 87.04')
C/L bit. E-W, N 1.5' +/-
K.C. Mon. (S 1/4 31, 10-10) West 111.91' (m. 111.75')

The selected location is accepted by me and is generally accepted by professional surveyors as the best available evidence of the position of the original corner.

C. Description of monument for corner and accessories established to perpetuate locating the position of the corner:

B-1 Standard Kent County Monument

Nail & K.C. remon. tag on W side 10" Ash S 10° E 48.02'
Nail & K.C. remon. tag on SE side 8" Ash N 60° E 54.75'
Nail & K.C. remon. tag on E side 8" Poplar North 46.98'
Nail & K.C. remon. tag on E side 8" Elm S 80° W 87.04'
C/L of bit. road running E-W, North 1.5' ±
K.C. Mon. B-13, T10N, R10W, West 111.75'

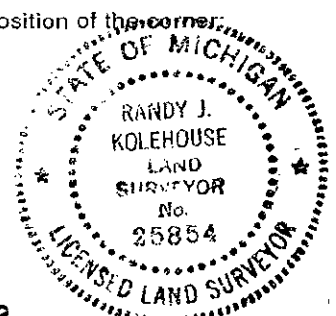

Signed by Randy J. Kolehouse
EARTH TECH

Date 3/30/99

Surveyor's Michigan License No. 25854