

MAY 22 2000

\$7.00  
\$2.00

SECTION LAND CORNER RECORDATION CERTIFICATE  
Filing Requirement of Act 74, Mich. P.A. 1970  
KENT COUNTY REMONUMENTATION

For corners in

Kent (County)	Located in:	Courtland Township	Corner Code #
1. Public Land Survey	T <u>9N</u>	R <u>10W</u>	<u>B-4</u>
	T _____	R _____	_____
	T _____	R _____	_____
	T _____	R _____	_____
2. Property Controlling in Section	S _____	T _____	R _____
	S _____	T _____	R _____
3. Miscellaneous Property in Sec.	S _____	T _____	R _____
	S _____	T _____	R _____

REG. OF DEEDS

STATE OF MICHIGAN  
COUNTY OF KENT  
RECEIVED FOR RECORD  
1999 OCT 15 AM 8:02

11269

Register of Deeds Stamp & File Number

4. Lot No. \_\_\_\_\_, Recorded Plat \_\_\_\_\_  
5. Private Claims \_\_\_\_\_

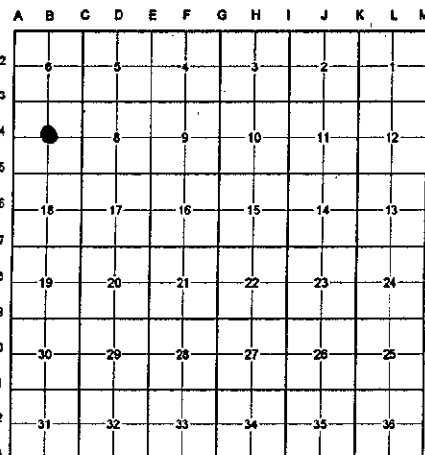

I, Randy Kolehouse, in a field survey on March 16 19 99, do hereby certify that under requirements of P.A. 74 Michigan P.A. of 1970, the corner points mentioned in lines 1 and 2 above were in conformance with regulations and rules therefore as required in the current manual of survey instructions of the United States Department of the interior, Bureau of Land Management or by a decree of a Court of Law and/or that the corner points mentioned in lines 3, 4 and 5 above were in conformance with the rules of the Michigan Board of Land Surveyors or by a Decree of a Court of Law; established, re-established, monumented, re-monumented, recovered, found as expressed below:

NOTE: Not more than 4 corners, all in the same town and range, may be recorded on this certificate.

A. Description of original monument and accessories and/or subsequent restoration:

B-4 This corner was not originally set by the G.L.O.

1933	Witness Map	K.C. Surveyor	1 1/2" Iron
1974	L.C.R.C. #729	Gordon Nederveld	Capped MVK Iron

B. Description of corner evidence found and/or method applied in restoring or reestablishing corner:

B-4 Found a capped Exxel iron 45' ± South of Russell Street (bit.) running East and West and on the East side of Decker Creek running NE-SW. This iron checks the approximate location of an iron set by Medema-VanKooten in 1974 (L.C.R.C. #729) per one remaining witness. The found capped iron is 0.6' South and 0.2' West of the intersection of 1/4 lines. Accepted capped Exxel iron as Center of Section.

L.C.R.C. #729

Sq. Spike N. side 8" W. Cherry ESE 10.53' (m. 11.20')

P.A. 345 1990 KENT COUNTY

PEER APPROVED 8/26/99

CHAIRMAN Randy Kolehouse

The selected location is accepted by me and is generally accepted by professional surveyors as the best available evidence of the position of the original corner.

C. Description of monument for corner and accessories established to perpetuate locating the position of the corner:

B-4 Replaced Capped Exxel Iron with a Standard Kent County Monument

"X" cut SE cor. conc. box culv. N 55° W 24.38'  
Nail & K.C. remon. tag on N side 12" Cherry S 70° E 11.42'  
Nail & K.C. remon. tag on S side 12" Cherry S 30° W 45.90'  
Nail & K.C. remon. tag on N side 12" twin Elm S 07° W 46.21'  
Nail & K.C. remon. tag on SE side 4" Elm N 30° E 6.68'  
C/L of bit. road running E-W, North 45' ±

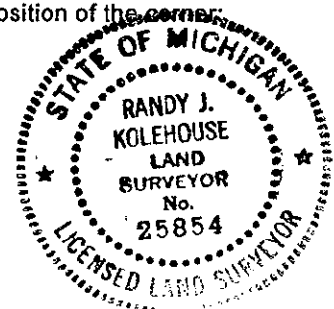

Signed by Randy J. Kolehouse  
WILLIAMS & WORKS

Date 9-27-99

Surveyor's Michigan License No. 25854