

MAY 22 2000

\$7.00
\$2.00

SECTION

LAND CORNER RECORDATION CERTIFICATE
Filing Requirement of Act 74, Mich. P.A. 1970
KENT COUNTY REMONUMENTATION

For corners in

| Kent (County) | Located in: Courtland Township | Corner Code # |
|---------------------------------------|-----------------------------------|---------------|
| 1. Public Land Survey | T <u>9N</u> R <u>10W</u> | <u>B-7</u> |
| | T _____ R _____ | _____ |
| | T _____ R _____ | _____ |
| | T _____ R _____ | _____ |
| 2. Property Controlling in Section | S _____ T _____ R _____ | _____ |
| | S _____ T _____ R _____ | _____ |
| 3. Miscellaneous Property in Sec. | S _____ T _____ R _____ | _____ |
| | S _____ T _____ R _____ | _____ |
| 4. Lot No. _____, Recorded Plat _____ | | |
| 5. Private Claims _____ | | |

STATE OF MICHIGAN
COUNTY OF KENT
RECEIVED FOR RECORD
1999 OCT 15 AM 8:03
REG. OF DEEDS

11272

Register of Deeds Stamp & File Number

I, Randy Kolehouse, in a field survey on January 29 19 99, do hereby certify that under requirements of P.A. 74 Michigan P.A. of 1970, the corner points mentioned in lines 1 and 2 above were in conformance with regulations and rules therefore as required in the current manual of survey instructions of the United States Department of the Interior, Bureau of Land Management or by a decree of a Court of Law and/or that the corner points mentioned in lines 3, 4 and 5 above were in conformance with the rules of the Michigan Board of Land Surveyors or by a Decree of a Court of Law; established, re-established, monumented, re-monumented, recovered, found as expressed below:

NOTE: Not more than 4 corners, all in the same town and range, may be recorded on this certificate.

A. Description of original monument and accessories and/or subsequent restoration:

| B-7 | 1837 | G.L.O. Notes | Cathcart | Set Post |
|-----|------|----------------|--------------------|-----------------------------------|
| | N/A | Witness Map | K.C. Surveyor | Stone & Iron |
| | 1972 | L.C.R.C. #222 | Williams & Works | Iron |
| | 1982 | L.C.R.C. #2988 | Jonker Land Survey | Fnd. "T" Iron / Set K.C. Monument |
| | 1988 | L.C.R.C. #4795 | Olson, Meyer & May | K.C. Monument |

P.A. 345 1950 KENT COUNTY

PEER APPROVED 12/25/99
CHAIRMAN [Signature]

This corner was originally approved by the Kent County Remonumentation Peer Group and monumented by Rob Jonker on 7/8/82 and was recorded per L.C.R.C. #2988.

B. Description of corner evidence found and/or method applied in restoring or reestablishing corner:

B-7 Found a Standard Kent County Monument 1.0' North of the C/L of 13 Mile Road (bit.) running East and West, on line of a tree and brush row running South, per L.C.R.C.'s #2988 and #4795 as set by Rob Jonker in place of a "T" iron he found at grade and surrounded by pieces of broken stones which checked L.C.R.C. #222 and the K.C. Surveyor's records.

L.C.R.C. #2988

L.C.R.C. #4795

MSHD tag on NE side p. pole N50°W 94.50'
MSHD tag on E side 9" Sass, S0°E 43.62'
NW cor. block hse. Fnd. S20°E 95.90'
NE cor. garage fnd. S50°E 157.98'
C/L E-W pvt., 1' S
On C/L brush row to S.

MSHD tag & nail on NE sde P pole N 50 W 94.50' (m. 94.47')
Top C/L M.B.T. box N 75 E 115.47' (115.9')
Remon tag & nail on E sde 11" Sass. S 0 E 43.62' (m. 43.58")
NW cor block hse fndn S 20 E 95.90' (m. 95.97')
NE cor garage fndn S 50 E 157.98' (m. 158.00')
C/L E-W pvt., 1' S
On C/L brush row to S

The selected location is accepted by me and is generally accepted by professional surveyors as the best available evidence of the position of the original corner.

C. Description of monument for corner and accessories established to perpetuate locating the position of the corner:

B-7 Standard Kent County Monument

Nail & K.C. remon. tag on NE side P. pole N 50° E 94.47'
Nail & K.C. remon. tag on E side 13" Sass. S 0° E 43.58'
NW cor. garage fndn. S 50° E 158.00'
NE cor. block hse. fndn. S 20° E 95.97'
C/L of bit. road running E-W, South 1.0'
On tree and brush row running S

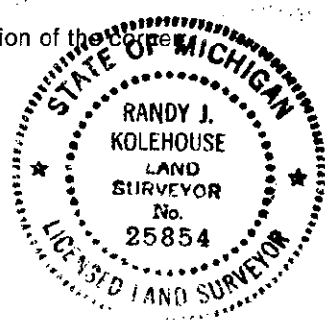

Signed by [Signature]
EARTH TECH

Date 3/30/99

Surveyor's Michigan License No. 25854