

JAN 24 1996

KENT COUNTY REMONUMENTATION

COMMISSION

LAND CORNER RECORDATION CERTIFICATE

Filing Requirement of Act 74, Mich. P.A. 1970

\$7.00
\$2.00

For corners in
KENT COUNTY
(County)

Located In:

Corner Code #

1. Public-Land Survey	T	9N	R	10W	J-12
	T		R		
	T		R		
	T		R		
2. Property Controlling in Section	S		T	R	
	S		T	R	
3. Miscellaneous Property in Section	S		T	R	
	S		T	R	

REG. OF DEEDS

Lucy Stand

95 DEC 20 AM 8:36

STATE OF MICHIGAN
COUNTY OF KENT
RECEIVED FOR RECORD

8760

Register of Deeds Stamp & File Number

4. Lot No. _____, Recorded Plat _____
5. Private Claims _____

A	B	C	D	E	F	G	H	I	J	K	L	M
2	6	5	4	3	2	1						
3												
4	7	8	9	10	11	12						
5												
6	18	17	16	15	14	13						
7												
8	19	20	21	22	23	24						
9												
10	30	29	28	27	26	25						
11												
12	31	32	33	34	35	36						
13												

I, Kirk Breitels, in a field survey on Oct. 30, 1995,

do hereby certify that under requirements of P.A. 74, Michigan P.A. of 1970, the corner points mentioned in lines 1 and 2 above were in conformance with regulations and rules therefore as required in the current manual of survey instructions of the United States Department of the Interior, Bureau of Land Management or by a decree of a Court of Law and/or that the corner points mentioned in lines 3, 4 and 5 above were in conformance with the rules of the Michigan Board of Professional Surveyors or by a Decree of a Court of Law; established, re-established, monumented, re-monumented, recovered, found as expressed below:

NOTE: Not more than 4 corners, all in the same town and range, may be recorded on this certificate.

A. Description of original monument and accessories and/or subsequent restoration:

- J-12 1837 GLO Not Set
- 1983 LCRC #3190 Bonnema Found 1/2" Iron
- 10" Hickory S60°W 39.84' 18" Oak N60°W 37.69'
- 24" Oak N30°W 29.74' 6" Elm N60°E 67.18'
- P. Pole North 61.03'

No other recorded information for this corner

P.A. 345 1990 KENT COUNTY

PEER APPROVED 11/30/95

CHAIRMAN *Harry Hubert*

B. Description of corner evidence found and/or method applied in restoring or reestablishing corner:

J-12 Found 1/2" x 18" Iron Pipe per all witnesses from LCRC #3190. Said Iron is 13.3' W. & 1.9' S. of "X" 1/4 lines and has been used in surveys by Donker, Glaza, Exxel, & Roosien. Said Iron is opposite fence lines to North and South. 1/8 line fence to West is 2' West of computed 1/8 line using said 1/2" Iron Pipe.

The 1/2" Iron is accepted by me and is generally accepted by professional surveyors as the best available evidence of the position of the corner.

C. Description of monument for corner and accessories established to perpetuate locating the position of the corner:

- J-12 Set Standard Kent County Monument in place of the 1/2" Iron
- Set Nail & KC Remon. tag NW side 12" Oak S60°W 39.73'
- Set Nail & KC Remon. tag S. side 27" Oak N60°W 37.91'
- Set Nail & KC Remon. tag W. side 36" Oak N30°W 29.30'
- PK Nail E. side Power Pole N00°E 61.01'
- Capped Rerod (Roosien) S00°W 33.00'
- Set Nail & KC Remon. tag NW side 12" Maple S45°W 67.51'

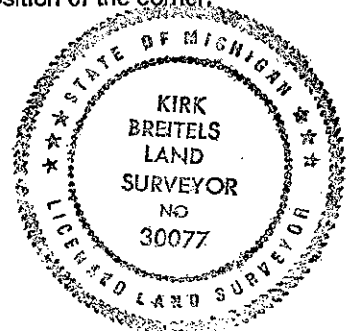

Signed by *Kirk Breitels*

Date 12/4/95

Surveyor's Michigan License No. 30077