

CURTIS REMONUMENTATION

\$7.00
\$2.00

MAR 08 1999

KENT COUNTY REMONUMENTATION

LAND CORNER RECORDATION CERTIFICATE Filing Requirement of Act 74, Mich. P.A. 1970

STATE OF MICHIGAN
COUNTY OF KENT
RECEIVED FOR RECORD
98 MAR -5 AM 8:31
REG. OF DEEDS
W. J. Rosema

10504
Register of Deeds Stamp & File Number

For corners in

KENT COUNTY
(County)

Located In:

Corner Code #

- 1. Public Land Survey T 9N R 12W M-10-
- T R common with
- T 9N R 11W A-10
- T R _____
- 2. Property Controlling S T R _____
- in Section S T R _____
- 3. Miscellaneous S T R _____
- Property in Sec. S T R _____

- 4. Lot No. _____, Recorded Plat _____
- 5. Private Claims _____

I, Kirk Breitels, in a field survey on Jan. 5, 1998 do hereby state that under requirements of P.A. 74, Michigan P.A. of 1970, the corner points mentioned in lines 1 and 2 above were in conformance with regulations and rules therefore as required in the current manual of survey instructions of the United States Department of the Interior, Bureau of Land Management or by a decree of a Court of Law and /or that the corner points mentioned in lines 3, 4 and 5 above were in conformance with the rules of the Michigan Board of Land Surveyors or by a Decree of a Court of Law, established, re-established, monumented, recovered, found as expressed below:

NOTE: Not more than 2 corners, all in the same town and range, may be recorded on this certificate.

	A	B	C	D	E	F	G	H	I	J	K	L	M
1													
2	6		5		4		3		2		1		
3													
4	7		8		9		10		11		12		
5													
6	10		17		16		15		14		13		
7													
8	19		20		21		22		23		24		
9													
10	30		29		28		27		26		25		
11													
12	31		32		33		34		35		36		
13													

A. Description of original monument and accessories and/or subsequent restoration:

M-10 1837	GLO	Brookfield	Set Post
1962	Kent Co. Wits		Concrete Monument
1965	Williams & Works		Concrete Monument
1984	LCRC #4025	Rosema	Set Kent County Monument
1995	LCRC #8337	Breitels	Kent County Monument

P.A. 315 1900 KENT COUNTY
PEER APPROVED 2/19/98
CHAIRMAN *W. J. Rosema*

The position of this corner was previously approved by the Kent County Remonumentation Peer Group, monumented by Maurice J. Rosema on 11-20-84 and was recorded per LCRC#4025.

B. Description of corner evidence found and/or method applied in restoring or reestablishing corner:

M-10 Found Kent County Monument (Harrison) per witnesses from above LCRC as set by Maurice J. Rosema in place of the 3/4" Iron he found over a Concrete Monument. Said Iron over Conc. Mon. checks with Kent Co. Wits. and Williams & Works information.

LCRC #4025		LCRC #8337	
Nail & Remon. tag 12" Ash	N85°W 46.13'	Nail & Remon. tag 20" Ash	N85°W 46.15'
Nail & Remon. tag 12" Ash	N30°W 64.29'	Nail & Remon. tag 20" Ash	N30°W 64.28'
Nail & Remon. tag 10" Ash	N50°E 75.70'	Nail & Remon. tag 18" Ash	N50°E 75.72'
Nail & Remon. tag dbl. 15" Maple	S39°E 103.32'	Nail & Remon. tag dbl. 20" Maple	S39°E 103.23'
Nail & Remon. tag 15" Ash	S60°W 52.80'	Nail & Remon. tag 22" Ash	S60°W 52.76'

The selected location is accepted by me and is generally accepted by professional surveyors as the best available evidence of the position of the original corner.

C. Description of monument for corner and accessories established to perpetuate locating the position of the corner:

M-10 Standard Kent County Monument		N85°W	46.15'
Nail & KC Remon. tag N. side 20" Ash		N30°W	64.28'
Nail & KC Remon. tag SW side 20" Ash		N50°E	75.72'
Nail & KC Remon. tag SE side 18" Ash		S39°E	103.23'
Nail & KC Remon. tag SW side dbl. 20" Maple		S60°W	52.76'
Nail & KC Remon. tag SE side 22" Ash			
On C/L N-S blacktop road			
C/L blacktop road to East is South 4'			

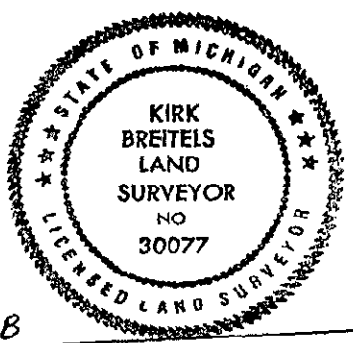

Signed by *Kirk Breitels*
Surveyor's Michigan License No. 30077

Date 2/19/98