

FEB 14 1997

**KENT COUNTY REMONUMENTATION**

**COMMISSION LAND CORNER RECORDATION CERTIFICATE**  
 Filing Requirement of Act 74, Mich. P.A. 1970

For corners in  
**KENT COUNTY**  
 (County)

Located In:	Corner Code #
T 9N R 11W	B-13
T R	
T R	
T R	
T R	
S T R	
S T R	
S T R	
S T R	

- 1. Public Land Survey
- 2. Property Controlling in Section
- 3. Miscellaneous Property in Sec.

- 4. Lot No. \_\_\_\_\_, Recorded Plat \_\_\_\_\_
- 5. Private Claims \_\_\_\_\_

I, Kirk Breitels, in a field survey on Jan. 25, 1996 do hereby state that under requirements of P.A. 74, Michigan P.A. of 1970, the corner points mentioned in lines 1 and 2 above were in conformance with regulations and rules therefore as required in the current manual of survey instructions of the United States Department of the Interior, Bureau of Land Management or by a decree of a Court of Law and /or that the corner points mentioned in lines 3, 4 and 5 above were in conformance with the rules of the Michigan Board of Land Surveyors or by a Decree of a Court of Law; established, re-established, monumented, recovered, found as expressed below:

**NOTE:** Not more than 2 corners, all in the same town and range, may be recorded on this certificate.

**A. Description of original monument and accessories and/or subsequent restoration:**

B-13	1837	GLO	Brookfield	Set Post
	1954	Kent Co. Wit.		Iron
	1888-1959	Williams & Works		Stone-Stake-Mon. Box
	1984	LCRC #4030	Byl	Set Kent County Monument in Mon. Box
	1990	LCRC #5638	Marschall	Kent County Monument

P.A. 345 1990 KENT COUNTY

PEER APPROVED 3/7/96  
 CHAIRMAN Harry Stupice

The position of this corner was previously approved by the Kent County Remonumentation Peer Group, monumented by William R. Byl on 11/7/84 and was recorded per LCRC #4030.

**B. Description of corner evidence found and/or method applied in restoring or reestablishing corner:**

B-13 Found standard Kent Co. Mon. (Harrison) per witnesses from above LCRC as set by William R. Byl in place of the 1" Iron Pipe he found. Said Iron Pipe checks with Williams & Works and Kent Co. Wit.

LCRC #4030	LCRC #5638
Nail/tag MBT Pole S55°E 59.58'	Nail/tag P. Pole N02°W 47.54' 1/4 cor.
Nail/tag CP Pole N05°W 47.63'	Nail/tag CATV Pole S54°E 59.56' B-1, 8-11
NW cor. Hse. #340 S20°E 124.18'	"X" top 24" culv. S66°W 92.36' East 400.46'
"X" top 24" culv. S65°W 92.34'	C/L top bolt tower leg S40°W 105.72'
"X" top 24" culv. N55°W 95.00'	PK in P. Pole S08°E 125.04'

The selected location is accepted by me and is generally accepted by professional surveyors as the best available evidence of the position of the original corner.

**C. Description of monument for corner and accessories established to perpetuate locating the position of the corner:**

B-13 Standard Kent County Monument

Nail & KC Remon. tag W. side P. Pole	N02°W 47.66' (leaning North)
Nail & KC Remon. tag NE side CATV Pole	S54°E 59.59'
"X" cut top S. end 24" conc. culv.	S66°W 92.39'
PK Nail in W. side P. Pole	S08°E 125.08'
C/L top bolt at base E. side NE leg of tower	S40°W 105.76'
Kent Co. Mon. (B-1, T8N, R11)	East 400.46'
C/L E-W bit. road is North 1'±	

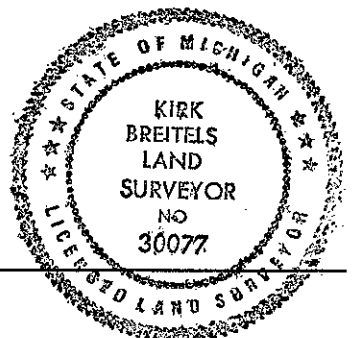

Signed by Kirk Breitels  
 Surveyor's Michigan License No. 30077

Date 3/1/96

STATE OF MICHIGAN  
 COUNTY OF KENT  
 RECEIVED FOR RECORD  
 96 MAR 20 AM 9:00  
 REG. OF DEEDS  
*Lucy Bond*  
**9130**  
 Register of Deeds Stamp & File Number

	A	B	C	D	E	F	G	H	I	J	K	L	M
1													
2	6		5		4		3		2		1		
3													
4	7		8		9		10		11		12		
5													
6	18		17		16		15		14		13		
7													
8	19		20		21		22		23		24		
9													
10	30		29		28		27		26		25		
11													
12	31		32		33		34		35		36		
13													