

\$7.00
\$2.00

SURVEY & REMONUMENTATION

MAR 08 1999

KENT COUNTY REMONUMENTATION

LAND CORNER RECORDATION CERTIFICATE
Filing Requirement of Act 74, Mich. P.A. 1970

STATE OF MICHIGAN
COUNTY OF KENT
RECEIVED FOR RECORD
98 MAY 21 AM 8:31
REG. OF DEEDS
David Bond

For corners in

SECTION

KENT COUNTY
(County)

Located in:

Corner Code #

1. Public Land Survey

T 9N	R 11W	D-3
T	R	
T	R	
T	R	
T	R	
S	T	R
S	T	R
S	T	R
S	T	R

2. Property Controlling in Section

3. Miscellaneous Property in Sec.

4. Lot No. _____, Recorded Plat _____
5. Private Claims _____

10602

Register of Deeds Stamp & File Number

I, Kirk Breiteles, in a field survey on April 22, 1998 do hereby state that under requirements of P.A. 74, Michigan P.A. of 1970, the corner points mentioned in lines 1 and 2 above were in conformance with regulations and rules therefore as required in the current manual of survey instructions of the United States Department of the Interior, Bureau of Land Management or by a decree of a Court of Law and/or that the corner points mentioned in lines 3, 4 and 5 above were in conformance with the rules of the Michigan Board of Land Surveyors or by a Decree of a Court of Law; established, re-established, monumented, recovered, found as expressed below.

NOTE: Not more than 2 corners, all in the same town and range, may be recorded on this certificate.

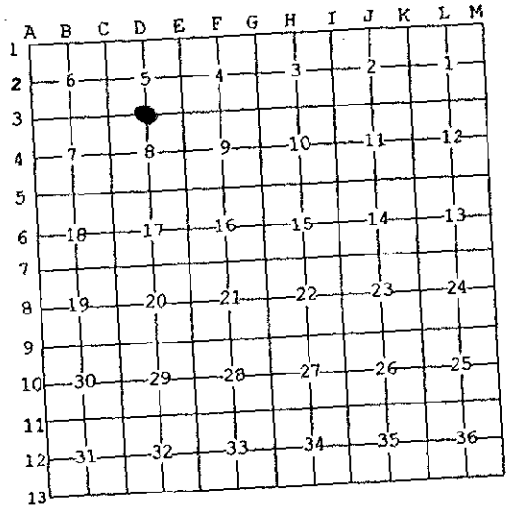

A. Description of original monument and accessories and/or subsequent restoration:

D-3	1837 GLO	Whitcomb	Set Post
	1959 Kent Co. Wits		1" Iron
	1981 LCRC #1627	Byl	Mon. Box
	1982 LCRC #2911	Jonker	Set Kent County Monument in Mon. Box
	1990 LCRC #5653	Marschall	Kent County Monument

P.A. 345 1990 KENT COUNTY

PEER APPROVED 4/30/98

CHAIRMAN *Harry Hubert*

The position of this corner was previously approved by the Kent County Remonumentation Peer Group, monumented by Robert J. Jonker on 6-3-82 and was recorded per LCRC #2911.

B. Description of corner evidence found and/or method applied in restoring or reestablishing corner:

D-3 Found Kent County Monument (Harrison) per witnesses from above LCRC as set by Robert J. Jonker in place of the 1" Iron over a 3/4" Iron he found inside a Mon. Box. Both Irons check with Kent Co. Wit. and LCRC #1627.
LCRC #2911

Nail & Remon. tag 18" Willow	N30°E 100.61'	Nail & Remon. tag P. Pole	S23°W 60.37'
Nail & Remon. tag 8" Apple	N80°W 58.09'	SW corner garage foundation	N73°W 208.95'
SW corner barn foundation	N90°E 325.6'	SW corner garage foundation	S31°E 204.31'
NW corner hse. foundation	S45°E 148.13'	NE corner conc. hse. foundation	S52°E 169.62'
SW corner hse. foundation	N70°E 157.1'		

C/L N-S pavement is 0.5' West
The selected location is accepted by me and is generally accepted by professional surveyors as the best available evidence of the position of the original corner.

C. Description of monument for corner and accessories established to perpetuate locating the position of the corner:

D-3 Standard Kent County Monument in Mon. Box	
Nail & KC Remon. tag in side P. Pole	S23°W 60.37'
SW corner garage foundation	N73°W 208.70'
SW corner garage foundation	S31°E 204.31'
NE corner house foundation	S52°E 169.62'

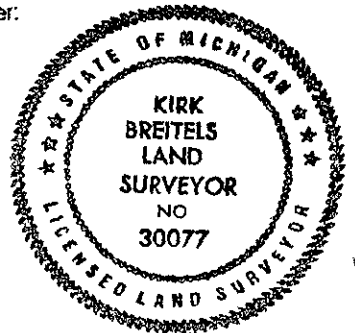

Signed by *Kirk Breiteles*
Surveyor's Michigan License No. 30077

Date 4/30/98