

FEB 14 1997

COMMISSION

KENT COUNTY REMONUMENTATION

LAND CORNER RECORDATION CERTIFICATE
Filing Requirement of Act 74, Mich. P.A. 1970

For corners in

KENT COUNTY

(County)

Located In:

Corner Code #

- 1. Public Land Survey T 9N R 11W D-13
T R
T R
T R
- 2. Property Controlling in Section S T R
S T R
- 3. Miscellaneous Property in Sec. S T R
S T R

STATE OF MICHIGAN
COUNTY OF KENT
RECEIVED FOR RECORD

96 MAR 20 AM 9:00

REG. OF DEEDS
Lucy Steward

9132
Register of Deeds Stamp & File Number

- 4. Lot No. _____, Recorded Plat _____
- 5. Private Claims _____

I, Kirk Breitels, in a field survey on Jan. 25, 19 96 do hereby state that under requirements of P.A. 74, Michigan P.A. of 1970, the corner points mentioned in lines 1 and 2 above were in conformance with regulations and rules therefore as required in the current manual of survey instructions of the United States Department of the Interior, Bureau of Land Management or by a decree of a Court of Law and /or that the corner points mentioned in lines 3, 4 and 5 above were in conformance with the rules of the Michigan Board of Land Surveyors or by a Decree of a Court of Law; established, re-established, monumented, recovered, found as expressed below:

NOTE: Not more than 2 corners, all in the same town and range, may be recorded on this certificate.

A	B	C	D	E	F	G	H	I	J	K	L	M
1												
2	6		5		4		3		2		1	
3												
4	7		8		9		10		11		12	
5												
6	18		17		16		15		14		13	
7												
8	19		20		21		22		23		24	
9												
10	30		29		28		27		26		25	
11												
12	31		32		33		34		35		36	
13												

A. Description of original monument and accessories and/or subsequent restoration:

D-13	1837	GLO	Brookfield	Set Post	P.A. 345 1990 KENT COUNTY,
	1944	Kent Co. Wit.		Mon. Box	PEER APPROVED <u>3/7/96</u>
	1973	LCRC #462	Spicer	Mon. Box	CHAIRMAN <i>Harry Huber</i>
	1981	LCRC #1730	Merdzinski	Set Kent County Monument	
	1990	LCRC #5658	Marschall	Kent County Monument	

The position of this corner was previously approved by the Kent County Remonumentation Peer Group, monumented by John A. Merdzinski on 1/7/81 and was recorded per LCRC #1730

B. Description of corner evidence found and/or method applied in restoring or reestablishing corner:

D-13 Found standard Kent Co. Mon. (Harrison) per witnesses from above LCRC as set by John A. Merdzinski in place of the Iron Pipe he found inside a Mon. Box. Said Iron checks with Kent Co. Wit. and LCRC #462.

<u>LCRC #1730</u>		<u>LCRC #5658</u>	
Nail/tag 12" Ash	N40°E 67.31'	Nail/tag 14" Ash	N42°E 67.27'
Nail/tag 12" Elm	N00°W 42.88'	E. cor. rock	S20°E 52.34'
Nail/tag 10" Willow	S60°W 45.30'	NW cor. frame hse.	S02°W 113.83'
Nail/tag 10" Poplar	S55°E 41.19'	NE cor. frame hse.	S34°E 125.40'
		D-1, T8N, R11W	East 428.93'

The selected location is accepted by me and is generally accepted by professional surveyors as the best available evidence of the position of the original corner.

C. Description of monument for corner and accessories established to perpetuate locating the position of the corner:

D-13 Standard Kent County Monument	
New Nail & KC Remon. tag SE side 16" Ash	N42°E 67.31'
E. corner 3' dia. rock 1' above ground	S20°E 52.34'
NW corner frame house	S02°W 113.83'
NE corner frame house	S34°E 125.40'
Set Nail & KC Remon. tag SW side 16" Elm	N60°W 79.62'
Kent Co. Mon. (D-1, T8N, R11W)	East 428.92'
On C/L E-W bit. road	

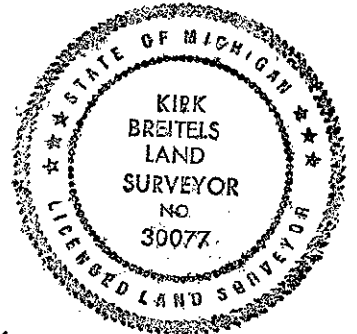

Signed by *Kirk Breitels*
Surveyor's Michigan License No. 30077

Date 3/1/96