

MAR 08 1999

KENT COUNTY REMONUMENTATION

SECTION

LAND CORNER RECORDATION CERTIFICATE
Filing Requirement of Act 74, Mich. P.A. 1970

For corners in

KENT COUNTY

(County)

Located In:

Corner Code #

1. Public Land Survey	T 9N R 11W	G-12
	T R	
	T R	
	T R	
2. Property Controlling in Section	S T R	
	S T R	
3. Miscellaneous Property in Sec.	S T R	
	S T R	

STATE OF MICHIGAN
COUNTY OF KENT
RECEIVED FOR RECORD
38 OCT -7 AM 10:15
REG. OF DEEDS
Lucy Staud

10673

Register of Deeds Stamp & File Number

4. Lot No. _____, Recorded Plat _____
5. Private Claims _____

I, Kirk Breitels, in a field survey on Sept. 9, 1998 do hereby state that under requirements of P.A. 74, Michigan P.A. of 1970, the corner points mentioned in lines 1 and 2 above were in conformance with regulations and rules therefore as required in the current manual of survey instructions of the United States Department of the Interior, Bureau of Land Management or by a decree of a Court of Law and /or that the corner points mentioned in lines 3, 4 and 5 above were in conformance with the rules of the Michigan Board of Land Surveyors or by a Decree of a Court of Law; established, re-established, monumented, recovered, found as expressed below:

NOTE: Not more than 2 corners, all in the same town and range, may be recorded on this certificate.

	A	B	C	D	E	F	G	H	I	J	K	L	M
1													
2	6		5		4		3		2			1	
3													
4	7		8		9		10		11			12	
5													
6	18		17		16		15		14			13	
7													
8	19		20		21		22		23			24	
9													
10	30		29		28		27		26			25	
11													
12	31		32		33		34		35			36	
13													

A. Description of original monument and accessories and/or subsequent restoration:

G-12 1837	GLO	Whitcomb	Set Post
	Kent Co. Wits		Iron
1973	LCRC #521	Spicer	1" Iron in Mon. Box
1978	LCRC #1240	Shangraw	Iron in Mon. Box
1982	LCRC #2522	Starr	Set Kent County Monument in Mon. Box
1990	LCRC #5690	Marschall	Kent County Monument

P.A. 345 1990 KENT COUNTY
PEER APPROVED 9/24/98
CHAIRMAN Harry Huber

The position of this corner was previously approved by the Kent County Remonumentation Peer Group, monumented by Thomas C. Starr on 1-5-82 and was recorded per LCRC #2522.

B. Description of corner evidence found and/or method applied in restoring or reestablishing corner:

G-12 Found Kent County Monument (Harrison) per witnesses from above LCRC as set by Thomas C. Starr in place of the 3/4" Iron Pipe he found inside a Mon. Box. Said Iron checks with Kent Co. Wits. and LCRC's #521 & 1240.
LCRC #2522
LCRC #5690

Nail & Remon. tag 10" Oak West 33.90'	Nail & Remon. tag 10" Oak West 33.86'
Nail & Remon. tag 18" Oak N75°W 50.71'	Nail & Remon. tag 22" Oak N78°W 50.59'
Nail & Remon. tag 20" Oak N50°W 53.21'	Nail & Remon. tag 26" Oak N60°W 53.10'
Nail & Remon. tag 26" Oak N30°E 57.22'	Nail & Remon. tag 32" Oak N25°E 57.08'
Nail & Remon. tag 10" Oak S20°E 92.41'	Nail & Remon. tag 12" Oak S27°E 92.28'
C/L 4" Ch. Elm S35°W 78.1'	NE face of 3' x 4' rock S26°W 95.51'

The selected location is accepted by me and is generally accepted by professional surveyors as the best available evidence of the position of the original corner.

C. Description of monument for corner and accessories established to perpetuate locating the position of the corner:

G-12 Standard Kent County Monument in Mon. Box

Nail & KC Remon. tag N. side 12" Oak	West 33.88'
Nail & KC Remon. tag S. side 24" Oak	N78°W 50.56'
Nail & KC Remon. tag S. side 28" Oak	N60°W 53.12'
Nail & KC Remon. tag W. side 36" Oak	N25°E 57.20'
Nail & KC Remon. tag W. side 14" Oak	S27°E 92.35'
NE face of 3' x 4' rock	S26°W 95.5' ±

On C/L N-S asphalt road

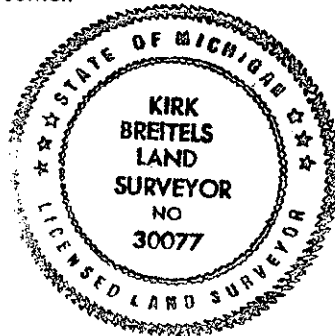

Signed by *Kirk Breitels*
Surveyor's Michigan License No. 30077

Date 9/24/98