

SURVEY & REMONUMENTATION

FEB 14 1997

KENT COUNTY REMONUMENTATION

COMMISSION

LAND CORNER RECORDATION CERTIFICATE
Filing Requirement of Act 74, Mich. P.A. 1970

STATE OF MICHIGAN
COUNTY OF KENT
RECEIVED FOR RECORD
96 MAR 20 AM 9:00
REG. OF DEEDS
Lucy Bond

For corners in
KENT COUNTY

Located In: Corner Code #

1. Public Land Survey	T 9N R 11W	G-13
	T R	
	T R	
	T R	
2. Property Controlling in Section	S T R	
	S T R	
3. Miscellaneous Property in Sec.	S T R	
	S T R	

9134

Register of Deeds Stamp & File Number

4. Lot No. _____, Recorded Plat _____
5. Private Claims _____

I, Kirk Breitels, in a field survey on Jan. 25, 1996 do hereby state that under requirements of P.A. 74, Michigan P.A. of 1970, the corner points mentioned in lines 1 and 2 above were in conformance with regulations and rules therefore as required in the current manual of survey instructions of the United States Department of the Interior, Bureau of Land Management or by a decree of a Court of Law and/or that the corner points mentioned in lines 3, 4 and 5 above were in conformance with the rules of the Michigan Board of Land Surveyors or by a Decree of a Court of Law; established, re-established, monumented, recovered, found as expressed below:

NOTE: Not more than 2 corners, all in the same town and range, may be recorded on this certificate.

A	B	C	D	E	F	G	H	I	J	K	L	M
1												
2	6		5		4		3		2		1	
3												
4	7		8		9		10		11		12	
5												
6	18		17		16		15		14		13	
7												
8	19		20		21		22		23		24	
9												
10	30		29		28		27		26		25	
11												
12	31		32		33		34		35		36	
13												

A. Description of original monument and accessories and/or subsequent restoration:

G-13	1837	GLO	Brookfield	Set Post
		Kent Co. Wit.		Mon. Box
1973	LCRC #521	Spicer		3/4" Iron in Mon. Box
1978	LCRC #1240	Shangraw		Mon. Box
1981	LCRC #1755	Merdzinski		Set Kent County Monument
1990	LCRC #5691	Marschall		Kent County Monument

P.A. 345 1990 KENT COUNTY

PEER APPROVED 3/17/96

CHAIRMAN

The position of this corner was previously approved by the Kent County Remonumentation Peer Group, monumented by John A. Merdzinski on 1/15/81 and was recorded per LCRC #1755

B. Description of corner evidence found and/or method applied in restoring or reestablishing corner:

G-13 Found standard Kent Co. Mon. (Harrison) per witnesses from above LCRC as set by John A. Merdzinski in place of the 1/2" Iron Pipe he found inside a 1 1/4" Iron Pipe inside a Mon. Box. Said Iron Pipe checks with Kent Co. Wit. and LCRC's #521 & #1240.
LCRC #1755 LCRC #5691

Nail/tag T & P Pole	S00°E 121.52'	Nail/tag P. Pole	South 121.17'
Nail/tag Fc. Post	S40°E 127.62'	Top S. Cor. ROW Marker	N20°W 97.28'
Nail/tag curb joint	N30°E 49.62'	Top S. Cor. ROW Marker	N16°E 121.50'
Nail/tag curb joint	N25°W 52.58'	2" Angle Iron Fc. Post	N50°E 117.40'
Top S. cor. ROW Marker	N20°E 121.45'	G-1, T8N, R11W	East 338.65'

The selected location is accepted by me and is generally accepted by professional surveyors as the best available evidence of the position of the original corner.

C. Description of monument for corner and accessories established to perpetuate locating the position of the corner:

G-13 Standard Kent County Monument			
Nail & KC Remon. tag E. side P. Pole	S00°W	121.17'	
Top of South corner on conc. ROW Marker	N20°W	97.28'	
Top of South corner on conc. ROW Marker	N16°E	121.50'	
2" Angle Iron Fence Corner Post	N50°E	117.40'	
Kent Co. Mon. (G-1, T8N, R11W)	East	338.70'	

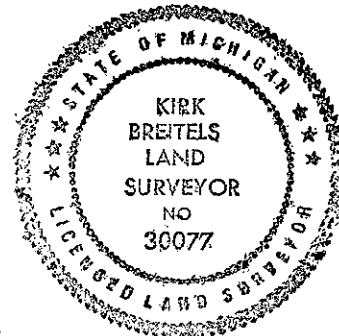

Signed by *Kirk Breitels*
Surveyor's Michigan License No. 30077

Date 3/1/96