

\$7.00
\$2.00

MAR 08 1999

KENT COUNTY REMONUMENTATION

LAND CORNER RECORDATION CERTIFICATE
Filing Requirement of Act 74, Mich. P.A. 1970

SECTION

For corners in

KENT COUNTY
(County)

Located In:

Corner Code #

- 1. Public Land Survey T 9N R 11W H-3
- T R _____
- T R _____
- T R _____
- 2. Property Controlling S T R _____
- in Section S T R _____
- 3. Miscellaneous S T R _____
- Property in Sec. S T R _____

STATE OF MICHIGAN
COUNTY OF KENT
RECEIVED FOR RECORD
98 MAY 21 AM 8:31
REG. OF DEEDS
Lucy S. ...

10612

Register of Deeds Stamp & File Number

- 4. Lot No. _____, Recorded Plat _____
- 5. Private Claims _____

I, Kirk Breitels, in a field survey on April 21, 19 98 do hereby state that under requirements of P.A. 74, Michigan P.A. of 1970, the corner points mentioned in lines 1 and 2 above were in conformance with regulations and rules therefore as required in the current manual of survey instructions of the United States Department of the Interior, Bureau of Land Management or by a decree of a Court of Law and /or that the corner points mentioned in lines 3, 4 and 5 above were in conformance with the rules of the Michigan Board of Land Surveyors or by a Decree of a Court of Law; established, re-established, monumented, recovered, found as expressed below:

NOTE: Not more than 2 corners, all in the same town and range, may be recorded on this certificate.

	A	B	C	D	E	F	G	H	I	J	K	L	M
1													
2		6		5		4		3		2		1	
3								●					
4		7		8		9		10		11		12	
5													
6		18		17		16		15		14		13	
7													
8		19		20		21		22		23		24	
9													
10		30		29		28		27		26		25	
11													
12		31		32		33		34		35		36	
13													

A. Description of original monument and accessories and/or subsequent restoration:

- H-3 1837 GLO Whitcomb Set Post
- Kent Co. Wits Stone - no witnesses given
- 1976 LCRC #1009 Nederveld Solid Iron
- 1980 LCRC #1338 Hackbardt 1/2" Rod
- 1982 LCRC #2510 Starr Set Kent County Monument
- 1994 LCRC #7017 Byl Kent County Monument

P.A. 345 1990 KENT COUNTY
PEER APPROVED 4/30/98
CHAIRMAN *Harry Fisher*

The position of this corner was previously approved by the Kent County Remonumentation Peer Group, monumented by Thomas C. Starr on 1-5-82 and was recorded per LCRC #2510.

B. Description of corner evidence found and/or method applied in restoring or reestablishing corner:

- H-3 Found BROKEN (24" below grade) Kent Co. Mon. (Harrison) per wit. from above LCRC as set by Thomas C. Starr in place of the 1/2" Solid Rod he found. Solid Rod checks with LCRC's #1009 & #1338. Reset Kent County Monument LCRC #2510 LCRC #7017
- Nail & Remon. tag 24" Cherry N55°E 46.82' Nail & Remon. tag 28" Cherry N55°E 46.82'
- Nail & Remon. tag Tw. 8" Sass. N80°E 93.60' Nail & Remon. tag Tw. 12" Sass. N80°E 93.68'
- Nail & Remon. tag P. Pole S30°E 93.97' Nail & Remon. tag P. Pole S30°E 93.97'
- Nail & Remon. tag 12" Oak S70°W 45.95' Nail & Remon. tag 16" Oak S70°W 45.77'
- Nail & Remon. tag 24" Oak N75°W 116.85' Nail & Remon. tag 28" Oak N75°W 116.85'
- Nail & Remon. tag P. Pole North 54.61' Nail & Remon. tag P. Pole N00°E 54.54'

The selected location is accepted by me and is generally accepted by professional surveyors as the best available evidence of the position of the original corner.

C. Description of monument for corner and accessories established to perpetuate locating the position of the corner:

- H-3 Standard Kent County Monument
- Nail & KC Remon. tag SE side 28" Cherry N55°E 46.82'
- Nail & KC Remon. tag S. side Tw. 12" Sassafras N80°E 93.59'
- Nail & KC Remon. tag NE side P. Pole S30°E 93.97'
- Nail & KC Remon. tag NW side 16" Oak S70°W 45.99'
- Nail & KC Remon. tag S. side 28" Oak N75°W 116.74'
- Nail & KC Remon. tag E. side P. Pole N00°E 54.52'
- On C/L blacktop road E-W ± and on tree row South ±.

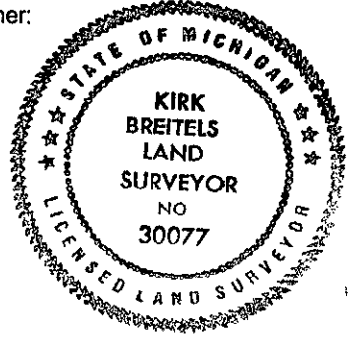

Signed by *Kirk Breitels*
Surveyor's Michigan License No. 30077

Date 4/30/98