

MAR 08 1999

KENT COUNTY REMONUMENTATION

\$7.00
\$2.00

SECTION

LAND CORNER RECORDATION CERTIFICATE
Filing Requirement of Act 74, Mich. P.A. 1970

For corners in
KENT COUNTY
(County)

Located In: Corner Code #

- | | | |
|------------------------------------|--------------------------|------------|
| 1. Public Land Survey | T <u>9N</u> R <u>11W</u> | <u>H-6</u> |
| | T _____ R _____ | _____ |
| | T _____ R _____ | _____ |
| | T _____ R _____ | _____ |
| 2. Property Controlling in Section | S _____ T _____ R _____ | _____ |
| | S _____ T _____ R _____ | _____ |
| 3. Miscellaneous Property in Sec. | S _____ T _____ R _____ | _____ |
| | S _____ T _____ R _____ | _____ |

STATE OF MICHIGAN
COUNTY OF KENT
RECEIVED FOR RECORD

38 NOV 16 AM 8:00

REG. OF DEEDS

Eric Standa

10920

Register of Deeds Stamp & File Number

4. Lot No. _____, Recorded Plat _____
5. Private Claims _____

I, Kirk Breitels, in a field survey on Sept. 1, 1998 do hereby state that under requirements of P.A. 74, Michigan P.A. of 1970, the corner points mentioned in lines 1 and 2 above were in conformance with regulations and rules therefore as required in the current manual of survey instructions of the United States Department of the Interior, Bureau of Land Management or by a decree of a Court of Law and/or that the corner points mentioned in lines 3, 4 and 5 above were in conformance with the rules of the Michigan Board of Land Surveyors or by a Decree of a Court of Law; established, re-established, monumented, recovered, found as expressed below:

A	B	C	D	E	F	G	H	I	J	K	L	I
1												
2	6		5		4		3		2		1	
3												
4	7		8		9		10		11		12	
5												
6	18		17		16		15		14		13	
7												
8	19		20		21		22		23		24	
9												
10	30		29		28		27		26		25	
11												
12	31		32		33		34		35		36	
13												

NOTE: Not more than 2 corners, all in the same town and range, may be recorded on this certificate.

A. Description of original monument and accessories and/or subsequent restoration:

- | | |
|------------------------------|------------------------------|
| H-6 1837 GLO | Not Set |
| 1968-78 Williams & Works | Computed location |
| 1980 Williams & Works | Set Iron at True Center |
| 1980 LCRC #1358 Merdzinski | "T" Iron |
| Nail in 12" Oak N35°W 29.20' | Nail in 12" Oak N25°E 10.80' |
| Nail in 12" Oak West 3.15' | Nail in 12" Oak South 15.13' |
| Nail in 12" Oak South 25.29' | |

B. Description of corner evidence found and/or method applied in restoring or reestablishing corner:

H-6 Found Capped Rerod (All Points) - not "T" Iron - that fits remaining witnesses of LCRC #1358
 Fd. Nail NW side 14" Oak N45°E 10.85' Fd. Nail N. side 14" Oak West 3.12'
 Fd. Nail E. side 14" Oak S10°W 15.07'
 The Capped Rerod is 0.8' N. and 0.3' W. of Intersection of 1/4 lines.

HOWEVER, ALL MEASUREMENTS from any recorded surveys (Williams & Works, Nederveld, Glaza, Roosien) all compute to the Intersection of 1/4 lines.

Since all previous surveys compute to Intersection of 1/4 lines, the Intersection of 1/4 lines is accepted by me and is generally accepted by professional surveyors as the best available evidence of the position of the corner.

C. Description of monument for corner and accessories established to perpetuate locating the position of the corner:

H-6 Set Standard Kent County Monument at the Intersection of 1/4 lines.

- | | |
|--------------------------------------|--------------|
| Nail & KC Remon. tag N. side 14" Oak | S90°W 3.47' |
| Nail & KC Remon. tag E. side 14" Oak | S10°W 14.31' |
| Nail & KC Remon. tag W. side 14" Oak | S35°E 24.49' |
| Nail & KC Remon. tag NW side 14" Oak | N45°E 11.34' |
| Nail & KC Remon. tag NE side 14" Oak | N50°W 29.91' |
| Capped Rerod (All-Points) | N20°W 0.82' |
| Remains of E-W fence is North 6' ± | |

P.A. 345 1990 KENT COUNTY
 PEER APPROVED 9/24/98
 CHAIRMAN Harry Fisher

Date 11/12/98

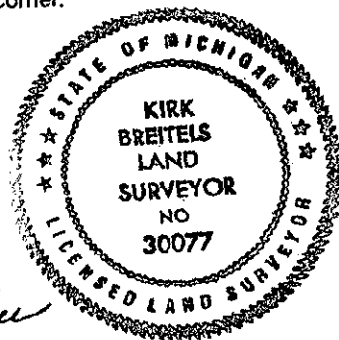

Signed by Kirk Breitels
 Surveyor's Michigan License No. 30077