

MAR 08 1999

KENT COUNTY REMONUMENTATION

SECTION

LAND CORNER RECORDATION CERTIFICATE  
Filing Requirement of Act 74, Mich. P.A. 1970

REG. OF DEEDS

*Lucy Stovall*

98 MAR -5 AM 8:33

STATE OF MICHIGAN  
COUNTY OF KENT  
RECEIVED FOR RECORD

For corners in

KENT COUNTY  
(County)

Located In:

Corner Code #

- 1. Public Land Survey      T 9N R 11W      I-1
- T      R
- T      R
- T      R
- 2. Property Controlling    S      T      R
- in Section                S      T      R
- 3. Miscellaneous            S      T      R
- Property in Sec.         S      T      R

10544

Register of Deeds Stamp & File Number

- 4. Lot No. \_\_\_\_\_, Recorded Plat \_\_\_\_\_
- 5. Private Claims \_\_\_\_\_

I, Kirk Breitels, in a field survey on Jan. 7, 19 98 do hereby state that under requirements of P.A. 74, Michigan P.A. of 1970, the corner points mentioned in lines 1 and 2 above were in conformance with regulations and rules therefore as required in the current manual of survey instructions of the United States Department of the Interior, Bureau of Land Management or by a decree of a Court of Law and /or that the corner points mentioned in lines 3, 4 and 5 above were in conformance with the rules of the Michigan Board of Land Surveyors or by a Decree of a Court of Law; established, re-established, monumented, recovered, found as expressed below:

NOTE: Not more than 2 corners, all in the same town and range, may be recorded on this certificate.

	A	B	C	D	E	F	G	H	I	J	K	L	M
1													
2	6		5		4		3		2		1		
3													
4	7		8		9		10		11		12		
5													
6	18		17		16		15		14		13		
7													
8	19		20		21		22		23		24		
9													
10	30		29		28		27		26		25		
11													
12	31		32		33		34		35		36		
13													

A. Description of original monument and accessories and/or subsequent restoration:

- I-1 1837 GLO Whitcomb Set Post 256 links (168.96') W. of I-13, T10N, R11W
- 1887 Williams & Works Set Iron Wagon Arm from Gov't. bearing tree
- 1893 Williams & Works Set Stone
- 1968 Consumers Power Used corner - no desc. of corner
- 1971 Williams & Works Iron
- 1995 LCRC #8536 Breitels Set Kent County Monument on Twp. Line

P.A. 345 1990 KENT COUNTY  
PEER APPROVED 2/19/98  
CHAIRMAN *Harry Huber*

The position of this corner was previously approved by the Kent County Remonumentation Peer Group, monumented by Kirk Breitels on 8-7-95 and was recorded per LCRC #8536.

B. Description of corner evidence found and/or method applied in restoring or reestablishing corner:

I-1 Found Kent County Monument (Harrison) per witnesses from above LCRC as set by Kirk Breitels on the Township Line in place of the 1/2" Solid Iron he found. Said Iron checks with Williams & Works and Consumers Power information. LCRC #8536

- Nail & Remon. tag 36" Maple S35°E 42.76'
- Nail & Remon. tag 10" Pine S10°E 54.76'
- Nail & Remon. tag 24" Pine S75°W 73.93'
- Nail & Remon. tag 24" Walnut N55°W 54.27'
- Nail & Remon. tag 27" Walnut N45°E 37.50'
- Kent Co. Mon. (I-13, T10N, R11W) East 168.95'

The selected location is accepted by me and is generally accepted by professional surveyors as the best available evidence of the position of the original corner.

C. Description of monument for corner and accessories established to perpetuate locating the position of the corner:

- I-1 Standard Kent County Monument
- Nail & KC Remon. tag SW side 36" Maple S35°E 42.76'
- Nail & KC Remon. tag W. side 10" Pine S10°E 54.76'
- Nail & KC Remon. tag N. side 24" Pine S75°W 73.93'
- Nail & KC Remon. tag SW side 24" Walnut N55°W 54.27'
- Nail & KC Remon. tag SE side 27" Walnut N45°E 37.50'
- Kent Co. Mon. (I-13, T10N, R11W) East 168.95'

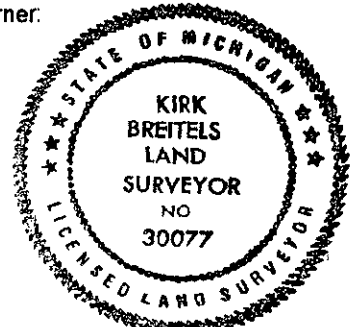

Signed by *Kirk Breitels*  
Surveyor's Michigan License No. 30077

Date 2/19/98