

\$7.00  
\$2.00

MAR 03 1999

KENT COUNTY REMONUMENTATION

SECTION

LAND CORNER RECORDATION CERTIFICATE  
Filing Requirement of Act 74, Mich. P.A. 1970

For corners in

KENT COUNTY  
(County)

Located in:

Corner Code #

- 1. Public Land Survey T 9N R 11W I-3  
T \_\_\_ R \_\_\_  
T \_\_\_ R \_\_\_  
T \_\_\_ R \_\_\_
- 2. Property Controlling in Section S \_\_\_ T \_\_\_ R \_\_\_  
S \_\_\_ T \_\_\_ R \_\_\_
- 3. Miscellaneous Property in Sec. S \_\_\_ T \_\_\_ R \_\_\_  
S \_\_\_ T \_\_\_ R \_\_\_

- 4. Lot No. \_\_\_\_\_, Recorded Plat \_\_\_\_\_
- 5. Private Claims \_\_\_\_\_

I, Kirk Breitels, in a field survey on April 21, 19 98 do hereby state that under requirements of P.A. 74, Michigan P.A. of 1970, the corner points mentioned in lines 1 and 2 above were in conformance with regulations and rules therefore as required in the current manual of survey instructions of the United States Department of the Interior, Bureau of Land Management or by a decree of a Court of Law and /or that the corner points mentioned in lines 3, 4 and 5 above were in conformance with the rules of the Michigan Board of Land Surveyors or by a Decree of a Court of Law, established, re-established, monumented, recovered, found as expressed below:

NOTE: Not more than 2 corners, all in the same town and range, may be recorded on this certificate.

A. Description of original monument and accessories and/or subsequent restoration:

I-3	1837	GLO	Whitcomb	Set Post
	1966	Kent Co. Wits		Leaded Stone & Iron
	1980	LCRC #1338	Hackbardt	1 1/4" Iron
	1981	LCRC #1620	Hackbardt	1 1/4" Iron
	1982	LCRC #2508	Starr	Set Kent County Monument
	1994	LCRC #7024	Byl	Kent County Monument

The position of this corner was previously approved by the Kent County Remonumentation Peer Group, monumented by Thomas C. Starr on 1-5-82 and was recorded per LCRC #2508.

B. Description of corner evidence found and/or method applied in restoring or reestablishing corner:

I-3 Found nothing at corner. Reset Kent Co. Mon. (Harrison) per wit. from above LCRC as set by Thomas C. Starr in place of the 3/8" Solid Rebar inside a 1" Iron Pipe he found. Both check Kent Co. Wits. and LCRC's #1338 & #1620.  
LCRC #2508 LCRC #7024

Nail & Remon. tag P. Pole	N30°W 71.32'	Nail & Remon. tag P. Pole	N30°W 71.28'
Nail & Remon. tag cor. fc. post	S50°E 42.71'	Nail & Remon. tag cor. fc. post	S50°E 41.89'
Nail & Remon. tag 8" Sassafras	S30°E 58.27'	Nail & Remon. tag 12" Sassafras	S30°E 58.16'
Nail & Remon. tag 18" Sassafras	S20°E 69.40'	Nail & Remon. tag 24" Sassafras	S20°E 69.40'
Nail & Remon. tag 12" Apple	S70°W 71.72'	Nail & Remon. tag 12" Apple	S70°W 71.46'
Top C/L Telephone Box	S40°W 46.00'	Top C/L Telephone Box	S40°W 46.00'

The selected location is accepted by me and is generally accepted by professional surveyors as the best available evidence of the position of the original corner.

C. Description of monument for corner and accessories established to perpetuate locating the position of the corner:

I-3 Standard Kent County Monument	
Nail & KC Remon. tag W. side P. Pole	N30°E 71.28'
Nail & KC Remon. tag W. side 12" Sassafras	S30°E 58.14'
Nail & KC Remon. tag W. side 24" Sassafras	S20°E 69.38'
Nail & KC Remon. tag SE side 12" Apple	S40°W 71.58'
Chiseled "X" top of W. end concrete culvert	N20°W 65.03'
On C/L N-S & E-W asphalt roads ±	

STATE OF MICHIGAN  
COUNTY OF KENT  
RECEIVED FOR RECORD  
98 MAY 21 AM 8:31  
REG. OF DEEDS  
*W. J. Bond*

10613

Register of Deeds Stamp & File Number

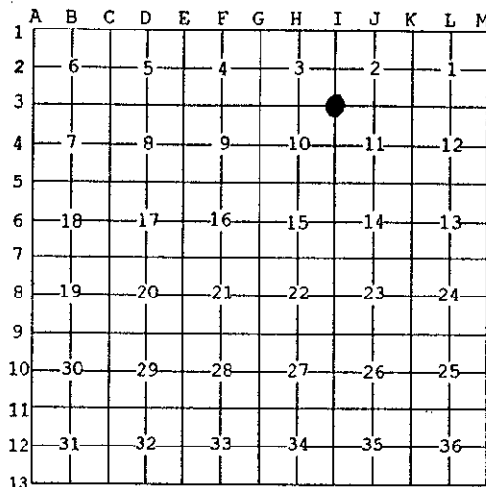

P.A. 345 1990 KENT COUNTY  
PEER APPROVED 4/30/98  
CHAIRMAN *Terry Hubert*

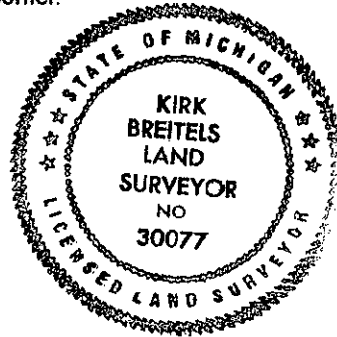

Signed by *Kirk Breitels*  
Surveyor's Michigan License No. 30077

Date 4/30/98