

KENT COUNTY REMONUMENTATION

\$7.00 MAR 08 1999
\$2.00

SECTION

LAND CORNER RECORDATION CERTIFICATE
Filing Requirement of Act 74, Mich. P.A. 1970

For corners in

KENT COUNTY
(County)

Located in:

Corner Code #

- 1. Public Land Survey
T 9N R 11W J-7
T R
T R
T R
- 2. Property Controlling in Section
S T R
S T R
- 3. Miscellaneous Property in Sec.
S T R
S T R

- 4. Lot No. _____, Recorded Plat _____
- 5. Private Claims _____

I, Kirk Breitels, in a field survey on Jan. 19, 19 98 do hereby state that under requirements of P.A. 74, Michigan P.A. of 1970, the corner points mentioned in lines 1 and 2 above were in conformance with regulations and rules therefore as required in the current manual of survey instructions of the United States Department of the Interior, Bureau of Land Management or by a decree of a Court of Law and /or that the corner points mentioned in lines 3, 4 and 5 above were in conformance with the rules of the Michigan Board of Land Surveyors or by a Decree of a Court of Law; established, re-established, monumented, recovered, found as expressed below:

NOTE: Not more than 2 corners, all in the same town and range, may be recorded on this certificate.

A. Description of original monument and accessories and/or subsequent restoration:

- J-7 1837 GLO Whitcomb Set Post
- 1964 Kent Co. Wits Mon. Box
- 1973 LCRC #383 Spicer 1" Iron in Mon. Box
- 1982 LCRC #2518 Starr Set Kent County Monument in Mon. Box
- 1994 LCRC #7037 Byl Kent County Monument

The position of this corner was previously approved by the Kent County Remonumentation Peer Group, monumented by Thomas C. Starr on 1-5-82 and was recorded per LCRC #2518.

B. Description of corner evidence found and/or method applied in restoring or reestablishing corner:

J-7 Found Kent County Monument (Harrison) per witnesses from above LCRC as set by Thomas C. Starr in place of the 3/4" Iron Pipe he found inside a Mon. Box. Said Iron Pipe checks with Kent Co. Wits and LCRC #383.

- | | |
|--|--|
| LCRC #2518 | LCRC #7037 |
| Nail & Remon. tag Tel. Pole N15°W 30.65' | Nail & Remon. tag P. Pole N40°E 139.08' |
| Nail & Remon. tag P. Pole N40°E 139.23' | Nail & Remon. tag P. Pole S75°E 193.30' |
| Nail & Remon. tag P. Pole S75°E 193.45' | Nail & Remon. tag top guard rail post S20°E 61.34' |
| Nail & Remon. tag Tel. Pole S10°W 86.67' | Nail & Remon. tag P. Pole N70°E 100.37' |
| Nail & Remon. tag 8" Spruce N30°W 70.16' | Nail & Remon. tag 18" Spruce N30°W 70.37' |
| NE cor. hse. fnd. S75°W 140.27' | NE corner house foundation S75°W 140.21' |

The selected location is accepted by me and is generally accepted by professional surveyors as the best available evidence of the position of the original corner.

C. Description of monument for corner and accessories established to perpetuate locating the position of the corner:

- J-7 Standard Kent County Monument
- Nail & KC Remon. tag NW side P. Pole N40°E 139.08'
- Nail & KC Remon. tag N. side P. Pole S75°E 193.30'
- Nail & KC Remon. tag top guard rail post S20°E 61.34'
- Nail & KC Remon. tag SE side P. Pole N70°E 100.33'
- Nail & KC Remon. tag E. side 18" Spruce N30°W 70.37'
- NE corner house foundation S75°W 140.21'
- Spike in C/L Edgerton Ave. and 13 Mile Rd. East 49.95'

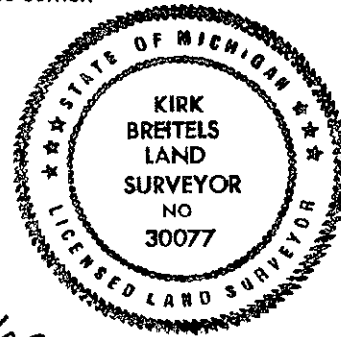

Signed by [Signature]
Surveyor's Michigan License No. 30077

Date 2/19/98

STATE OF MICHIGAN
COUNTY OF KENT
RECEIVED FOR RECORD
98 MAR -5 AM 8:34
REG. OF DEEDS
[Signature]

10557

Register of Deeds Stamp & File Number

A	B	C	D	E	F	G	H	I	J	K	L	M
1												
2	6		5		4		3		2		1	
3												
4	7		8		9		10		11		12	
5												
6	18		17		16		15		14		13	
7												
8	19		20		21		22		23		24	
9												
10	30		29		28		27		26		25	
11												
12	31		32		33		34		35		36	
13												

P.A. 345 1990 KENT COUNTY
PEER APPROVED 2/19/98
CHAIRMAN [Signature]