

FEB 14 1997

COMMISSION

KENT COUNTY REMONUMENTATION

LAND CORNER RECORDATION CERTIFICATE
Filing Requirement of Act 74, Mich. P.A. 1970

For corners in
KENT COUNTY

Located In: Corner Code #

| | | |
|------------------------------------|----------|------|
| 1. Public Land Survey | T9N R11W | J-13 |
| | T R | |
| | T R | |
| | T R | |
| 2. Property Controlling in Section | S T R | |
| | S T R | |
| 3. Miscellaneous Property in Sec. | S T R | |
| | S T R | |

STATE OF MICHIGAN
COUNTY OF KENT
RECEIVED FOR RECORD
96 SEP 13 PM 12:03
REG. OF DEEDS
Lucy Bond
9343
Register of Deeds Stamp & File Number

4. Lot No. _____, Recorded Plat _____
5. Private Claims _____

I, Kirk Breitels, in a field survey on July 29, 1996 do hereby state that under requirements of P.A. 74, Michigan P.A. of 1970, the corner points mentioned in lines 1 and 2 above were in conformance with regulations and rules therefore as required in the current manual of survey instructions of the United States Department of the Interior, Bureau of Land Management or by a decree of a Court of Law and/or that the corner points mentioned in lines 3, 4 and 5 above were in conformance with the rules of the Michigan Board of Land Surveyors or by a Decree of a Court of Law; established, re-established, monumented, recovered, found as expressed below:

NOTE: Not more than 2 corners, all in the same town and range, may be recorded on this certificate.

| | | | | | | | | | | | | | |
|----|---|----|---|----|---|----|---|----|---|----|---|----|---|
| 1 | A | B | C | D | E | F | G | H | I | J | K | L | M |
| 2 | | 6 | | 5 | | 4 | | 3 | | 2 | | 1 | |
| 3 | | | | | | | | | | | | | |
| 4 | | 7 | | 8 | | 9 | | 10 | | 11 | | 12 | |
| 5 | | | | | | | | | | | | | |
| 6 | | 18 | | 17 | | 16 | | 15 | | 14 | | 13 | |
| 7 | | | | | | | | | | | | | |
| 8 | | 19 | | 20 | | 21 | | 22 | | 23 | | 24 | |
| 9 | | | | | | | | | | | | | |
| 10 | | 30 | | 29 | | 28 | | 27 | | 26 | | 25 | |
| 11 | | | | | | | | | | | | | |
| 12 | | 31 | | 32 | | 33 | | 34 | | 35 | | 36 | |
| 13 | | | | | | | | | | | | | |

P.A. 345 1990 KENT COUNTY
PEER APPROVED 8/22/96
CHAIRMAN *Harry Hubel*

A. Description of original monument and accessories and/or subsequent restoration:

J-13 1837 GLO Brookfield Set Post
1887-1971 Williams & Works Kent Co. Wit. Stone-Iron-Mon. Box
1983 LCRC #3397 Glaza 3/4" Iron-Mon. Box
1984 LCRC #4028 Byl Mon. Box
1994 LCRC #7040 Byl Set Kent County Monument in Mon. Box
Kent County Monument

The position of this corner was previously approved by the Kent County Remonumentation Peer Group, monumented by William R. Byl on 11/7/84 and was recorded per LCRC #4028.

B. Description of corner evidence found and/or method applied in restoring or reestablishing corner:

J-13 Found standard Kent Co. Mon. (Harrison) per witnesses from above LCRC as set by William R. Byl in place of the 1" Iron he found over a 1 1/2" Iron inside a Mon. Box. Both Irons check with Williams & Works, Kent Co. Wit. and LCRC #3397.
LCRC #4028 & #7040

| | | | | | |
|--------------------------------|-------|----------|-----------|-------|--------|
| Iron Pipe | N00°E | 59.52' | Iron Pipe | N00°E | 36.96' |
| Capped Iron | N00°E | 59.89' | | | |
| SW cor. Sec. 35-9-11 (KC Mon.) | N90°W | 2659.64' | | | |
| SE cor. Sec. 35-9-11 (KC Mon.) | N90°E | 2662.70' | | | |
| N 1/4 Sec. 2-8-11 (KC Mon.) | N90°E | 156.65' | | | |

The selected location is accepted by me and is generally accepted by professional surveyors as the best available evidence of the position of the original corner.

C. Description of monument for corner and accessories established to perpetuate locating the position of the corner:

J-13 Standard Kent County Monument

| | | |
|--------------------------------|-------|----------|
| Iron Pipe | N00°E | 59.52' |
| Capped Iron | N00°E | 59.89' |
| SW cor. Sec. 35-9-11 (KC Mon.) | N90°W | 2659.54' |
| SE cor. Sec. 35-9-11 (KC Mon.) | N90°E | 2662.71' |
| N 1/4 Sec. 2-8-11 (KC Mon.) | N90°E | 156.65' |
| Iron Pipe | N00°E | 36.96' |

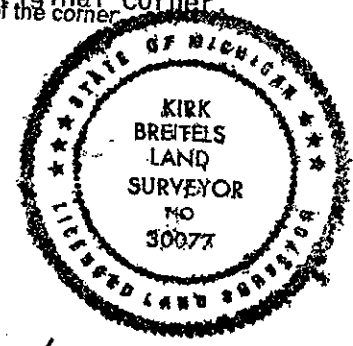

Signed by *Kirk Breitels*
Surveyor's Michigan License No. 30077

Date 8/25/96