

RECORDATION SECTION
 MAR 08 1999
 \$7.00
 \$2.00

KENT COUNTY REMONUMENTATION

LAND CORNER RECORDATION CERTIFICATE
 Filing Requirement of Act 74, Mich. P.A. 1970

SECTION

For corners in

KENT COUNTY

(County)

Located In:

Corner Code #

1. Public Land Survey

T 9N R 11W K-11

T R

T R

T R

2. Property Controlling in Section

S T R

S T R

3. Miscellaneous Property in Sec.

S T R

S T R

4. Lot No. _____, Recorded Plat _____

5. Private Claims _____

STATE OF MICHIGAN
 COUNTY OF KENT
 RECEIVED FOR RECORD
 98 MAR -5 AM 8:34
 REG. OF DEEDS
Lucy Bond

10568

Register of Deeds Stamp & File Number

A	B	C	D	E	F	G	H	I	J	K	L	M
1												
2	6		5		4		3		2		1	
3												
4	7		8		9		10		11		12	
5												
6	18		17		16		15		14		13	
7												
8	19		20		21		22		23		24	
9												
10	30		29		28		27		26		25	
11												
12	31		32		33		34		35		36	
13												

I, Kirk Breitels, in a field survey on Jan. 9, 1998 do hereby state that under requirements of P.A. 74, Michigan P.A. of 1970, the corner points mentioned in lines 1 and 2 above were in conformance with regulations and rules therefore as required in the current manual of survey instructions of the United States Department of the Interior, Bureau of Land Management or by a decree of a Court of Law and /or that the corner points mentioned in lines 3, 4 and 5 above were in conformance with the rules of the Michigan Board of Land Surveyors or by a Decree of a Court of Law; established, re-established, monumented, recovered, found as expressed below:

NOTE: Not more than 2 corners, all in the same town and range, may be recorded on this certificate.

A. Description of original monument and accessories and/or subsequent restoration:

- K-11 1837 GLO Whitcomb Set Post
- Kent Co. Wits Stone & Iron
- 1973 LCRC #382 Spicer 3/4" Iron
- 1976 LCRC #904 McCloskey Iron
- 1977 LCRC #1055 Hay 3/4" Iron
- 1981 LCRC #2501 Hay Set Kent County Monument
- 1994 LCRC #7050 Byl Kent County Monument

The position of this corner was previously approved by the Kent County Remonumentation Peer Group, monumented by Clayton S. Hay on 12-16-81 and was recorded per LCRC #2501.

B. Description of corner evidence found and/or method applied in restoring or reestablishing corner:

K-11 Found Kent County Monument (Harrison) per witnesses from above LCRC as set by Clayton S. Hay in place of the Iron and Stone he found. Said Iron and Stone checks with Kent Co. Wits. and LCRC's #382, #904 and #1055.
 LCRC #2501 LCRC #7050

- Nail & Remon. tag 12" Cherry N10°E 25.12' Nail & Remon. tag 16" Cherry N10°E 25.00'
- Nail & Remon. tag 16" Oak N15°E 34.70' Nail & Remon. tag 18" Oak N15°E 34.70'
- Nail & Remon. tag 12" Oak N40°E 42.16' Nail & Remon. tag 16" Oak N40°E 42.16'
- Nail & Remon. tag 19" Oak N62°E 32.53' Nail & Remon. tag 22" Oak N62°E 32.53'
- Nail & Remon. tag 9" Cherry S06°E 47.20' Nail & Remon. tag 12" Cherry S06°E 47.15'
- Nail & Remon. tag 7" Poplar S35°E 40.87' Nail & Remon. tag 10" Poplar S35°E 40.66'

The selected location is accepted by me and is generally accepted by professional surveyors as the best available evidence of the position of the original corner.

C. Description of monument for corner and accessories established to perpetuate locating the position of the corner:

- K-11 Standard Kent County Monument
- Nail & KC Remon. tag E. side 16" Cherry N10°E 25.00'
- Nail & KC Remon. tag E. side 18" Oak N15°E 34.66'
- Nail & KC Remon. tag W. side 16" Oak N40°E 42.16'
- Nail & KC Remon. tag NW side 22" Oak N62°E 32.53'
- Nail & KC Remon. tag W. side 12" Cherry S06°E 47.15'
- Nail & KC Remon. tag SW side 12" Poplar S35°E 40.73'

P.A. 345 1990 KENT COUNTY
 PEER APPROVED 2/19/98
 CHAIRMAN Harry Hulse

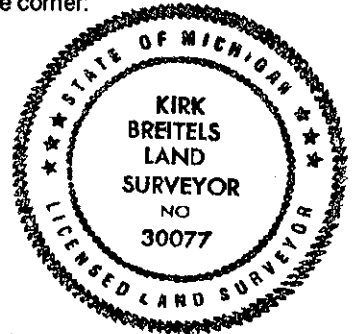

Signed by Kirk Breitels
 Surveyor's Michigan License No. 30077

Date 2/19/98