

SURVEY & REMONUMENTATION

\$7.00
\$2.00

MAR 08 1999

KENT COUNTY REMONUMENTATION

SECTION

LAND CORNER RECORDATION CERTIFICATE
Filing Requirement of Act 74, Mich. P.A. 1970

STATE OF MICHIGAN
COUNTY OF KENT
RECEIVED FOR RECORDS
98 MAR -5 AM 8:34
REG. OF DEEDS
David Spauld

For corners in

KENT COUNTY

Located In:

Corner Code #

- 1. Public Land Survey T 9N R 11W K-12
- T R
- T R
- T R
- T R
- 2. Property Controlling S T R
- in Section S T R
- 3. Miscellaneous S T R
- Property in Sec. S T R

10569

Register of Deeds Stamp & File Number

- 4. Lot No. _____, Recorded Plat _____
- 5. Private Claims _____

I, Kirk Breitels, in a field survey on Jan. 14, 19 98 do hereby state that under requirements of P.A. 74, Michigan P.A. of 1970, the corner points mentioned in lines 1 and 2 above were in conformance with regulations and rules therefore as required in the current manual of survey instructions of the United States Department of the Interior, Bureau of Land Management or by a decree of a Court of Law and/or that the corner points mentioned in lines 3, 4 and 5 above were in conformance with the rules of the Michigan Board of Land Surveyors or by a Decree of a Court of Law; established, re-established, monumented, recovered, found as expressed below:

NOTE: Not more than 2 corners, all in the same town and range, may be recorded on this certificate.

A	B	C	D	E	F	G	H	I	J	K	L	M
1												
2	6		5		4		3		2		1	
3												
4	7		8		9		10		11		12	
5												
6	18		17		16		15		14		13	
7												
8	19		20		21		22		23		24	
9												
10	30		29		28		27		26		25	
11												
12	31		32		33		34		35		36	
13												

A. Description of original monument and accessories and/or subsequent restoration:

- K-12 1837 GLO Whitcomb Set Post
- Kent Co. Wits Stone & Iron
- 1976 LCRC #904 McCloskey RR Iron
- 1981 LCRC #2557 Bueche Set Kent County Monument
- 1994 LCRC #7051 Byl Kent County Monument

P.A. 345 1990 KENT COUNTY
PEER APPROVED 2/19/98
CHAIRMAN Harry Hulse

The position of this corner was previously approved by the Kent County Remonumentation Peer Group, monumented by John C. Bueche on 12-21-81 and was recorded per LCRC #2557.

B. Description of corner evidence found and/or method applied in restoring or reestablishing corner:

K-12 Found Kent County Monument (Harrison) per witnesses from above LCRC as set by John C. Bueche in place of the RR Iron he found. Said RR Iron checks with Kent Co. Wits. and LCRC #904.

LCRC #2557		LCRC #7051
Nail & Remon. tag 12" Oak	N55°W 36.02'	Nail & Remon. tag 15" Oak N55°W 35.97'
Nail & Remon. tag 12" Oak	S70°W 62.55'	Nail & Remon. tag 15" Oak S70°W 62.49'
Nail & Remon. tag 24" Oak	S10°W 33.73'	Nail & Remon. tag 27" Oak S10°W 33.73'
Nail & Remon. tag 10" Sassafras	N80°E 20.85'	Nail & Remon. tag 12" Sassafras N80°E 20.90'
Spike in 26" Oak	West 13.25'	Nail & Remon. tag 30" Oak S90°W 13.25'
Spike in 14" Hickory	East 31.31'	Spike in 16" Hickory East 31.33'

The selected location is accepted by me and is generally accepted by professional surveyors as the best available evidence of the position of the original corner.

C. Description of monument for corner and accessories established to perpetuate locating the position of the corner:

- K-12 Standard Kent County Monument
- Nail & KC Remon. tag S. side 18" Oak S70°W 62.49'
- Nail & KC Remon. tag E. side 27" Oak S10°W 33.73'
- Nail & KC Remon. tag N. side 14" Sassafras N80°E 20.90'
- Nail & KC Remon. tag S. side 30" Oak S90°W 13.25'
- Nail & KC Remon. tag N. side 16" Hickory S90°E 31.34'
- On Tree line South
- C/L new E-W road is N. 45' ±

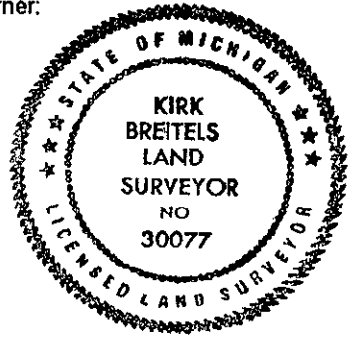

Signed by *Kirk Breitels*
Surveyor's Michigan License No. 30077

Date 2/19/98