

FEB 14 1997

KENT COUNTY REMONUMENTATION

COMMISSION

LAND CORNER RECORDATION CERTIFICATE
Filing Requirement of Act 74, Mich. P.A. 1970

For corners in
KENT COUNTY

(County)

Located In:	Corner Code #
T 9N R 11W	K-13
T R	
T R	
T R	
T R	
S T R	
S T R	
S T R	
S T R	

1. Public Land Survey

2. Property Controlling in Section

3. Miscellaneous Property in Sec.

REG. OF DEEDS

Lucy Staud

96 MAR 20 AM 9:00

STATE OF MICHIGAN
COUNTY OF KENT
RECEIVED FOR RECORD

9137

Register of Deeds Stamp & File Number

4. Lot No. _____, Recorded Plat _____
5. Private Claims _____

I, Kirk Breitels, in a field survey on Jan. 25, 1996 do hereby state that under requirements of P.A. 74, Michigan P.A. of 1970, the corner points mentioned in lines 1 and 2 above were in conformance with regulations and rules therefore as required in the current manual of survey instructions of the United States Department of the Interior, Bureau of Land Management or by a decree of a Court of Law and /or that the corner points mentioned in lines 3, 4 and 5 above were in conformance with the rules of the Michigan Board of Land Surveyors or by a Decree of a Court of Law; established, re-established, monumented, recovered, found as expressed below:

NOTE: Not more than 2 corners, all in the same town and range, may be recorded on this certificate.

P.A. 345 1990 KENT COUNTY
PEER APPROVED 3/7/96
CHAIRMAN Harrison

	A	B	C	D	E	F	G	H	I	J	K	L	M
1													
2	6	5	4	3	2	1							
3													
4	7	8	9	10	11	12							
5													
6	18	17	16	15	14	13							
7													
8	19	20	21	22	23	24							
9													
10	30	29	28	27	26	25							
11													
12	31	32	33	34	35	36							
13													

A. Description of original monument and accessories and/or subsequent restoration:

K-13	1837	GLO	Brookfield	Set Post
	1879-1971	Williams & Works		Iron Bar-Iron-Mon. Box
		Kent Co. Wit.		Mon. Box
	1983	LCRC #3405	Glaza	Mon. Box
	1984	LCRC #4027	Byl	Set Kent County Monument in Mon. Box
	1994	LCRC #7052	Byl	Kent County Monument in Mon. Box

The position of this corner was previously approved by the Kent County Remonumentation Peer Group, monumented by William R. Byl on 11/7/84 and was recorded per LCRC #4027.

B. Description of corner evidence found and/or method applied in restoring or reestablishing corner:

K-13 Found standard Kent Co. Mon. (Harrison) per witnesses from above LCRC as set by William R. Byl in place of the 1" Iron Pipe he found over a 1" Iron Pipe inside a Mon. box. Both Irons check with Williams & Works, Kent Co. Wit. and LCRC #3405.
LCRC #4027 & 7052

Nail & KC Remon. tag W. side P. Pole	S65°W	63.17'	NE cor. Sec. 2-8-11
Nail & KC Remon. tag N. side P. Pole	S60°E	65.02'	(Kent Co. Mon.)
Nail & KC Remon. tag W. side Guy Pole	N60°E	67.26'	N90°E 109.10'
SE corner brick house	N30°W	91.35'	
NE face 8" vent pipe, 1' above ground	S30°W	37.19'	

The selected location is accepted by me and is generally accepted by professional surveyors as the best available evidence of the position of the original corner.

C. Description of monument for corner and accessories established to perpetuate locating the position of the corner:

K-13 Standard Kent County Monument in Mon. Box			
Nail & KC Remon. tag W. side P. Pole	S65°W	63.17'	
Nail & KC Remon. tag N. side P. Pole	S60°E	65.02'	
Nail & KC Remon. tag W. side Guy Pole	N60°E	67.26'	
SE corner brick house	N30°W	91.35'	
NE face 8" vent pipe, 1' above ground	S30°W	37.19'	
NE cor. Sec. 2-8-11 (Kent Co. Mon.)	N90°E	109.09'	

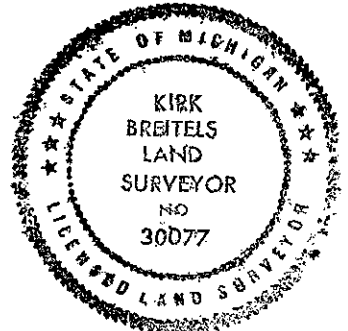

Signed by *Kirk Breitels*
Surveyor's Michigan License No. 30077

Date 3/2/96