

MAR 08 1999

\$7.00
\$2.00

SECTION

KENT COUNTY REMONUMENTATION

LAND CORNER RECORDATION CERTIFICATE
Filing Requirement of Act 74, Mich. P.A. 1970

STATE OF MICHIGAN
COUNTY OF KENT
RECEIVED FOR RECORD
98 NOV 16 AM 8:00
REG. OF DEEDS
Luigi Bond

For corners in

KENT COUNTY

(County)

Located In:

Corner Code #

- 1. Public Land Survey T 9N R 11W L-12
- T ___ R ___
- T ___ R ___
- T ___ R ___
- T ___ R ___
- 2. Property Controlling S ___ T ___ R ___
- in Section S ___ T ___ R ___
- 3. Miscellaneous S ___ T ___ R ___
- Property in Sec. S ___ T ___ R ___

10921

Register of Deeds Stamp & File Number

- 4. Lot No. _____, Recorded Plat _____
- 5. Private Claims _____

| | | | | | | | | | | | | | |
|----|----|---|----|---|----|---|----|---|----|---|----|---|---|
| | A | B | C | D | E | F | G | H | I | J | K | L | I |
| 1 | | | | | | | | | | | | | |
| 2 | 6 | | 5 | | 4 | | 3 | | 2 | | 1 | | |
| 3 | | | | | | | | | | | | | |
| 4 | 7 | | 8 | | 9 | | 10 | | 11 | | 12 | | |
| 5 | | | | | | | | | | | | | |
| 6 | 18 | | 17 | | 16 | | 15 | | 14 | | 13 | | |
| 7 | | | | | | | | | | | | | |
| 8 | 19 | | 20 | | 21 | | 22 | | 23 | | 24 | | |
| 9 | | | | | | | | | | | | | |
| 10 | 30 | | 29 | | 28 | | 27 | | 26 | | 25 | | |
| 11 | | | | | | | | | | | | | |
| 12 | 31 | | 32 | | 33 | | 34 | | 35 | | 36 | | |
| 13 | | | | | | | | | | | | | |

I, Kirk Breitels, in a field survey on Oct. 1, 1998 do hereby state that under requirements of P.A. 74, Michigan P.A. of 1970, the corner points mentioned in lines 1 and 2 above were in conformance with regulations and rules therefore as required in the current manual of survey instructions of the United States Department of the Interior, Bureau of Land Management or by a decree of a Court of Law and /or that the corner points mentioned in lines 3, 4 and 5 above were in conformance with the rules of the Michigan Board of Land Surveyors or by a Decree of a Court of Law; established, re-established, monumented, recovered, found as expressed below:

NOTE: Not more than 2 corners, all in the same town and range, may be recorded on this certificate.

A. Description of original monument and accessories and/or subsequent restoration:

- L-12 1837 GLO Not Set
- 1947 Williams & Works Computed location fall at E. edge of Rogue River
- 1955-61 Williams & Works Plats in the W 1/2 NW 1/4 per 1947 E-W 1/4 line
- Kent Co. Wits Leaded Stone
- C/L RR W 10.79' MBT Pole NE 14.55' 16" Elm NE 57.50' Iron post E 24.05'
- 1991+ Glaza & Assoc. Intersection of 1/4 lines for Surveys and new Plats
- 1994+ Nederveld & Assoc. Intersection of 1/4 lines for new Plats E 1/2 NW 1/4 & pt. NE 1/4

B. Description of corner evidence found and/or method applied in restoring or reestablishing corner:

L-12 Established L-12 (C 1/4 cor. Sec. 36) per Williams & Works plats and subsequent surveys and found location to be just into the East side of the Rogue River. L-12 as computed is 2.5' N. & 3.2' E. of the Intersection of 1/4 lines. Did not find corner per Kent Co. Wits. and I am not sure if these witnesses refer to this corner. Running a line from this computed location for L-12 to the E 1/4 corner, I find survey work done by Exxel on the Rockford Schools parcel (large parcel) to be in agreement ± as are other property Irons found. Where the new plat boundary adjoins old parcels as described and staked (297' N. of the E-W 1/4 line in NW 1/4) an overlap is created.

The position of L-12 (C 1/4 corner Sec. 36) per Williams & Works plats as described above is accepted by me and is generally accepted by professional surveyors as the best available evidence of the position of the corner.

C. Description of monument for corner and accessories established to perpetuate locating the position of the corner:

L-12 NO MONUMENT SET AT THIS CORNER - location is in Rogue River

See LCRC # 10922 and LCRC # 10923 for location of witness monuments

P.A. 345 1990 KENT COUNTY

PEER APPROVED 10/22/98

CHAIRMAN [Signature]

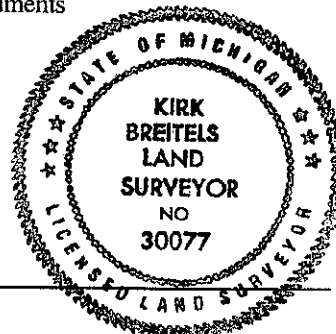

Signed by [Signature]
Surveyor's Michigan License No. 30077

Date 11/12/98