

FEB 14 1997

**KENT COUNTY REMONUMENTATION**

**COMMISSION**

**LAND CORNER RECORDATION CERTIFICATE**  
Filing Requirement of Act 74, Mich. P.A. 1970

For corners in

KENT COUNTY

(County)

Located In: \_\_\_\_\_

Corner Code # \_\_\_\_\_

1. Public Land Survey

T 8N R 11W M-1  
~~T 8N R 10W A-1~~  
 T 9N R 11W **M-13**  
~~T 9N R 10W A-13~~

2. Property Controlling in Section

S \_\_\_ T \_\_\_ R \_\_\_  
 S \_\_\_ T \_\_\_ R \_\_\_

3. Miscellaneous Property in Sec.

S \_\_\_ T \_\_\_ R \_\_\_  
 S \_\_\_ T \_\_\_ R \_\_\_

4. Lot No. \_\_\_\_\_, Recorded Plat \_\_\_\_\_

5. Private Claims \_\_\_\_\_

I, Kirk Breitels, in a field survey on Jan. 22, 19 96 do hereby state that under requirements of P.A. 74, Michigan P.A. of 1970, the corner points mentioned in lines 1 and 2 above were in conformance with regulations and rules therefore as required in the current manual of survey instructions of the United States Department of the Interior, Bureau of Land Management or by a decree of a Court of Law and/or that the corner points mentioned in lines 3, 4 and 5 above were in conformance with the rules of the Michigan Board of Land Surveyors or by a Decree of a Court of Law; established, re-established, monumented, recovered, found as expressed below:

NOTE: Not more than 2 corners, all in the same town and range, may be recorded on this certificate.

P.A. 345 1990 KENT COUNTY

PEER APPROVED 3/7/96

CHAIRMAN Henry Huber

A. Description of original monument and accessories and/or subsequent restoration:

M-1	1837	GLO	Brookfield	Set Post
	1954	Kent Co. Wit.		Iron Bar
	1900-76	Williams & Works		Stone-Iron-Mon. Box
	1984	LCRC #3976	Byl	Set Kent County Monument in Mon. Box
	1994	LCRC #7070	Byl	Kent County Monument in Mon. Box.

The position of this corner was previously approved by the Kent County Remonumentation Peer Group, monumented by William R. Byl on 11/2/84 and was recorded per LCRC #3976.

B. Description of corner evidence found and/or method applied in restoring or reestablishing corner:

M-1 Found standard Kent Co. Mon. (Harrison) per witnesses from above LCRC as set by William R. Byl in place of the 1/2" Iron Pipe he found inside a Mon. Box. Said Iron Pipe checks with Kent Co. Wit. and Williams & Works information.

LCRC #3976 & #7070

NE cor. brick bldg. (4' above grade)	S30°W	96.32'	
NW cor. brick bldg. (3' above grade)	S20°E	55.86'	C/L Manhole N45°W 20.96'
NE cor. brick bldg. (3' above grade)	S45°E	69.38'	
"V" cut in face of conc. wall	N00°E	24.33'	
C/L Manhole	S80°W	25.76'	

The selected location is accepted by me and is generally accepted by professional surveyors as the best available evidence of the position of the original corner.

C. Description of monument for corner and accessories established to perpetuate locating the position of the corner:

M-1 Standard Kent County Monument in Mon. Box		
NE cor. brick bldg. (4' above grade)	S30°W	96.32'
NW cor. brick bldg. (3' above grade)	S20°E	55.86'
NE cor. brick bldg. (3' above grade)	S45°E	69.38'
"V" cut in face of conc. wall	N00°E	24.33'
C/L Manhole	S80°W	25.76'
C/L Manhole	N45°W	20.96'

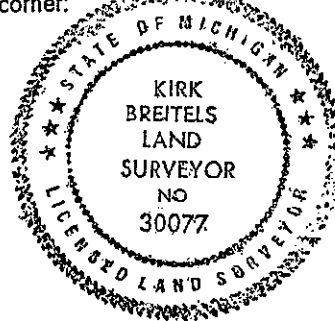

Signed by Kirk Breitels

Date 2/6/96

Surveyor's Michigan License No. 30077

REG. OF DEEDS  
 STATE OF MICHIGAN  
 COUNTY OF KENT  
 RECEIVED FOR RECORD  
 95 MAR 20 AM 8:59  
*Lucy Spauld*

**9118**

Register of Deeds Stamp & File Number

A	B	C	D	E	F	G	H	I	J	K	L	M
1												
2	6		5		4		3		2		1	
3												
4	7		8		9		10		11		12	
5												
6	18		17		16		15		14		13	
7												
8	19		20		21		22		23		24	
9												
10	30		29		28		27		26		25	
11												
12	31		32		33		34		35		36	
13												