

11/2
MAR 08 1999

KENT COUNTY REMONUMENTATION

SECTION

LAND CORNER RECORDATION CERTIFICATE
Filing Requirement of Act 74, Mich. P.A. 1970

For corners in

KENT COUNTY

(County)

Located In:

Corner Code #

1. Public Land Survey	T <u>9</u> N	R <u>12</u> W	B-4
	T	R	
	T	R	
	T	R	
2. Property Controlling in Section	S	T	R
	S	T	R
3. Miscellaneous Property in Sec.	S	T	R
	S	T	R

STATE OF MICHIGAN
COUNTY OF KENT
RECEIVED FOR RECORD
38 OCT - 7 AM 10: 15
REG. OF DEEDS
Lucy Stand

10700

Register of Deeds Stamp & File Number

4. Lot No. _____, Recorded Plat _____
5. Private Claims _____

I, Kirk Breitels, in a field survey on July 1, 19 98 do hereby state that under requirements of P.A. 74, Michigan P.A. of 1970, the corner points mentioned in lines 1 and 2 above were in conformance with regulations and rules therefore as required in the current manual of survey instructions of the United States Department of the Interior, Bureau of Land Management or by a decree of a Court of Law and /or that the corner points mentioned in lines 3, 4 and 5 above were in conformance with the rules of the Michigan Board of Land Surveyors or by a Decree of a Court of Law; established, re-established, monumented, recovered, found as expressed below:

NOTE: Not more than 2 corners, all in the same town and range, may be recorded on this certificate.

A	B	C	D	E	F	G	H	I	J	K	L	M
1												
2	6		5		4		3		2		1	
3												
4	7		8		9		10		11		12	
5												
6	18		17		16		15		14		13	
7												
8	19		20		21		22		23		24	
9												
10	30		29		28		27		26		25	
11												
12	31		32		33		34		35		36	
13												

A. Description of original monument and accessories and/or subsequent restoration:

B-4 1837 GLO Not Set
 1937 Kent Co. Wits Concrete Mon.
 18" Maple N. 21.9' 24" Ash NW 40.5' 8" Apple SW 28.9' 8" Apple SSW 54.6'
 1968 Consumer Power Co. Concrete Mon.
 Same witnesses as Kent Co. Wits.

P.A. 345 1990 KENT COUNTY
PEER APPROVED 7/23/98
CHAIRMAN [Signature]

B. Description of corner evidence found and/or method applied in restoring or reestablishing corner:

B-4 Found 1/2" x 6" Iron Pipe over Boat Spike stuck inside 1" x 12" Iron Pipe over an old style wire Concrete Monument - all inside a Mon. Box

Fits one remaining witness:

C/L 36" Maple North 22' ± Also found Capped Rerod (Roosicn) 33' North
 Iron(s) are 58.9' E. and 11.3' S. from intersection of 1/4 lines & agrees with Consumers Power Co. measurements ±
 Iron(s) are on Fence/tree line to North and South ± Fits 1/8 line occupation to East ±

The Iron(s) found in the Mon. Box are accepted by me and is generally accepted by professional surveyors as the best available evidence of the position of the corner.

C. Description of monument for corner and accessories established to perpetuate locating the position of the corner:

B-4 Set Standard Kent County Monument in Mon. Box over remains of Concrete Monument place of the Iron(s).
 Set Nail & KC Remon. tag E. side 36" Maple N05°E 22.21'
 C/L top W. end 12" C.M.P. S70°W 29.90'
 Nail & KC Remon. tag W. side 18" Maple S00°E 30.82'
 Cut "X" top of E. end 12" concrete culvert S55°E 32.31'
 Cut "X" top of E. end 12" concrete culvert N60°E 33.47'
 On tree row to N-S ±
 In C/L E-W blacktop road ±

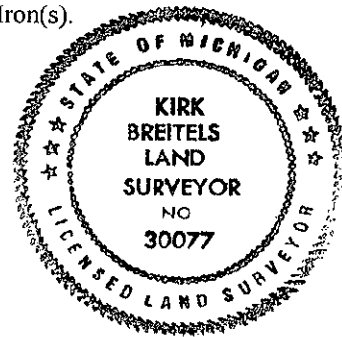

Signed by [Signature]
Surveyor's Michigan License No. 30077

Date 9/25/98