

MAR 08 1999

\$7.00
\$2.00

SECTION KENT COUNTY REMONUMENTATION

LAND CORNER RECORDATION CERTIFICATE
Filing Requirement of Act 74, Mich. P.A. 1970

For corners in

<u>KENT COUNTY</u> (County)	Located in:	Corner Code #
1. Public Land Survey	T <u>9N</u> R <u>12W</u>	<u>B-7</u>
	T _____ R _____	_____
	T _____ R _____	_____
	T _____ R _____	_____
2. Property Controlling in Section	S _____ T _____ R _____	_____
	S _____ T _____ R _____	_____
3. Miscellaneous Property in Sec.	S _____ T _____ R _____	_____
	S _____ T _____ R _____	_____
4. Lot No. _____, Recorded Plat _____		
5. Private Claims _____		

STATE OF MICHIGAN
COUNTY OF KENT
RECEIVED FOR RECORD
98 MAR -5 AM 8:28
REG. OF DEEDS
Lucy Bond

10432
Register of Deeds Stamp & File Number

	A	B	C	D	E	F	G	H	I	J	K	L	M
1													
2	6		5		4		3		2		1		
3													
4	7		8		9		10		11		12		
5													
6	18		17		16		15		14		13		
7	●												
8	19		20		21		22		23		24		
9													
10	30		29		28		27		26		25		
11													
12	31		32		33		34		35		36		
13													

I, Kirk Breitels, in a field survey on Jan. 26, 19 98 do hereby state that under requirements of P.A. 74, Michigan P.A. of 1970, the corner points mentioned in lines 1 and 2 above were in conformance with regulations and rules therefore as required in the current manual of survey instructions of the United States Department of the Interior, Bureau of Land Management or by a decree of a Court of Law and /or that the corner points mentioned in lines 3, 4 and 5 above were in conformance with the rules of the Michigan Board of Land Surveyors or by a Decree of a Court of Law; established, re-established, monumented, recovered, found as expressed below:

NOTE: Not more than 2 corners, all in the same town and range, may be recorded on this certificate.

- A. Description of original monument and accessories and/or subsequent restoration:
- B-7 1837 GLO Whitcomb Set Post
 - 1944 Kent Co. Wits Concrete Monument
 - 1983 LCRC #3560 VanKooten Boat Spike 0.4' South of C/L 13 Mile Rd.
 - 1989 LCRC #5297 Bueche Set Kent County Monument in Mon. Box

P.A. 345 1990 KENT COUNTY
PEER APPROVED 2/19/98
CHAIRMAN Harry Bueche

The position of this corner was previously approved by the Kent County Remonumentation Peer Group, monumented by John C. Bueche on 12-13-89 and was recorded per LCRC #5297.

- B. Description of corner evidence found and/or method applied in restoring or reestablishing corner:
- B-7 Found Kent County Monument (Harrison) per witnesses from above LCRC as set by John C. Bueche in place of the 1/2" Iron he found inside a Mon. box. Said Iron checks with Kent Co. Wits. Corner per LCRC #3560 is 10' North.
- LCRC #5297
- Nail & Remon. tag W. side P. Pole North 80.49'
 - Nail & Remon. tag S. side 18" Oak S80°E 288.10'
 - Nail & Remon. tag S. side 24" Oak N80°E 149.57'
 - Nail & Remon. tag top 6" dia. wood fence post N70°W 156.80'
 - C/L E-W blacktop road is North 10' ±

The selected location is accepted by me and is generally accepted by professional surveyors as the best available evidence of the position of the original corner.

C. Description of monument for corner and accessories established to perpetuate locating the position of the corner:

- B-7 Standard Kent County Monument in Mon. Box
- Nail & KC Remon. tag W. side P. Pole North 80.59'
 - Nail & KC Remon. tag S. side 22" Oak S80°E 288.05'
 - Nail & KC Remon. tag S. side 27" Maple N80°E 149.70'
 - Nail & KC Remon. tag top 6" dia. wood fence post N70°W 156.80'
 - C/L 13 Mile Rd. E-W is North 10' ±

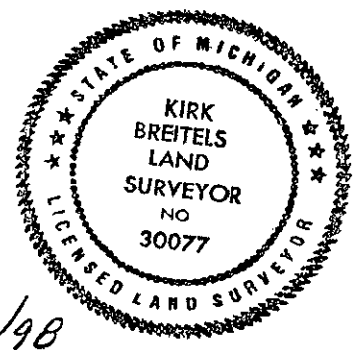

Signed by *Kirk Breitels*
Surveyor's Michigan License No. 30077

Date 2/19/98