

**SURVEY &
REMONUMENTATION**

MAR 08 1999

\$7.00
\$2.00

SECTION KENT COUNTY REMONUMENTATION
LAND CORNER RECORDATION CERTIFICATE
Filing Requirement of Act 74, Mich. P.A. 1970

For corners in

<u>KENT COUNTY</u> (County)	Located In:	Corner Code #
1. Public Land Survey	T <u>9N</u> R <u>12W</u>	<u>B-9</u>
	T <u> </u> R <u> </u>	<u> </u>
	T <u> </u> R <u> </u>	<u> </u>
	T <u> </u> R <u> </u>	<u> </u>
2. Property Controlling in Section	S <u> </u> T <u> </u> R <u> </u>	<u> </u>
	S <u> </u> T <u> </u> R <u> </u>	<u> </u>
3. Miscellaneous Property in Sec.	S <u> </u> T <u> </u> R <u> </u>	<u> </u>
	S <u> </u> T <u> </u> R <u> </u>	<u> </u>

STATE OF MICHIGAN
COUNTY OF KENT
RECEIVED FOR RECORD
98 MAR -5 AM 8:28
REG. OF DEEDS
Lucy Standa

10433

Register of Deeds Stamp & File Number

4. Lot No. _____, Recorded Plat _____
5. Private Claims _____

1	A	B	C	D	E	F	G	H	I	J	K	L	M
2		6		5		4		3		2		1	
3													
4		7		8		9		10		11		12	
5													
6		18		17		16		15		14		13	
7													
8		19		20		21		22		23		24	
9													
10		30		29		28		27		26		25	
11													
12		31		32		33		34		35		36	
13													

I, Kirk Breitels, in a field survey on Jan. 12, 19 98 do hereby state that under requirements of P.A. 74, Michigan P.A. of 1970, the corner points mentioned in lines 1 and 2 above were in conformance with regulations and rules therefore as required in the current manual of survey instructions of the United States Department of the Interior, Bureau of Land Management or by a decree of a Court of Law and /or that the corner points mentioned in lines 3, 4 and 5 above were in conformance with the rules of the Michigan Board of Land Surveyors or by a Decree of a Court of Law; established, re-established, monumented, recovered, found as expressed below:

NOTE: Not more than 2 corners, all in the same town and range, may be recorded on this certificate.

A. Description of original monument and accessories and/or subsequent restoration:

B-9	1837	GLO	Whitcomb	Set Post
	1963	Kent Co. Wits		1" Iron
	1984	LCRC #3875	Bueche	1" Iron
	1984	LCRC #4020	Bueche	Set Kent County Monument
	1991	LCRC #6130	Byl	Kent County Monument

P.A. 345 1998 KENT COUNTY
PEER APPROVED 2/19/98
CHAIRMAN Harry Huber

The position of this corner was previously approved by the Kent County Remonumentation Peer Group, monumented by John C. Bueche on 10-17-84 and was recorded per LCRC #4020.

B. Description of corner evidence found and/or method applied in restoring or reestablishing corner:

B-9 Found Kent County Monument (Harrison) per witnesses from above LCRC as set by John C. Bueche in place of the 1" Iron he found. Said 1" Iron checks with Kent Co. Wits. and LCRC #3875.

LCRC #3875		LCRC #6130	
Nail & Remon. tag 8" Poplar	N10°W 28.10'	Nail & Remon. tag 22" Stump	N65°E 67.98'
Nail & Remon. tag 22" Apple	N65°E 67.98'	Cut Nail 20" Apple	N30°E 38.69'
Cut Nail 20" Apple	N30°E 38.69'	NW cor. headstone "OTIS IRISH"	S30°W 41.98'
NW cor. headstone "OTIS IRISH"	S30°W 41.98'	NE cor. headstone "BROOKS"	S25°E 52.90'
NE cor. headstone "BROOKS"	S25°E 52.82'	Nail & Remon. tag P. Pole	N65°E 115.42'

C/L blacktop E-W is 2.2' ± South

The selected location is accepted by me and is generally accepted by professional surveyors as the best available evidence of the position of the original corner.

C. Description of monument for corner and accessories established to perpetuate locating the position of the corner:

B-9 Standard Kent County Monument

Nail in W. side 22" Apple	N30°E 38.58'
NW corner headstone "OTIS IRISH"	S30°W 41.98'
NE corner headstone "BROOKS"	S25°E 52.99'
Nail & KC Remon. tag SE side P. Pole	N65°E 115.42'
Nail & KC Remon. tag S. side 4" Cherry	N65°E 67.02'

C/L E-W asphalt road is 2' South ±

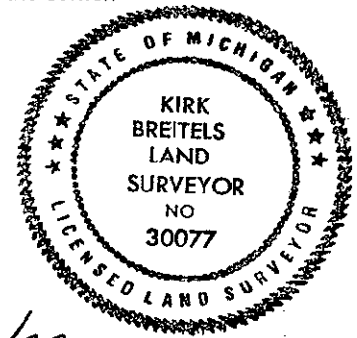

Signed by *Kirk Breitels*
Surveyor's Michigan License No. 30077

Date 2/19/98