

SURVEY & REMONUMENTATION

\$7.00
\$2.00

MAR 08 1999

KENT COUNTY REMONUMENTATION

SECTION

LAND CORNER RECORDATION CERTIFICATE
Filing Requirement of Act 74, Mich. P.A. 1970

For corners in

<u>KENT COUNTY</u> (County)	Located In:	Corner Code #
1. Public Land Survey	T <u>9N</u> R <u>12W</u>	<u>C-3</u>
	T _____ R _____	_____
	T _____ R _____	_____
	T _____ R _____	_____
2. Property Controlling in Section	S _____ T _____ R _____	_____
	S _____ T _____ R _____	_____
3. Miscellaneous Property in Sec.	S _____ T _____ R _____	_____
	S _____ T _____ R _____	_____

STATE OF MICHIGAN
COUNTY OF KENT
RECEIVED FOR RECORD

98 MAY 21 AM 9:32

REG. OF DEEDS
Lucy Grand

10617

Register of Deeds Stamp & File Number

4. Lot No. _____, Recorded Plat _____
5. Private Claims _____

I, Kirk Breitels, in a field survey on Feb. 20, 19 98 do hereby state that under requirements of P.A. 74, Michigan P.A. of 1970, the corner points mentioned in lines 1 and 2 above were in conformance with regulations and rules therefore as required in the current manual of survey instructions of the United States Department of the Interior, Bureau of Land Management or by a decree of a Court of Law and /or that the corner points mentioned in lines 3, 4 and 5 above were in conformance with the rules of the Michigan Board of Land Surveyors or by a Decree of a Court of Law; established, re-established, monumented, recovered, found as expressed below:

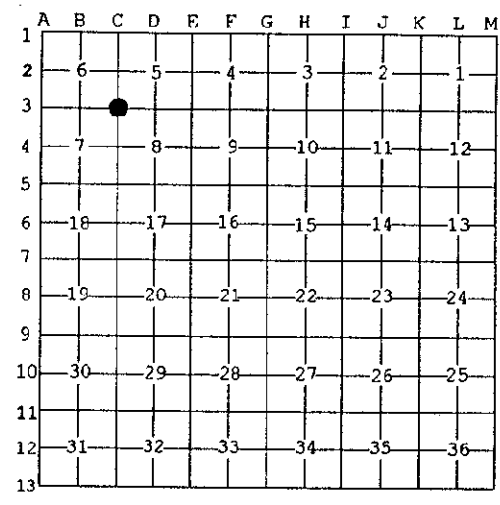

NOTE: Not more than 2 corners, all in the same town and range, may be recorded on this certificate.

A. Description of original monument and accessories and/or subsequent restoration:

C-3	1837	GLO	Whitcomb	Set Post
	1963	Kent Co. Wits		2" Iron
	1968	MDOT		2" Iron
	1984	LCRC #3809	Chettleburgh	Set Kent County Monument in Mon. Box
	1991	LCRC #6134	Byl	Kent County Monument

P.A. 345 1990 KENT COUNTY
PEER APPROVED 4/30/98
CHAIRMAN *Thomas M. Chettleburgh*

The position of this corner was previously approved by the Kent County Remonumentation Peer Group, monumented by Thomas M. Chettleburgh on 4-30-84 and was recorded per LCRC#3809.

B. Description of corner evidence found and/or method applied in restoring or reestablishing corner:

C-3 Found Kent County Monument (Harrison) per witnesses from above LCRC as set by Thomas M. Chettleburgh in place of the 5/8" Iron Pipe he found inside a Mon. Box. Said Iron Pipe checks with Kent Co. Wits. and MDOT.	
LCRC #3809	LCRC #6134
Cross in Conc. curb N50°E 48.82'	Cross in conc. curb N50°E 48.85'
Cross on Conc. curb S40°E 51.28	Cross in conc. curb S40°E 51.26'
Nail in P. Pole S36°W 89.46'	Nail & Remon. tag P. Pole S36°W 89.42'
Cross in Conc. curb N48°W 50.81'	Cross in conc. curb N48°W 50.84'
	Cut "X" top S. end conc. culv. S65°E 105.37'
	Cut "X" top S. end conc. culv. N20°E 151.09'

The selected location is accepted by me and is generally accepted by professional surveyors as the best available evidence of the position of the original corner.

C. Description of monument for corner and accessories established to perpetuate locating the position of the corner:

C-3 Standard Kent County Monument
Cross in concrete curb N50°E 48.85'
Cross in concrete curb S40°E 51.26'
Nail & KC Remon. tag NW side P. Pole S36°W 89.47'
Cross in concrete curb N48°W 50.84'
"X" on top S. end concrete culvert S65°E 105.37'

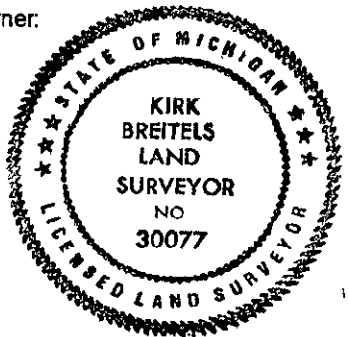

Signed by *Kirk Breitels*
Surveyor's Michigan License No. 30077

Date 4/30/98