

SURVEY & REMONUMENTATION

\$7.00
\$2.00

MAR 08 1999

KENT COUNTY REMONUMENTATION

SECTION

LAND CORNER RECORDATION CERTIFICATE
Filing Requirement of Act 74, Mich. P.A. 1970

REG. OF DEEDS

Lucy Bond

38 NOV 16 AM 8:00

STATE OF MICHIGAN
COUNTY OF KENT
RECEIVED FOR RECORD

For corners in

KENT COUNTY

(County)

Located In:

Corner Code #

- | | | | |
|------------------------------------|--------------|---------------|------------|
| 1. Public Land Survey | T <u>9</u> N | R <u>12</u> W | <u>D-6</u> |
| | T ___ R ___ | | |
| | T ___ R ___ | | |
| | T ___ R ___ | | |
| 2. Property Controlling in Section | S ___ T ___ | R ___ | |
| | S ___ T ___ | R ___ | |
| 3. Miscellaneous Property in Sec. | S ___ T ___ | R ___ | |
| | S ___ T ___ | R ___ | |

10927

Register of Deeds Stamp & File Number

4. Lot No. _____, Recorded Plat _____
5. Private Claims _____

I, Kirk Breitels, in a field survey on June 29, 1998 do hereby state that under requirements of P.A. 74, Michigan P.A. of 1970, the corner points mentioned in lines 1 and 2 above were in conformance with regulations and rules therefore as required in the current manual of survey instructions of the United States Department of the Interior, Bureau of Land Management or by a decree of a Court of Law and/or that the corner points mentioned in lines 3, 4 and 5 above were in conformance with the rules of the Michigan Board of Land Surveyors or by a Decree of a Court of Law; established, re-established, monumented, recovered, found as expressed below:

NOTE: Not more than 2 corners, all in the same town and range, may be recorded on this certificate.

A	B	C	D	E	F	G	H	I	J	K	L	M
1												
2	6		5		4		3		2		1	
3												
4	7		8		9		10		11		12	
5												
6	18		17		16		15		14		13	
7												
8	19		20		21		22		23		24	
9												
10	30		29		28		27		26		25	
11												
12	31		32		33		34		35		36	
13												

A. Description of original monument and accessories and/or subsequent restoration:

D-6 1837 GLO Not Set
Williams & Works No information
Kent Co. Wits No information

P.A. 345 1990 KENT COUNTY
PEER APPROVED 7/23/99
CHAIRMAN [Signature]

B. Description of corner evidence found and/or method applied in restoring or reestablishing corner:

D-6 Found Capped Rerod (JCK)

Said Capped Rerod (JCK) is 0.2' N. and 0.1' W. of Intersection of 1/4 lines.

Fence to West is South 2' ± and fence to South is East 5' ±

The Capped Rerod (JCK) is accepted by me and is generally accepted by professional surveyors as the best available evidence of the position of the corner.

C. Description of monument for corner and accessories established to perpetuate locating the position of the corner:

D-6 Set Standard Kent County Monument in place of the Capped Rerod (JCK).

- | | |
|--|--------------|
| Nail & KC Remon. tag SW side 24" Beech | S45°E 35.46' |
| Nail & KC Remon. tag E. side 36" Oak | S20°E 32.30' |
| Nail & KC Remon. tag N. side 14" Cherry | N85°W 25.46' |
| Nail & KC Remon. tag N. side 14" Hickory | N45°W 28.58' |
| Nail & KC Remon. tag SW side 8" Maple | N15°W 18.06' |
- In field trail NE-SW between fields.

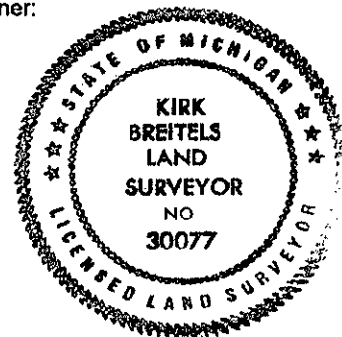

Signed by [Signature]
Surveyor's Michigan License No. 30077

Date 11/12/98