

\$7.00
\$2.00

SEP 18 1995

KENT COUNTY REMONUMENTATION

LAND CORNER RECORDATION CERTIFICATE

Filing Requirement of Act 74, Mich. P.A. 1970

For corners in
KENT COUNTY
(County)

Located In:

Corner Code #

- 1. Public Land Survey T 9N R 12W E-13
- T _____ R _____
- T _____ R _____
- T _____ R _____
- 2. Property Controlling S _____ T _____ R _____
- in Section S _____ T _____ R _____
- 3. Miscellaneous S _____ T _____ R _____
- Property in Section S _____ T _____ R _____

- 4. Lot No. _____, Recorded Plat _____
- 5. Private Claims _____

STATE OF MICHIGAN
COUNTY OF KENT
RECEIVED FOR RECORD

95 JUN 29 PM 12:00

REG. OF DEEDS
[Signature]
8519

Register of Deeds Stamp & File Number

A	B	C	D	E	F	G	H	I	J	K	L
2	6	5	4	3	2						
3											
4	7	8	9	10	11	12					
5											
6	18	17	16	15	14	13					
7											
8	19	20	21	22	23	24					
9											
10	30	29	28	27	26	25					
11											
12	31	32	33	34	35	36					
13											

I, Kirk Breitels, in a field survey on March 10, 1995, do hereby certify that under requirements of P.A. 74, Michigan P.A. of 1970, the corner points mentioned in lines 1 and 2 above were in conformance with regulations and rules therefore as required in the current manual of survey instructions of the United States Department of the Interior, Bureau of Land Management or by a decree of a Court of Law and/or that the corner points mentioned in lines 3, 4 and 5 above were in conformance with the rules of the Michigan Board of Professional Surveyors or by a Decree of a Court of Law; established, re-established, monumented, re-monumented, recovered, found as expressed below:

NOTE: Not more than 4 corners, all in the same town and range, may be recorded on this certificate.

A. Description of original monument and accessories and/or subsequent restoration:

- E-13 1837 GLO Brookfield Set Post
- 1951 Kent Co. Wit. Conc. Mon.
- 1984 LCRC #4077 Kolehuse Set Kent County Monument in mon. box
- 1991 LCRC #6162 Byl Kent County Monument in mon. box

The position of this corner was previously approved by the Kent County Remonumentation Peer Group, monumented by Randy J. Kolehuse on 11/16/84 and was recorded per LCRC #4077

B. Description of corner evidence found and/or method applied in restoring or reestablishing corner:
E-13 Found standard Kent Co. Mon. (Harrison) per witnesses from above LCRC as set by Randy J. Kolehuse in place of the 1" Iron he found inside a mon. box. Said Iron checks with Kent Co. Wit.

- LCRC #6162 & #4077
- Nail & KC Remon. tag E. side 16" Pine S05°E 40.96'
 - Nail & KC Remon. tag E. side P. Pole N40°W 85.85'
 - NE cor. frame house foundation S40°W 103.95'
 - C/L USGS Benchmark (leaning SE'ly) S40°E 36.71'
 - Nail & KC Remon. tag in top of MBT stump pole S30°E 35.43'
 - Kent Co. Mon. (E-1, T8N, R12W) N90°E 220.51'

The selected location is accepted by me and is generally accepted by professional surveyors as the best available evidence of the position of the original corner.

C. Description of monument for corner and accessories established to perpetuate locating the position of the corner:

- E-13 Standard Kent County Monument
- Nail & KC Remon. tag E. side 22" Pine S05°E 40.96'
 - Nail & KC Remon. tag E. side P. Pole N40°W 85.85'
 - NE cor. frame house foundation S40°W 103.95'
 - C/L USGS Benchmark (leaning SE'ly) S40°E 36.71'
 - Nail & KC Remon. tag in top of MBT stump pole S30°E 35.43'
 - Kent Co. Mon. (E-1, T8N, R12W) N90°E 220.47'

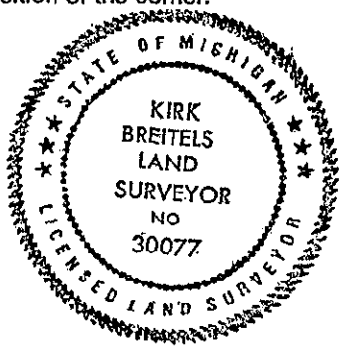

Signed by *Kirk Breitels* Date 6/22/95
 Surveyor's Michigan License No. 30077