

MAR 08 1999

KENT COUNTY REMONUMENTATION

SECTION

LAND CORNER RECORDATION CERTIFICATE  
Filing Requirement of Act 74, Mich. P.A. 1970

For corners in

KENT COUNTY  
(County)

Located In:

Corner Code #

1. Public Land Survey

T9N	R12W	F-4
T	R	
T	R	
T	R	
T	R	
S	T	R
S	T	R
S	T	R
S	T	R

2. Property Controlling in Section

3. Miscellaneous Property in Sec.

4. Lot No. \_\_\_\_\_, Recorded Plat \_\_\_\_\_  
5. Private Claims \_\_\_\_\_

STATE OF MICHIGAN  
COUNTY OF KENT  
RECEIVED FOR RECORD  
38 OCT -7 AM 10:15  
REG. OF DEEDS  
*Lucy Bond*

10713

Register of Deeds Stamp & File Number

Kirk Breitels in a field survey on July 15, 1998 do hereby state that under requirements of P.A. 74, Michigan P.A. of 1970, the corner points mentioned in lines 1 and 2 above were in conformance with regulations and rules therefore as required in the current manual of survey instructions of the United States Department of the Interior, Bureau of Land Management or by a decree of a Court of Law and/or that the corner points mentioned in lines 3, 4 and 5 above were in conformance with the rules of the Michigan Board of Land Surveyors or by a Decree of a Court of Law; established, re-established, monumented, recovered, found as expressed below:

NOTE: Not more than 2 corners, all in the same town and range, may be recorded on this certificate.

A	B	C	D	E	F	G	H	I	J	K	L	M
1												
2	6	5	4	3	2	1						
3												
4	7	8	9	10	11	12						
5												
6	18	17	16	15	14	13						
7												
8	19	20	21	22	23	24						
9												
10	30	29	28	27	26	25						
11												
12	31	32	33	34	35	36						
13												

A. Description of original monument and accessories and/or subsequent restoration:

F-4 1837	GLO	Not Set
	Williams & Works	No information
	Kent Co. Wits	No information
1968	Consumers Power Co.	Intersection of 1/4 lines - no corner set

P.A. 345 1990 KENT COUNTY  
PEER APPROVED 7/23/98  
CHAIRMAN [Signature]

B. Description of corner evidence found and/or method applied in restoring or reestablishing corner:

F-4 Found 1" Iron Pipe.

Said Iron Pipe is 0.4' S and 0.1' W. of Intersection of 1/4 lines.

Fence and brush row to South is 7' East ±  
On fence line to West and at SE corner of woods to North & West

The 1" Iron Pipe is accepted by me and is generally accepted by professional surveyors as the best available evidence of the position of the corner.

C. Description of monument for corner and accessories established to perpetuate locating the position of the corner:

- F-4 Set Standard Kent County Monument in place of the 1" Iron Pipe.
- Bolt at S. side of SW corner of CP tower N35°E 89.23'
- Nail & KC Remon. tag NW side 4" Apple N65°E 61.58'
- Nail & KC Remon. tag NW side 6" Apple S45°W 24.83'
- Nail & KC Remon. tag N. side 12" Ash N75°W 32.12'
- Nail & KC Remon. tag E. side Tw. 16" Ash N10°W 20.16'
- On E-W fence
- Fence and brush row to South is 7' East ±
- At SE corner of wood to North and West

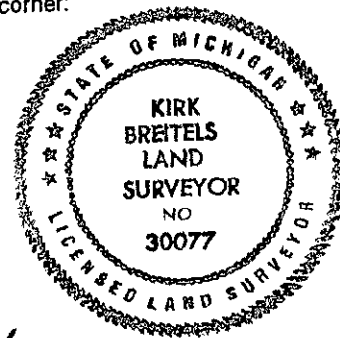

Signed by [Signature]  
30077  
Surveyor's Michigan License No. \_\_\_\_\_

Date 9/25/98