

MAR 08 1999

\$7.00
\$2.00

SECTION

KENT COUNTY REMONUMENTATION

LAND CORNER RECORDATION CERTIFICATE
Filing Requirement of Act 74, Mich. P.A. 1970

For corners in

KENT COUNTY
(County)

Located in:

Corner Code #

- 1. Public Land Survey T 2N R 12W G-7
- T _____ R _____
- T _____ R _____
- T _____ R _____
- 2. Property Controlling S _____ T _____ R _____
- in Section S _____ T _____ R _____
- 3. Miscellaneous S _____ T _____ R _____
- Property in Sec. S _____ T _____ R _____

- 4. Lot No. _____, Recorded Plat _____
- 5. Private Claims _____

I, Kirk Breitels, in a field survey on Jan. 13, 19 98 do hereby state that under requirements of P.A. 74, Michigan P.A. of 1970, the corner points mentioned in lines 1 and 2 above were in conformance with regulations and rules therefore as required in the current manual of survey instructions of the United States Department of the Interior, Bureau of Land Management or by a decree of a Court of Law and /or that the corner points mentioned in lines 3, 4 and 5 above were in conformance with the rules of the Michigan Board of Land Surveyors or by a Decree of a Court of Law; established, re-established, monumented, recovered, found as expressed below:

NOTE: Not more than 2 corners, all in the same town and range, may be recorded on this certificate.

A. Description of original monument and accessories and/or subsequent restoration:

- G-7 1837 GLO Whitcomb Set Post
- 1958 Kent Co. Wits 1" Iron
- 1981 LCRC #3200 Nederveld 1" Round Iron in Mon. Box
- 1983 LCRC #3376 Stadt Set Kent County Monument in Mon. Box
- 1991 LCRC #6174 Byl Kent County Monument in Mon. Box

The position of this corner was previously approved by the Kent County Remonumentation Peer Group, monumented by Russell E. Stadt on 5-5-83 and was recorded per LCRC #3376.

B. Description of corner evidence found and/or method applied in restoring or reestablishing corner:

G-7 Found Kent County Monument (Harrison) per witnesses from above LCRC as set by Russell E. Stadt in place of the Iron he found inside a Mon. Box. Said Iron checks with Kent Co. Wits. and LCRC #3200.

LCRC #3376		LCRC #6174	
Nail & Remon. tag P. Pole	S30°W 55.46'	Nail & Remon. tag P. Pole	S30°W 55.40'
Punch Hole E. end C.M. Pipe	N40°E 36.60'	Punch Hole E. end C.M. culvert	N40°E 36.64'
Punch Hole W. end C.M. Pipe	N45°W 37.20'	Punch Hole W. end C.M. culvert	N45°W 37.23'
Nail & Remon. tag 6" Ash	S85°E 27.73'	Nail & Remon. tag 6" Ash	S85°E 27.67'
C/L E-W road is 170' South ±			
On C/L N-S road			

The selected location is accepted by me and is generally accepted by professional surveyors as the best available evidence of the position of the original corner.

C. Description of monument for corner and accessories established to perpetuate locating the position of the corner:

- G-7 Standard Kent County Monument in Mon. Box
- Nail & KC Remon. tag E. side P. Pole S30°W 55.31'
- Small Punch Hole in E. end C.M. culvert N40°E 36.64'
- Small Punch Hole in W. end C.M. culvert N45°W 37.23'
- Nail & KC Remon. tag S. side 10" Ash S85°E 27.67'
- C/L E-W road is 170' South ± & on C/L N-S road.

STATE OF MICHIGAN
 COUNTY OF KENT
 RECEIVED FOR RECORD
 98 MAR -5 AM 8:29
 REG. OF DEEDS
David J. Bond

10461

Register of Deeds Stamp & File Number

A	B	C	D	E	F	G	H	I	J	K	L	M
1												
2	6	5	4	3	2	1						
3												
4	7	8	9	10	11	12						
5												
6	18	17	16	15	14	13						
7												
8	19	20	21	22	23	24						
9												
10	30	29	28	27	26	25						
11												
12	31	32	33	34	35	36						
13												

P.A. 345 1990 KENT COUNTY
 PEER APPROVED 2/19/98
 CHAIRMAN *Harry Fabere*

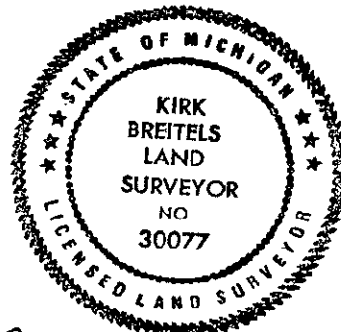

Signed by *Kirk Breitels*
 Surveyor's Michigan License No. 30077

Date 2/19/98