

SURVEY & REMONUMENTATION

\$7.00
\$2.00

MAR 08 1999

KENT COUNTY REMONUMENTATION

SECTION _____

LAND CORNER RECORDATION CERTIFICATE
Filing Requirement of Act 74, Mich. P.A. 1970

REG. OF DEEDS

Luigi Standa

98 MAR -5 AM 8:29

STATE OF MICHIGAN
COUNTY OF KENT
RECEIVED FOR RECORD

For corners in

KENT COUNTY

(County)

Located In:

Corner Code #

1. Public Land Survey

T 9N R 12W

G-10

T _____ R _____

T _____ R _____

T _____ R _____

2. Property Controlling in Section

S _____

T _____ R _____

S _____

T _____ R _____

3. Miscellaneous Property in Sec.

S _____

T _____ R _____

S _____

T _____ R _____

10463

Register of Deeds Stamp & File Number

4. Lot No. _____, Recorded Plat _____

5. Private Claims _____

I, Kirk Breitels, in a field survey on Jan. 12, 1998 do hereby state that under requirements of P.A. 74, Michigan P.A. of 1970, the corner points mentioned in lines 1 and 2 above were in conformance with regulations and rules therefore as required in the current manual of survey instructions of the United States Department of the Interior, Bureau of Land Management or by a decree of a Court of Law and /or that the corner points mentioned in lines 3, 4 and 5 above were in conformance with the rules of the Michigan Board of Land Surveyors or by a Decree of a Court of Law; established, re-established, monumented, recovered, found as expressed below:

NOTE: Not more than 2 corners, all in the same town and range, may be recorded on this certificate.

	A	B	C	D	E	F	G	H	I	J	K	L	M
1													
2	6		5		4		3		2		1		
3													
4	7		8		9		10		11		12		
5													
6	18		17		16		15		14		13		
7													
8	19		20		21		22		23		24		
9													
10	30		29		28		27		26		25		
11													
12	31		32		33		34		35		36		
13													

A. Description of original monument and accessories and/or subsequent restoration:

- G-10 1837 GLO Whitcomb Set Post
- 1956 Kent Co. Wits Iron & Stone
- 1980 LCRC #1369 Stadt "T" Iron
- 1980 LCRC #1751 Merdzinski Set Kent County Monument
- 1991 LCRC #6176 Byl Kent County Monument

P.A. 345 1990 KENT COUNTY

PEER APPROVED 2/19/98
CHAIRMAN Harry Fisher

The position of this corner was previously approved by the Kent County Remonumentation Peer Group, monumented by John A. Merdzinski on 12-17-80 and was recorded per LCRC #1751.

B. Description of corner evidence found and/or method applied in restoring or reestablishing corner:

G-10 Found Kent County Monument (Harrison) per witnesses from above LCRC as set by John A. Merdzinski in place of the "T" Iron over another Iron in Stones he found. All check with Kent Co. Wits. and LCRC #1369.

- LCRC #1751
- Nail & Remon. tag 38" Maple N90°E 30.15'
- Nail & Remon. tag 8" Tw. B. Elder N65°W 22.05'
- Nail & Remon. tag 8" Tw. Cherry N90°W 22.96'
- Nail & Remon. tag 4" Maple S35°W 51.33'
- Spike in 8" Apple S45°E 61.95'
- C/L bit. rd. is East 2.5', on fence line West
- LCRC #6176
- Nail & Remon. tag 48" Maple N90°E 30.11'
- Nail & Remon. tag 16" B. Elder N65°W 21.93'
- Nail & Remon. tag 16" Cherry N90°W 23.44'
- Nail & Remon. tag 8" Maple S35°W 51.36'
- Nail & Remon. tag 10" Apple S45°E 62.01'

The selected location is accepted by me and is generally accepted by professional surveyors as the best available evidence of the position of the original corner.

C. Description of monument for corner and accessories established to perpetuate locating the position of the corner:

- G-10 Standard Kent County Monument
- Nail & KC Remon. tag S. side 48" Maple N90°E 30.11'
- Nail & KC Remon. tag NE side 20" Box Elder N65°W 21.96'
- Nail & KC Remon. tag N. side 20" Cherry N90°W 23.44'
- Nail & KC Remon. tag E. side 12" Maple S35°W 51.32'
- Nail & KC Remon. tag W. side 12" Apple S45°E 62.01'

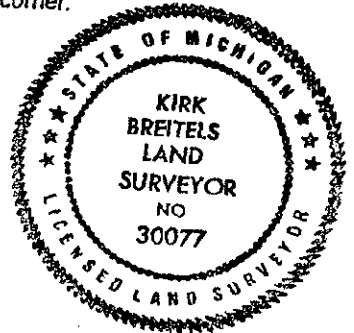

Signed by Kate Powell
Surveyor's Michigan License No. 30077

Date 2/19/98