

MAR 08 1999

SECTION

KENT COUNTY REMONUMENTATION

LAND CORNER RECORDATION CERTIFICATE
Filing Requirement of Act 74, Mich. P.A. 1970

For corners in
KENT COUNTY
(County)

Located In:	Corner Code #
T 9N R 12W	H-8
T R	
T R	
T R	
T R	
S T R	
S T R	
S T R	
S T R	

1. Public Land Survey

2. Property Controlling in Section

3. Miscellaneous Property in Sec.

4. Lot No. _____, Recorded Plat _____
5. Private Claims _____

I, Kirk Breitels, in a field survey on July 31, 1998 do hereby state that under requirements of P.A. 74, Michigan P.A. of 1970, the corner points mentioned in lines 1 and 2 above were in conformance with regulations and rules therefore as required in the current manual of survey instructions of the United States Department of the Interior, Bureau of Land Management or by a decree of a Court of Law and /or that the corner points mentioned in lines 3, 4 and 5 above were in conformance with the rules of the Michigan Board of Land Surveyors or by a Decree of a Court of Law; established, re-established, monumented, recovered, found as expressed below:

NOTE: Not more than 2 corners, all in the same town and range, may be recorded on this certificate.

A. Description of original monument and accessories and/or subsequent restoration:

- H-8 1837 GLO Not Set
1929-54 Williams & Works Set/Used Iron set at Intersection of 1/4 lines.
Kent Co. Wits Iron
Fence South - 15' East 28" Beech SW 114.1' 12" Maple E 37.4'
- 1964 "NELSON SAUR ADDITION" Concrete Monument at Center Post of Sec. 22, T9N, R12W
- 1986 "APPLETREE INDUSTRIAL PARK PLAT" Shows SE corner of NW 1/4 Sec. 22, T9N, R12W

B. Description of corner evidence found and/or method applied in restoring or reestablishing corner:

H-8 Found Concrete Monument - no Kent Co. Wit. remain
Concrete Monument is 0.2' S. & 0.2' E. of intersection of 1/4 lines.

Concrete Monument fits measurements and Irons found in "NELSON SAUR ADDITION" & "APPLETREE INDUSTRIAL PARK PLAT"

The Concrete Monument is accepted by me and is generally accepted by professional surveyors as the best available evidence of the position of the corner.

C. Description of monument for corner and accessories established to perpetuate locating the position of the corner:

- H-8 Set Standard Kent County Monument in place of the Concrete Monument
- C/L chain link fence post (West of 2) East 72.76'
- Nail & KC Remon. tag W. side 16" Cherry N30°E 10.37'
- Nail & KC Remon. tag SW side 6" Maple N45°W 19.74'
- C/L chain link fence post - corner post West 14.95'
- E-W chain link fence is South 0.2'

STATE OF MICHIGAN
COUNTY OF KENT
RECEIVED FOR RECORD
98 OCT -7 AM 10:15
REG. OF DEEDS
Lucy Bond

10720

Register of Deeds Stamp & File Number

	A	B	C	D	E	F	G	H	I	J	K	L	M
1													
2	6		5		4		3		2		1		
3													
4	7		8		9		10		11		12		
5													
6	18		17		16		15		14		13		
7													
8	19		20		21		22		23		24		
9													
10	30		29		28		27		26		25		
11													
12	31		32		33		34		35		36		
13	*												

P.A. 345 1990 KENT COUNTY

PEER APPROVED 9/20/98
CHAIRMAN Tommy Kubers

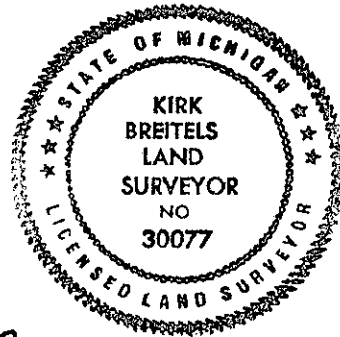

Signed by *Kirk Breitels*
Surveyor's Michigan License No. 30077

Date 9/25/98