

MAR 08 1999

KENT COUNTY REMONUMENTATION

\$7.00  
\$2.00

SECTION

LAND CORNER RECORDATION CERTIFICATE  
Filing Requirement of Act 74, Mich. P.A. 1970

STATE OF MICHIGAN  
COUNTY OF KENT  
RECEIVED FOR RECORD  
98 MAR -5 AM 8:29  
REG. OF DEEDS  
*Lucy Bond*

For corners in

KENT COUNTY  
(County)

Located In:

Corner Code #

- |                                    |                            |       |
|------------------------------------|----------------------------|-------|
| 1. Public Land Survey              | T <u>9</u> N R <u>12</u> W | I-2   |
|                                    | T ___ R ___                | _____ |
|                                    | T ___ R ___                | _____ |
|                                    | T ___ R ___                | _____ |
| 2. Property Controlling in Section | S ___ T ___ R ___          | _____ |
|                                    | S ___ T ___ R ___          | _____ |
| 3. Miscellaneous Property in Sec.  | S ___ T ___ R ___          | _____ |
|                                    | S ___ T ___ R ___          | _____ |

10469

Register of Deeds Stamp & File Number

4. Lot No. \_\_\_\_\_, Recorded Plat \_\_\_\_\_  
5. Private Claims \_\_\_\_\_

I, Kirk Breitels, in a field survey on Jan. 6, 19 98 do hereby state that under requirements of P.A. 74, Michigan P.A. of 1970, the corner points mentioned in lines 1 and 2 above were in conformance with regulations and rules therefore as required in the current manual of survey instructions of the United States Department of the Interior, Bureau of Land Management or by a decree of a Court of Law and /or that the corner points mentioned in lines 3, 4 and 5 above were in conformance with the rules of the Michigan Board of Land Surveyors or by a Decree of a Court of Law; established, re-established, monumented, recovered, found as expressed below:

NOTE: Not more than 2 corners, all in the same town and range, may be recorded on this certificate.

|    |    |    |    |    |    |    |   |   |   |   |   |   |
|----|----|----|----|----|----|----|---|---|---|---|---|---|
| A  | B  | C  | D  | E  | F  | G  | H | I | J | K | L | M |
| 2  | 6  | 5  | 4  | 3  | 2  | 1  |   |   |   |   |   |   |
| 3  |    |    |    |    |    |    |   |   |   |   |   |   |
| 4  | 7  | 8  | 9  | 10 | 11 | 12 |   |   |   |   |   |   |
| 5  |    |    |    |    |    |    |   |   |   |   |   |   |
| 6  | 18 | 17 | 16 | 15 | 14 | 13 |   |   |   |   |   |   |
| 7  |    |    |    |    |    |    |   |   |   |   |   |   |
| 8  | 19 | 20 | 21 | 22 | 23 | 24 |   |   |   |   |   |   |
| 9  |    |    |    |    |    |    |   |   |   |   |   |   |
| 10 | 30 | 29 | 28 | 27 | 26 | 25 |   |   |   |   |   |   |
| 11 |    |    |    |    |    |    |   |   |   |   |   |   |
| 12 | 31 | 32 | 33 | 34 | 35 | 36 |   |   |   |   |   |   |
| 13 |    |    |    |    |    |    |   |   |   |   |   |   |

A. Description of original monument and accessories and/or subsequent restoration:

- |     |      |               |            |                                      |
|-----|------|---------------|------------|--------------------------------------|
| I-2 | 1837 | GLO           | Whitcomb   | Set Post                             |
|     | 1952 | Kent Co. Wits |            | Concrete Monument                    |
|     | 1979 | LCRC #1372    | VanKooten  | 1" Iron in Mon. Box                  |
|     | 1982 | LCRC #2952    | Merdzinski | Set Kent County Monument in Mon. Box |
|     | 1995 | LCRC #8297    | Breitels   | Kent County Monument                 |

P.A. 345 1990 KENT COUNTY  
PEER APPROVED 2/19/98  
CHAIRMAN Harry Huber

The position of this corner was previously approved by the Kent County Remonumentation Peer Group, monumented by John A. Merdzinski on 4-15-82 and was recorded per LCRC #2952.

B. Description of corner evidence found and/or method applied in restoring or reestablishing corner:

I-2 Found Kent County Mon. (Harrison) per wits. from above LCRC as set by John A. Merdzinski in place of the 1" Iron over a Concrete Mon. he found inside a Mon. Box. Iron & Conc. Mon. check with Kent Co. Wits. & LCRC #1372.  
LCRC #2952 LCRC #8297

- |                              |               |                             |               |
|------------------------------|---------------|-----------------------------|---------------|
| NE corner house              | S25°W 112.53' | NE corner of house (siding) | S25°W 112.53' |
| SW corner fnd. to house add. | N55°E 106.52' | SW corner fnd. to hse. add. | N55°E 106.52' |
| Nail & Remon. tag P. Pole    | S60°E 77.05'  | Nail & Remon. tag P. Pole   | S60°E 77.08'  |
| Nail & Remon. tag P. Pole    | S85°W 35.28'  | Nail & Remon. tag P. Pole   | S85°W 35.28'  |
| Nail & Remon. tag 30" Maple  | S50°W 44.20'  | Nail & Remon. tag 36" Maple | S50°W 44.22'  |
- On C/L Sparta Ave. and Indian Lakes Rd.

The selected location is accepted by me and is generally accepted by professional surveyors as the best available evidence of the position of the original corner.

C. Description of monument for corner and accessories established to perpetuate locating the position of the corner:

- I-2 Standard Kent County Monument
- |  |               |
|--|---------------|
| NE corner of house (wood siding)       | S25°W 112.53' |
| SW corner foundation of house addition | N55°E 106.52' |
| Nail & KC Remon. tag N. side P. Pole   | S60°E 77.08'  |
| Nail & KC Remon. tag S. side P. Pole   | S85°W 35.28'  |
| Nail & KC Remon. tag N. side 36" Maple | S50°W 44.22'  |
- On C/L of Sparta Ave. N-S and Indian Lakes Rd. East

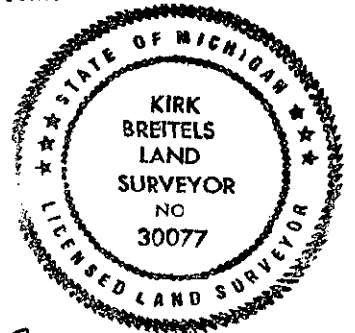

Signed by *Kirk Breitels*  
Surveyor's Michigan License No. 30077

Date 2/19/98