

SURVEY & REMONUMENTATION

MAR 08 1999

\$7.00  
\$2.00

SECTION

KENT COUNTY REMONUMENTATION

LAND CORNER RECORDATION CERTIFICATE  
Filing Requirement of Act 74, Mich. P.A. 1970

For corners in

KENT COUNTY  
(County)

Located In:

Corner Code #

1. Public Land Survey	T <u>9</u> N R <u>12</u> W	<u>I-7</u>
	T <u>   </u> R <u>   </u>	<u>   </u>
	T <u>   </u> R <u>   </u>	<u>   </u>
	T <u>   </u> R <u>   </u>	<u>   </u>
2. Property Controlling in Section	S <u>   </u> T <u>   </u> R <u>   </u>	<u>   </u>
	S <u>   </u> T <u>   </u> R <u>   </u>	<u>   </u>
3. Miscellaneous Property in Sec.	S <u>   </u> T <u>   </u> R <u>   </u>	<u>   </u>
	S <u>   </u> T <u>   </u> R <u>   </u>	<u>   </u>

STATE OF MICHIGAN  
COUNTY OF KENT  
RECEIVED FOR RECORD  
98 MAR -5 AM 8:30  
REG. OF DEEDS  
*Lucy Standa*

10474

Register of Deeds Stamp & File Number

4. Lot No. \_\_\_\_\_, Recorded Plat \_\_\_\_\_  
5. Private Claims \_\_\_\_\_

I, Kirk Breitels, in a field survey on Jan. 22, 19 98 do hereby state that under requirements of P.A. 74, Michigan P.A. of 1970, the corner points mentioned in lines 1 and 2 above were in conformance with regulations and rules therefore as required in the current manual of survey instructions of the United States Department of the Interior, Bureau of Land Management or by a decree of a Court of Law and/or that the corner points mentioned in lines 3, 4 and 5 above were in conformance with the rules of the Michigan Board of Land Surveyors or by a Decree of a Court of Law; established, re-established, monumented, recovered, found as expressed below:

A	B	C	D	E	F	G	H	I	J	K	L	M
1												
2	6	5	4	3	2	1						
3												
4	7	8	9	10	11	12						
5												
6	18	17	16	15	14	13						
7												
8	19	20	21	22	23	24						
9												
10	30	29	28	27	26	25						
11												
12	31	32	33	34	35	36						
13												

NOTE: Not more than 2 corners, all in the same town and range, may be recorded on this certificate.

A. Description of original monument and accessories and/or subsequent restoration:

I-7	1837	GLO	Whitcomb	Set Post
		Kent Co. Wits		Stone
	1973	LCRC #493	Spicer	PK Nail
	1981	LCRC #1660	Merdzinski	Set Kent County Monument at side of manhole 0.16' South of actual corner
	1995	LCRC #8302	Breitels	Kent County Monument - should have said PK Nail

P.A. 345 1990 KENT COUNTY  
PEER APPROVED 2/19/98  
CHAIRMAN John Thibault

The position of this corner was previously approved by the Kent County Remonumentation Peer Group, monumented by John A. Merdzinski on 2-26-81 and was recorded per LCRC #1660.

B. Description of corner evidence found and/or method applied in restoring or reestablishing corner:

I-7 Found PK Nail at same location as Kent Co. Mon. (0.16' South of actual corner) per witnesses from above LCRC as set by John A. Merdzinski in place of the PK Nail he found. Said PK Nail checks with Kent Co. Wits. and LCRC #493.	LCRC #1660	LCRC #8302	
Nail & Remon. tag T.P.L. Pole	N42°E 34.66'	Nail & Remon. tag 28" Ailanthus	N65°W 101.85'
Nail & Remon. tag 16" Maple	S25°E 51.05'	SE corner building foundation	N25°W 82.80'
Nail & Remon. tag 28" Ailanthus	N65°W 101.85'	NE corner square steel sign post	S48°W 54.34'
SE corner bldg. foundation	N25°W 82.82'	C/L top fire hydrant	N65°E 61.15'
NE corner square steel sign post	S48°W 54.39'	C/L top fire hydrant	S50°E 51.18'
SE corner bldg. foundation	N55°E 105.99'	SW corner stone building	N45°E 151.68'

The selected location is accepted by me and is generally accepted by professional surveyors as the best available evidence of the position of the original corner.

C. Description of monument for corner and accessories established to perpetuate locating the position of the corner:

I-7 PK Nail - 0.16' SOUTH OF ACTUAL CORNER

Nail & KC Remon. tag SW side 28" Stump	N65°W 101.76'
SE corner building foundation	N25°W 82.80'
NE corner square steel sign post	S48°W 54.34'
C/L top of fire hydrant	N65°E 61.15'
C/L top of fire hydrant	S50°E 51.18'
SW corner stone building (at walk level)	N45°E 151.68'

At SE edge of manhole  
On C/L N-S and E-W roads.

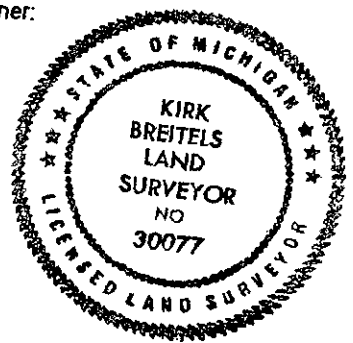

Signed by Kate Breitels  
Surveyor's Michigan License No. 30077

Date 2/19/98