

MAR 08 1999

KENT COUNTY REMONUMENTATION

\$7.00
\$2.00

SECTION

LAND CORNER RECORDATION CERTIFICATE
Filing Requirement of Act 74, Mich. P.A. 1970

For corners in

KENT COUNTY

(County)

Located In:

Corner Code #

1. Public Land Survey	T 9N R 12W	J-9
	T R	
	T R	
	T R	
	T R	
2. Property Controlling in Section	S T R	
	S T R	
3. Miscellaneous Property in Sec.	S T R	
	S T R	

STATE OF MICHIGAN
COUNTY OF KENT
RECEIVED FOR RECORD
98 MAR -5 AM 8:30
REG. OF DEEDS
Lucy Stand

10484

Register of Deeds Stamp & File Number

4. Lot No. _____, Recorded Plat _____
5. Private Claims _____

A	B	C	D	E	F	G	H	I	J	K	L	M
1												
2	6	5	4	3	2	1						
3												
4	7	8	9	10	11	12						
5												
6	18	17	16	15	14	13						
7												
8	19	20	21	22	23	24						
9												
10	30	29	28	27	26	25						
11												
12	31	32	33	34	35	36						
13												

I, Kirk Breitels, in a field survey on Jan. 6, 1998 do hereby state that under requirements of P.A. 74, Michigan P.A. of 1970, the corner points mentioned in lines 1 and 2 above were in conformance with regulations and rules therefore as required in the current manual of survey instructions of the United States Department of the Interior, Bureau of Land Management or by a decree of a Court of Law and /or that the corner points mentioned in lines 3, 4 and 5 above were in conformance with the rules of the Michigan Board of Land Surveyors or by a Decree of a Court of Law; established, re-established, monumented, recovered, found as expressed below:

NOTE: Not more than 2 corners, all in the same town and range, may be recorded on this certificate.

A. Description of original monument and accessories and/or subsequent restoration:

J-9	1837 GLO	Whitcomb	Set Post
	1935 Kent Co. Wits		Iron & Stone
	1976 LCRC #925	McCloskey	Iron
	1977 LCRC #986	Nederveld	3/4" Iron
	1982 LCRC #2891	Jonker	Set Kent County Monument
	1995 LCRC #8311	Breitels	Kent County Monument

I.P.A. 345 1990 KENT COUNTY
PEER APPROVED 2/19/98
CHAIRMAN *Harry Huber*

The position of this corner was previously approved by the Kent County Remonumentation Peer Group, monumented by Robert J. Jonker on 6-3-82 and was recorded per LCRC #2891.

B. Description of corner evidence found and/or method applied in restoring or reestablishing corner:

J-9 Found Kent County Monument (Harrison) per wits. from above LCRC as set by Robert J. Jonker in place of the 3/4" Iron he found in a ring of stones near remains of old wood stake. All check Kent Co. Wits. and LCRC's #925 & #986. LCRC #2891 LCRC #8311

Nail & Remon. tag 20" Maple	N80°E	100.86'	Nail & Remon. tag 26" Maple	N80°E	100.90'
Nail & Remon. tag T. Pole	N30°W	38.77'	Nail & Remon. tag T. Pole	N30°W	38.77'
Nail & Remon. tag G. Pole	S40°W	32.29'	Nail & Remon. tag Guy Pole	S40°W	32.29'
Nail & Remon. tag 16" Pine	S00°E	64.06'	Nail & Remon. tag 24" Pine	S00°E	63.67'
Iron	South	33.0'	On C/L E-W pavement		
1/2" Rerod	S65°W	1.25'	C/L pavement to N. is 4' East		

The selected location is accepted by me and is generally accepted by professional surveyors as the best available evidence of the position of the original corner.

C. Description of monument for corner and accessories established to perpetuate locating the position of the corner:

J-9 Standard Kent County Monument

Nail & KC Remon. tag S. side 26" Maple	N80°E	100.87'
Nail & KC Remon. tag E. side Tele. Pole	N30°W	38.77'
Nail & KC Remon. tag NW side Guy Pole	S40°W	32.29'
Nail & KC Remon. tag W. side 24" Pine	S00°E	63.67'
On C/L E-W pavement		
C/L pavement to North is 4' East		

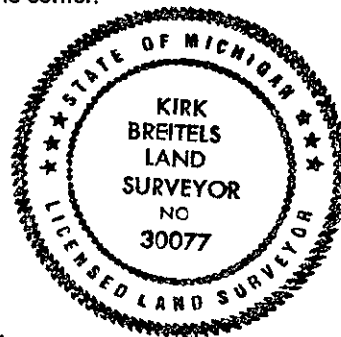

Signed by *Kirk Breitels*
Surveyor's Michigan License No. 30077

Date 2/19/98