

SURVEY & REMONUMENTATION

MAR 08 1999

KENT COUNTY REMONUMENTATION

\$7.00
\$2.00

SECTION _____

LAND CORNER RECORDATION CERTIFICATE
Filing Requirement of Act 74, Mich. P.A. 1970

STATE OF MICHIGAN
COUNTY OF KENT
RECEIVED FOR RECORD
98 MAR -5 AM 8:30
REG. OF DEEDS
Luci Standa

For corners in
KENT COUNTY
(County)

Located In:	Corner Code #
T 9N R 12W	K-11
T _____ R _____	_____
T _____ R _____	_____
T _____ R _____	_____
S _____ T _____ R _____	_____
S _____ T _____ R _____	_____
S _____ T _____ R _____	_____
S _____ T _____ R _____	_____

10491

Register of Deeds Stamp & File Number

4. Lot No. _____, Recorded Plat _____
5. Private Claims _____

I, Kirk Breitels, in a field survey on Jan. 6, 1998, do hereby state that under requirements of P.A. 74, Michigan P.A. of 1970, the corner points mentioned in lines 1 and 2 above were in conformance with regulations and rules therefore as required in the current manual of survey instructions of the United States Department of the Interior, Bureau of Land Management or by a decree of a Court of Law and/or that the corner points mentioned in lines 3, 4 and 5 above were in conformance with the rules of the Michigan Board of Land Surveyors or by a Decree of a Court of Law; established, re-established, monumented, recovered, found as expressed below:

NOTE: Not more than 2 corners, all in the same town and range, may be recorded on this certificate.

1	A	B	C	D	E	F	G	H	I	J	K	L	M
2		6		5		4		3		2		1	
3													
4		7		8		9		10		11		12	
5													
6		18		17		16		15		14		13	
7													
8		19		20		21		22		23		24	
9													
10		30		29		28		27		26		25	
11													
12		31		32		33		34		35		36	
13													

A. Description of original monument and accessories and/or subsequent restoration:

K-11 1837 GLO	Whitcomb	Set Post
1946 Kent Co. Wits.		2 1/2" Iron
1972 LCRC #124	Chambers	Iron
1972 LCRC #295	VanKooten	1/2" Iron
1982 LCRC #2895	Jonker	Set Kent County Monument
1995 LCRC #8322	Breitels	Kent County Monument

The position of this corner was previously approved by the Kent County Remonumentation Peer Group, monumented by Robert J. Jonker on 6-3-82 and was recorded per LCRC#2895.

P.A. 345 1998 KENT COUNTY
PEER APPROVED 2/19/98
CHAIRMAN Harry Huber

B. Description of corner evidence found and/or method applied in restoring or reestablishing corner:

K-11 Found Kent County Monument (Harrison) per witnesses from above LCRC as set by Robert J. Jonker in place of the 1/2" Iron he found. Said Iron checks with LCRC's #124 & #295. All Kent Co. Wits. were gone.
LCRC #2895

Nail & Remon. tag T. Pole	N90°E	51.10'	Nail & Remon. tag T. Pole	N90°E	51.10'
Nail & Remon. tag P. Pole	N90°W	83.41'	Nail & Remon. tag P. Pole	N90°W	83.41'
NE cor. hse. brick	N45°W	155.85'	NE cor. hse. brick	N45°W	155.85'
NW cor. hse. fnd.	S20°E	179.33'	NW cor. hse. fnd.	S20°E	179.33'

On C/L N-S pavement
On field line East and on brush line West
On hedge line to East and on brush line to West
The selected location is accepted by me and is generally accepted by professional surveyors as the best available evidence of the position of the original corner.

C. Description of monument for corner and accessories established to perpetuate locating the position of the corner:

K-11 Standard Kent County Monument		
Nail & KC Remon. tag N. side P. Pole	N90°E	51.14'
Nail & KC Remon. tag N. side P. Pole	N90°W	83.41'
NE corner brick house	N45°W	155.85'
NW corner house foundation	S20°E	179.33'
On C/L N-S pavement		
On hedge line to East and on brush line to West		

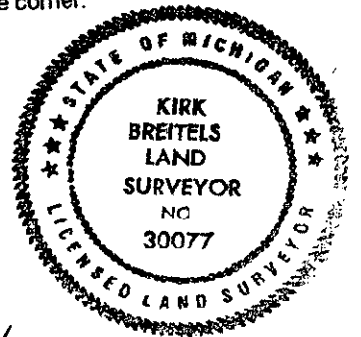

Signed by Kirk Breitels
Surveyor's Michigan License No. 30077

Date 2/19/98