

MAR 08 1999

KENT COUNTY REMONUMENTATION

\$7.00
\$2.00

SECTION

LAND CORNER RECORDATION CERTIFICATE
Filing Requirement of Act 74, Mich. P.A. 1970

STATE OF MICHIGAN
COUNTY OF KENT
RECEIVED FOR RECORD
98 MAY 21 AM 8:33
REG. OF DEEDS
Lucy Stand

For corners in

KENT COUNTY (County)	Located In:	Corner Code #
1. Public Land Survey	T 9N R 12W	L-1
	T R	
	T R	
	T R	
2. Property Controlling in Section	S T R	
	S T R	
3. Miscellaneous Property in Sec.	S T R	
	S T R	

10634
Register of Deeds Stamp & File Number

4. Lot No. _____, Recorded Plat _____
5. Private Claims _____

I, Kirk Breitels, in a field survey on April 27, 1998 do hereby state that under requirements of P.A. 74, Michigan P.A. of 1970, the corner points mentioned in lines 1 and 2 above were in conformance with regulations and rules therefore as required in the current manual of survey instructions of the United States Department of the Interior, Bureau of Land Management or by a decree of a Court of Law and /or that the corner points mentioned in lines 3, 4 and 5 above were in conformance with the rules of the Michigan Board of Land Surveyors or by a Decree of a Court of Law; established, re-established, monumented, recovered, found as expressed below:

1	A	B	C	D	E	F	G	H	I	J	K	L
2		6		5		4		3		2		1
3												
4		7		8		9		10		11		12
5												
6		18		17		16		15		14		13
7												
8		19		20		21		22		23		24
9												
10		30		29		28		27		26		25
11												
12		31		32		33		34		35		36
13												

NOTE: Not more than 2 corners, all in the same town and range, may be recorded on this certificate.

A. Description of original monument and accessories and/or subsequent restoration:

L-1	1837	GLO	Whitcomb	Not Set
		Survey	All Points	Set Spike in N. side 8" Hickory in line with fences N-S & E.
	1993	LCRC #6884	Bueche	Set Kent County Monument

The position of this corner was previously approved by the Kent County Remonumentation Peer Group, monumented by John C. Bueche on 12-22-93 and was recorded per LCRC #6884.

B. Description of corner evidence found and/or method applied in restoring or reestablishing corner:

L-1 Found Kent County Monument (Harrison) per witnesses from above LCRC as set by John C. Bueche underneath the Spike he found in the N. side of an 8" Hickory. Said Spike checks All Points witnesses.
LCRC #6884

Nail & Remon. tag 16" Tri. Maple	S40°E	60.37'
Nail & Remon. tag 8" Elm	N85°W	3.90'
Nail & Remon. tag 16" Tw. Maple	N20°W	7.00'
Nail & Remon. tag 10" Maple	N00°E	15.12'
Painted red metal fence post	S90°W	1.95'

P.A. 345 1990 KENT COUNTY
PEER APPROVED 4/30/98
CHAIRMAN *Harry Heibel*

The selected location is accepted by me and is generally accepted by professional surveyors as the best available evidence of the position of the corner.

C. Description of monument for corner and accessories established to perpetuate locating the position of the corner:

L-1 Standard Kent County Monument		
Nail & KC Remon. tag NE side Tw. 18" Maple & stump	S40°E	60.39'
Nail & KC Remon. tag N. side 8" Elm	N85°W	3.90'
Nail & KC Remon. tag E. side Tw. 18" Maple	N20°W	6.65'
Nail & KC Remon. tag E. side 10" Maple	N00°E	15.12'
Top C/L red "T" fence post	S90°W	1.97'
Mon. is leaning Southerly against 10" Hickory - in swamp		

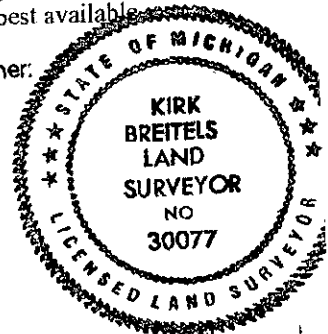

Signed by *Kirk Breitels*
Surveyor's Michigan License No. 30077

Date 4/30/98